

Reference:	NBU 317521 Walf-L423
EVC-ID	WALF_B08_L0423
Works Address:	opp. 121 St.Nicholas Court Aldriche Way, Waltham Forest, E4 9LX
Drawing No.	010 - TRO/TMO
Planned in accordance to: NSH3582 - Issue 1, NSH3132 - Issue 7, Site Visit & Drawing Guidance (18/05/2020) Partner Scoping Document - Issue 1.1, SoW for EVC Delivery v0.4, Statement of Requirements v0.7	

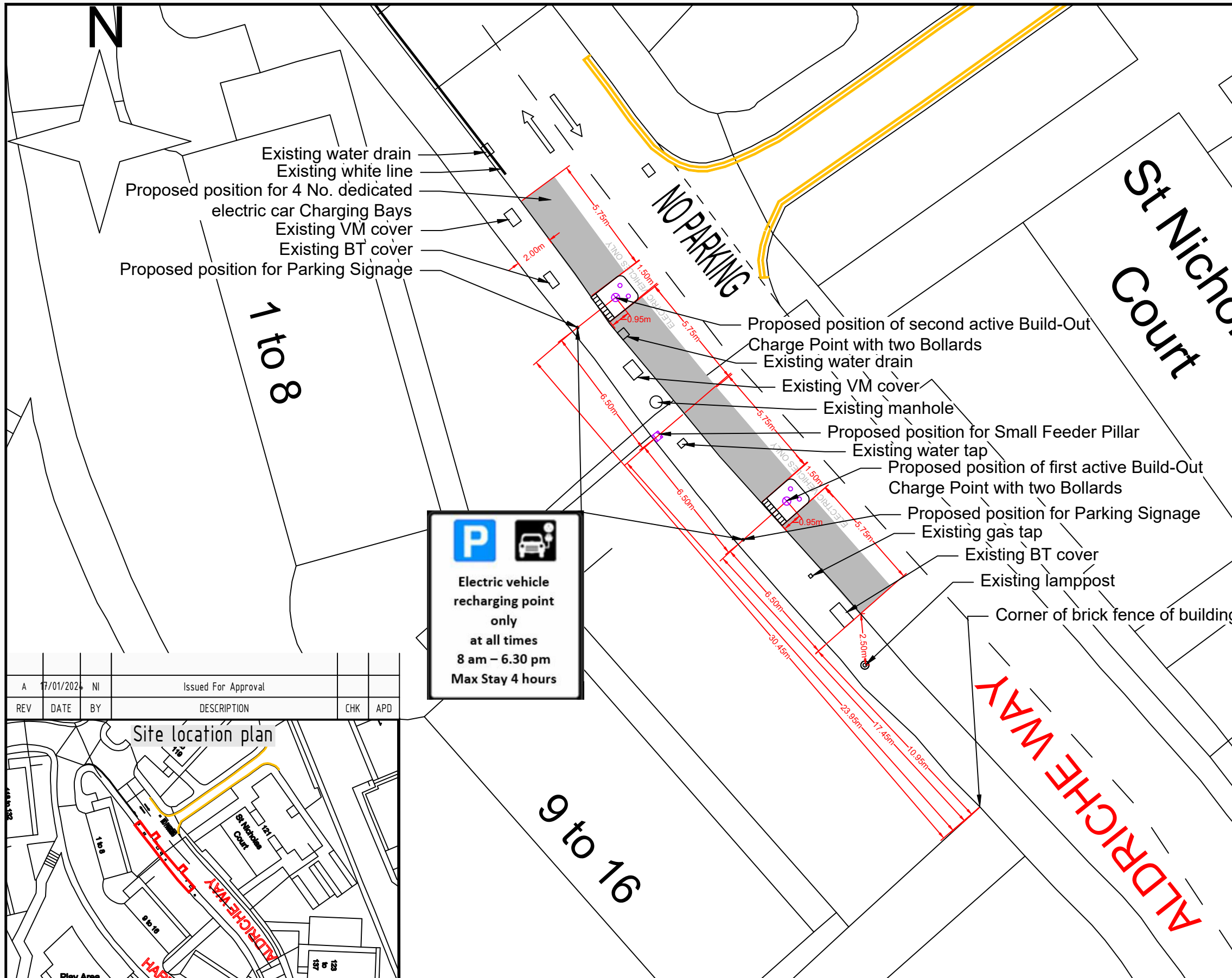

A	7/01/2024	NI	Issued For Approval		
REV	DATE	BY	DESCRIPTION	CHK	APD

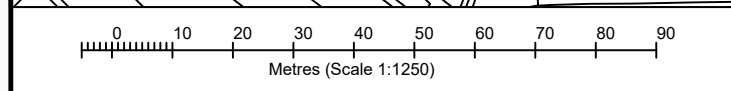
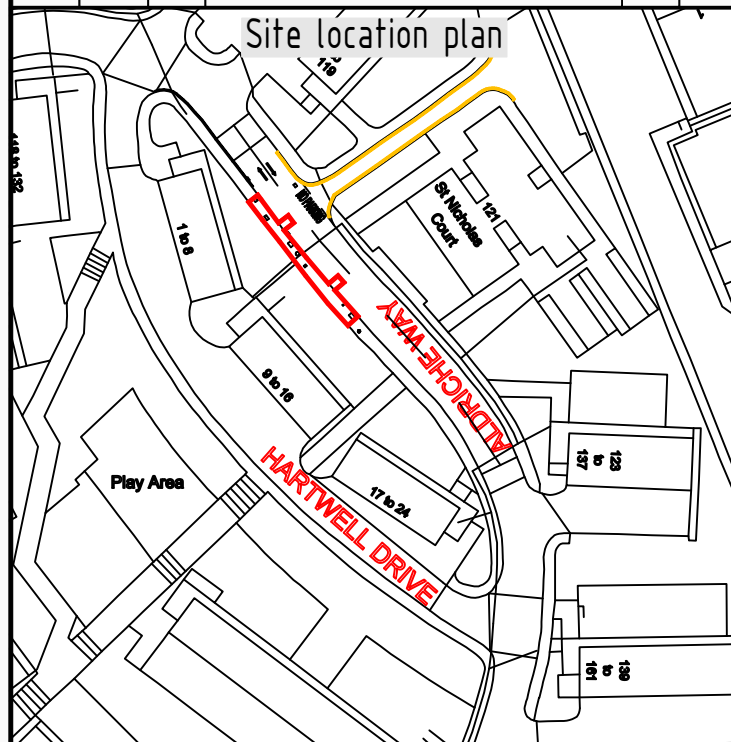

Any modifications to the drawing or use of alternative items to those specified must be agreed with Virgin Media's local planning department

Reproduction from the Ordnance Survey map by Virgin Media with permission of Ordnance Survey on behalf of the Controller of Her Majesty's Stationary Office © Crown Copyright Virgin Media (100019209)

**Legend:**

- RG6 / RG11 Cable
- EVC Duct
- EV infrastructure boundary
- EVC Parking Bay
- EVC Charge Point
- EVC Feeder Pillar
- Bollard placement
- Build out Island with protection
- Bench
- Barrier
- Existing Drain / Chamber
- Bollard / Sign
- Bin
- Hedge
- Tree & Bush
- Lamp post

Drawing Scale is 1:200 when plotted at A3

Originator:	Arkadiusz Panas
Company Name:	Quasar
Issue Date / No.:	17/01/2024 / 1
Office:	Sheffield
Line Manager:	Tomasz Polanowicz
Scale:	1:200

Internal Use Only

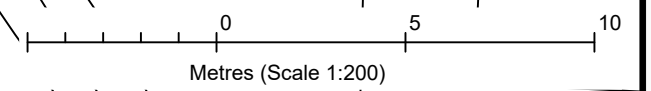

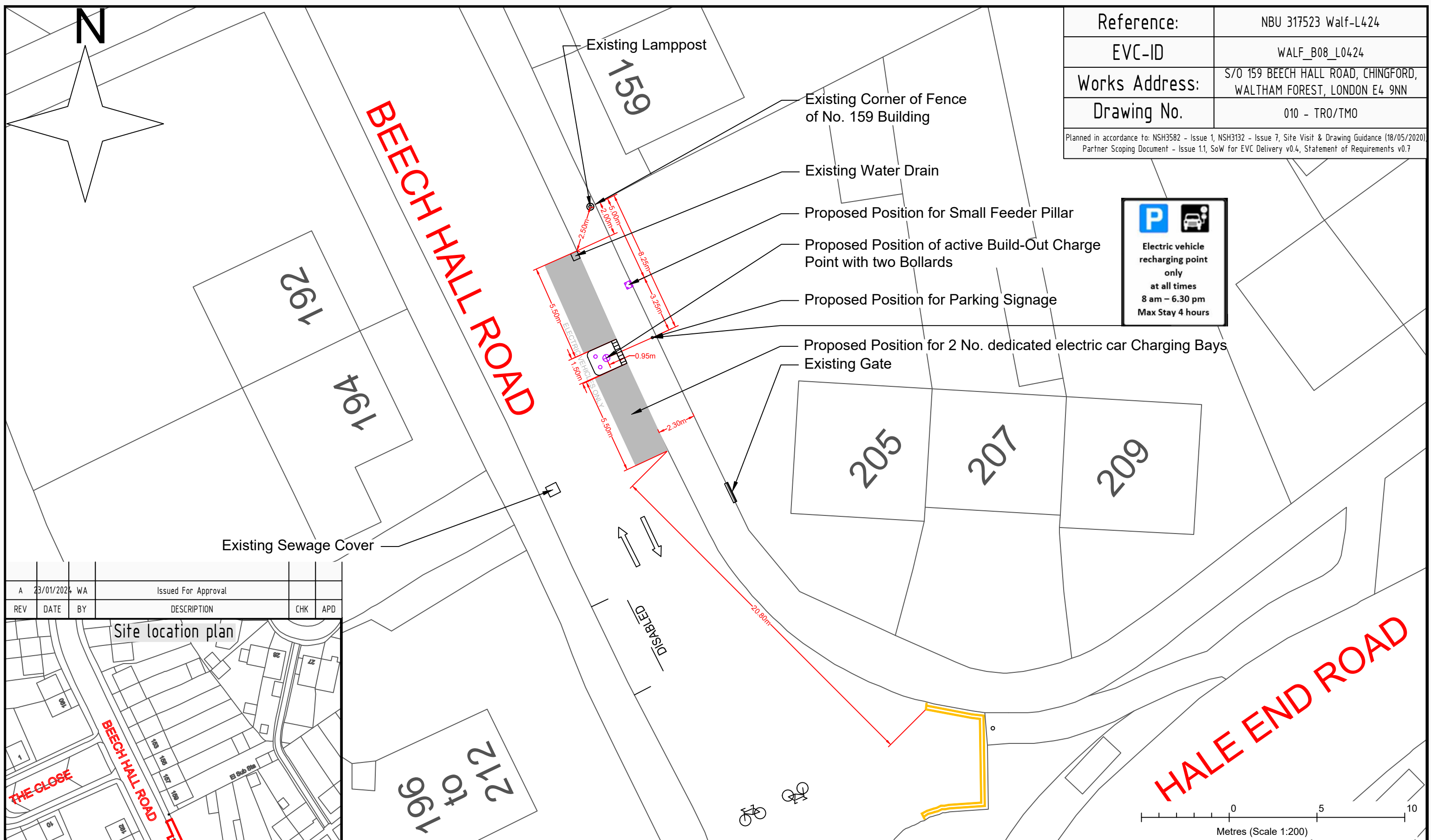

Reference:	NBU 317523 Walf-L424
EVC-ID	WALF_B08_L0424
Works Address:	S/O 159 BEECH HALL ROAD, CHINGFORD, WALTHAM FOREST, LONDON E4 9NN
Drawing No.	010 - TRO/TMO
Planned in accordance to: NSH3582 - Issue 1, NSH3132 - Issue 7, Site Visit & Drawing Guidance (18/05/2020) Partner Scoping Document - Issue 1.1, SoW for EVC Delivery v0.4, Statement of Requirements v0.7	



A	23/01/2024	WA	Issued For Approval		
REV	DATE	BY	DESCRIPTION	CHK	APD

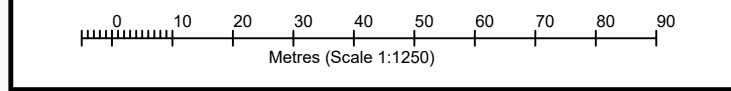
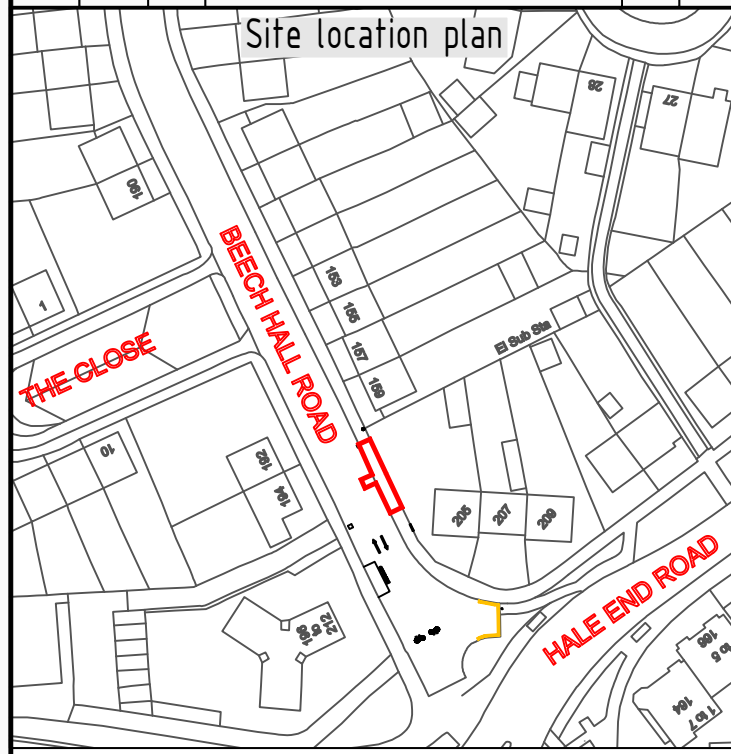

Any modifications to the drawing or use of alternative items to those specified must be agreed with Virgin Media's local planning department

Reproduction from the Ordnance Survey map by Virgin Media with permission of Ordnance Survey on behalf of the Controller of Her Majesty's Stationary Office © Crown Copyright Virgin Media (100019209)

**Legend:**

- RG6 / RG11 Cable
- EVC Duct
- EV infrastructure boundary
- EVC Parking Bay
- EVC Charge Point
- EVC Feeder Pillar
- Bollard placement
- Build out Island with protection
- Bench
- Barrier
- Existing Drain / Chamber
- Bollard / Sign
- Bin
- Hedge
- Tree & Bush
- Lamp post

**ELECTRIC VEHICLES ONLY**

Drawing Scale is 1:200 when plotted at A3

Originator:	Arkadiusz Panas
Company Name:	Quasar
Issue Date / No.:	23/01/2024 1
Office:	Sheffield
Line Manager:	Tomasz Polanowicz
Scale:	1:200

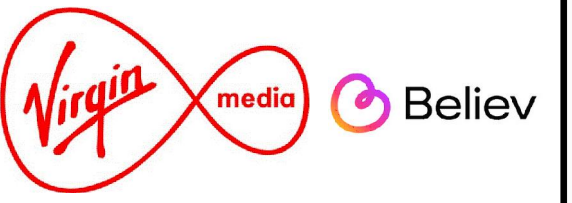

Internal Use Only

Reference:	NBU 314043 Walf-L357
EVC-ID	WALF_B08_L0357
Works Address:	s/o 22 Elm Grove, Mill House, Waltham Forest, IG8 0UW
Drawing No.	010 - TR0/TMO
Planned in accordance to: NSH3582 - Issue 1, NSH3132 - Issue 7, Site Visit & Drawing Guidance (18/05/2020) Partner Scoping Document - Issue 1.1, SoW for EVC Delivery v0.4, Statement of Requirements v0.7	

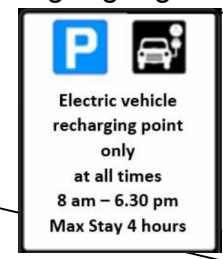
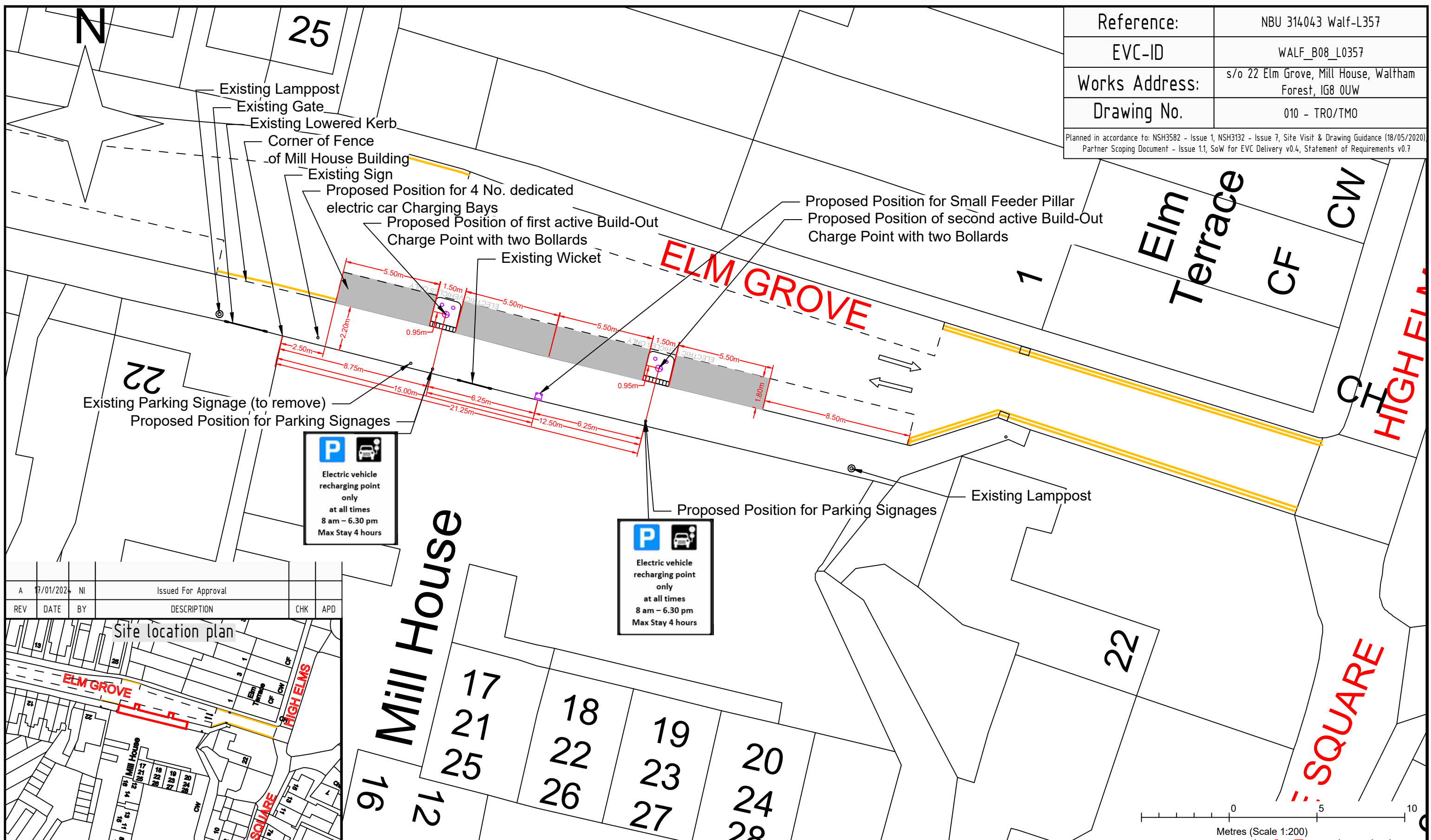

A	7/01/2024	NI	Issued For Approval		
REV	DATE	BY	DESCRIPTION	CHK	APD

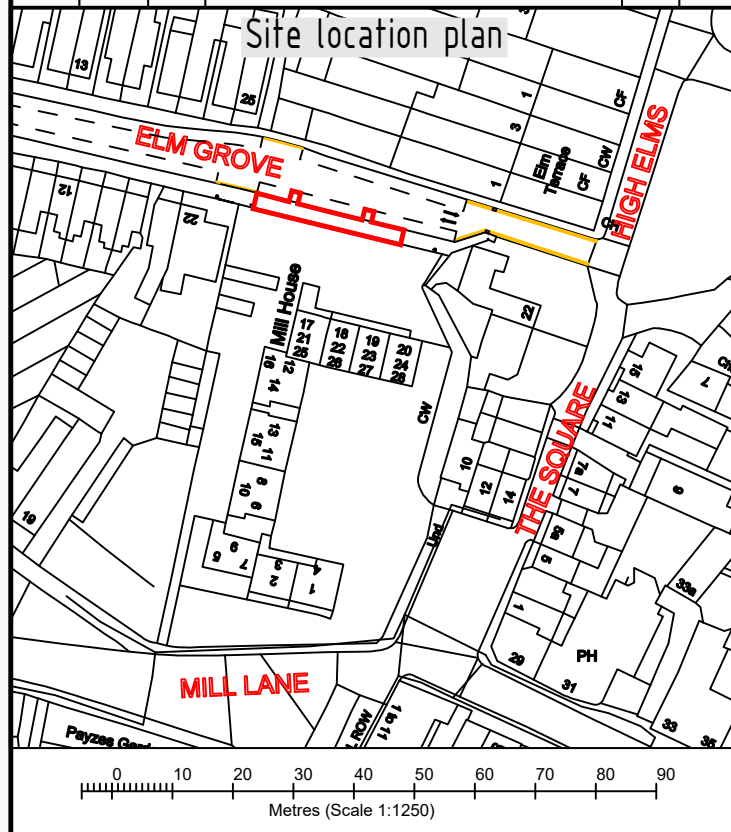

Any modifications to the drawing or use of alternative items to those specified must be agreed with Virgin Media's local planning department

Reproduction from the Ordnance Survey map by Virgin Media with permission of Ordnance Survey on behalf of the Controller of Her Majesty's Stationary Office © Crown Copyright Virgin Media (100019209)

**Legend:**

- RG6 / RG11 Cable
- EVC Duct
- EV infrastructure boundary
- EVC Parking Bay
- ELECTRIC VEHICLES ONLY
- EVC Charge Point
- EVC Feeder Pillar
- Bollard placement
- Build out Island with protection
- Bench
- Barrier
- Existing Drain / Chamber
- Bollard / Sign
- Bin
- Hedge
- Tree & Bush
- Lamp post

Drawing Scale is 1:200 when plotted at A3

Originator:	Arkadiusz Panas
Company Name:	Quasar
Issue Date / No.:	17/01/2024 1
Office:	Sheffield
Line Manager:	Tomasz Polanowicz
Scale:	1:200

Internal Use Only

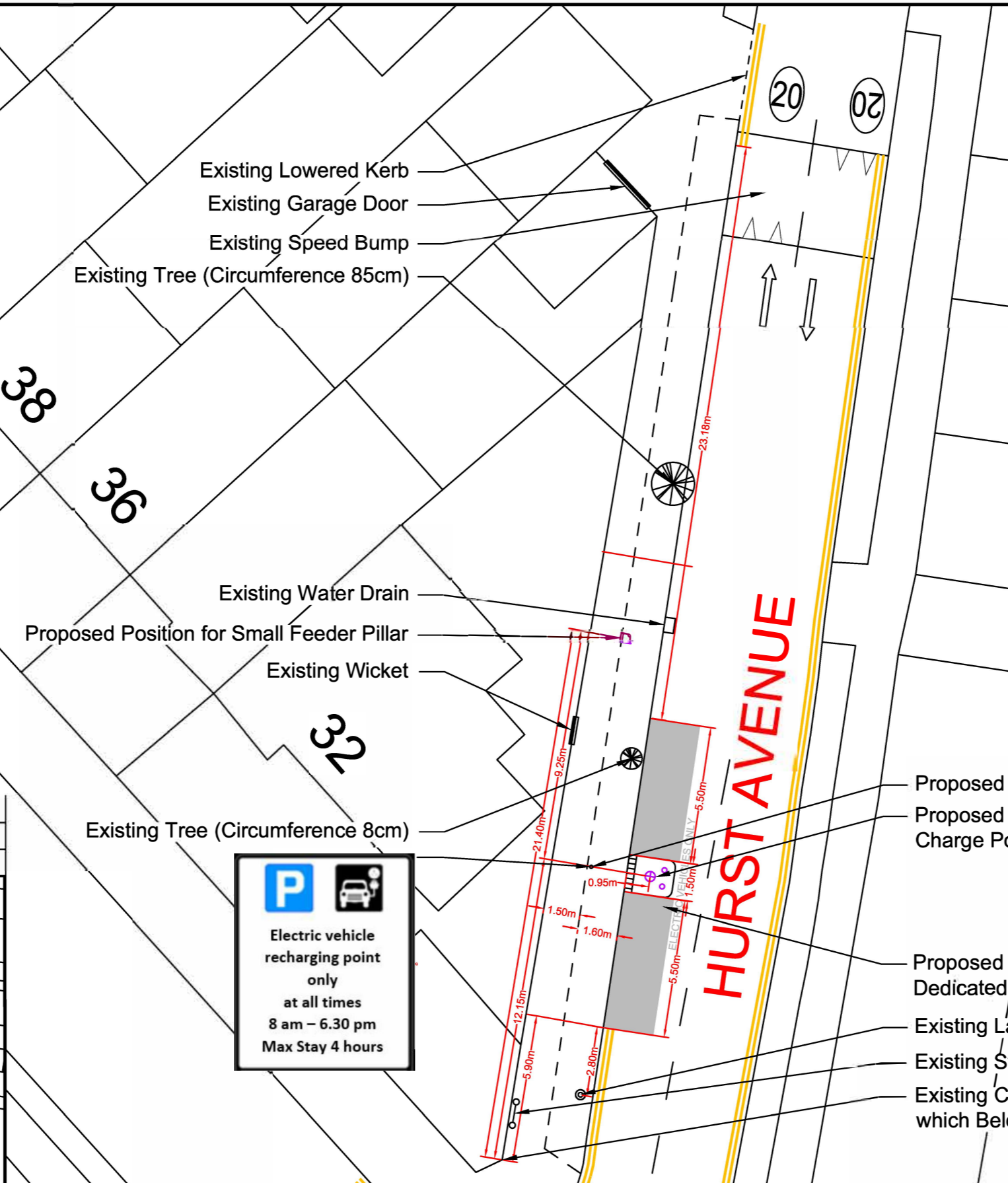
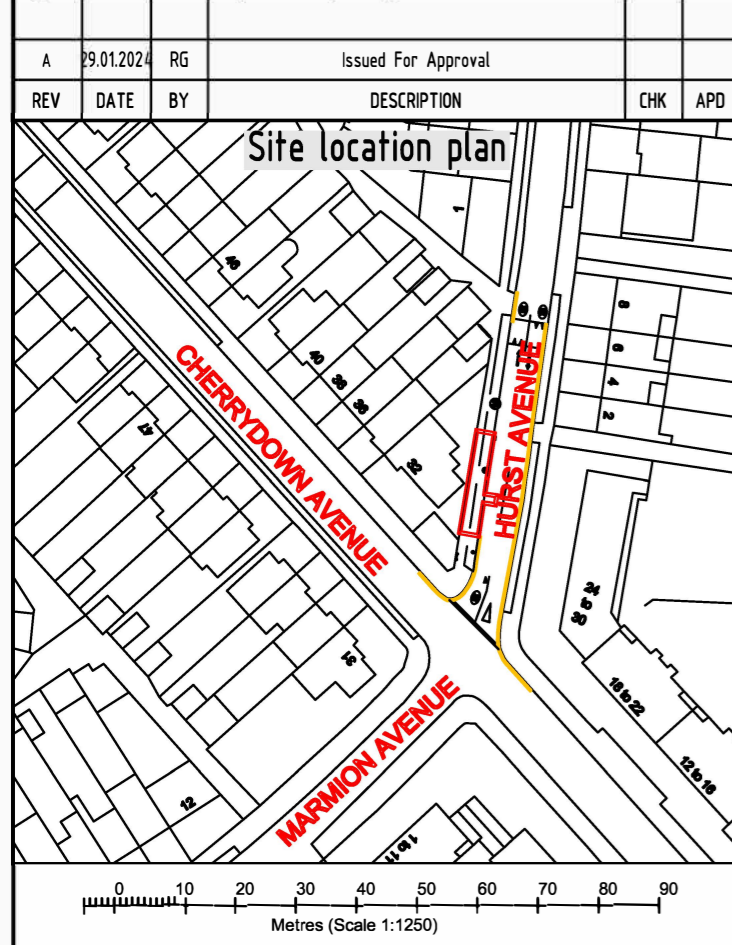
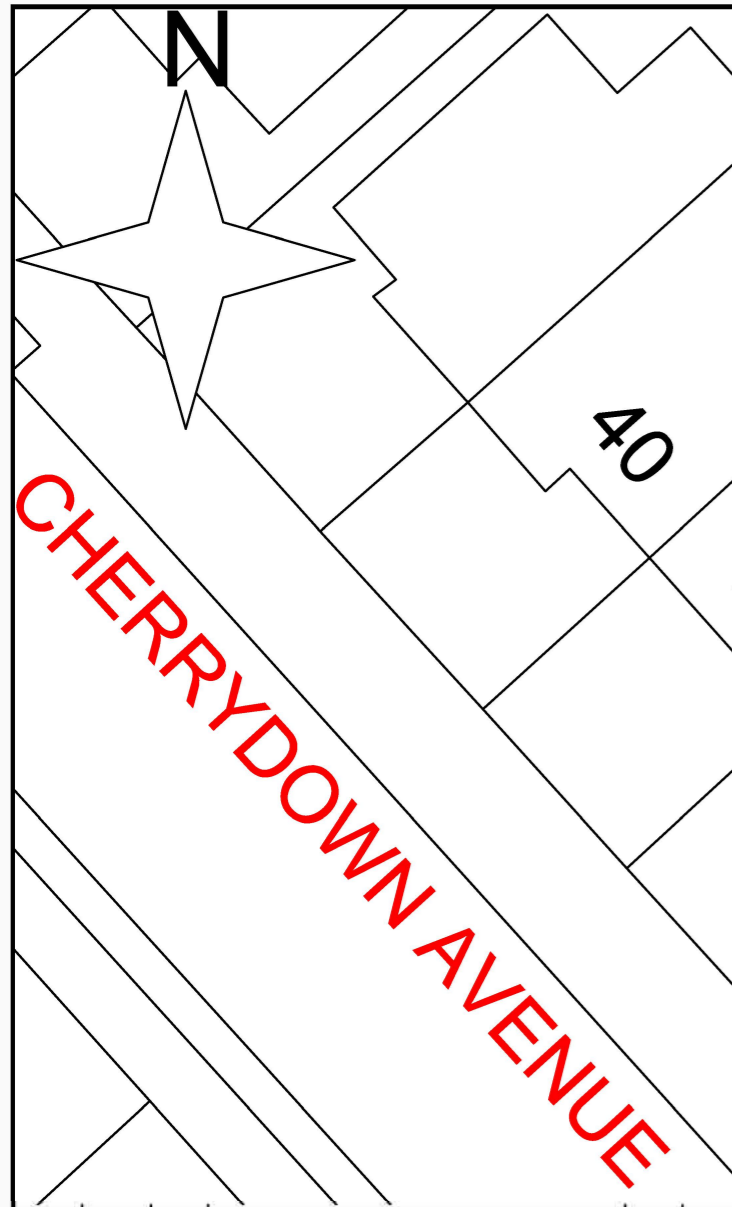

Reference:	NBU 314-068 Walf-L379
EVC-ID	WALF_B08_L0379 Hurst Avenue, s/n 32 Cherrydown
Works Address:	Avenue, Chingford, WF, E4 8DU
Drawing No.	010 - TRO/TMO
Planned in accordance to: NSH3582 - Issue 1, NSH3132 - Issue 7, Site Visit & Drawing Guidance (18/05/2020) Partner Scoping Document - Issue 1.1, SoW for EVC Delivery v0.4, Statement of Requirements v0.7	

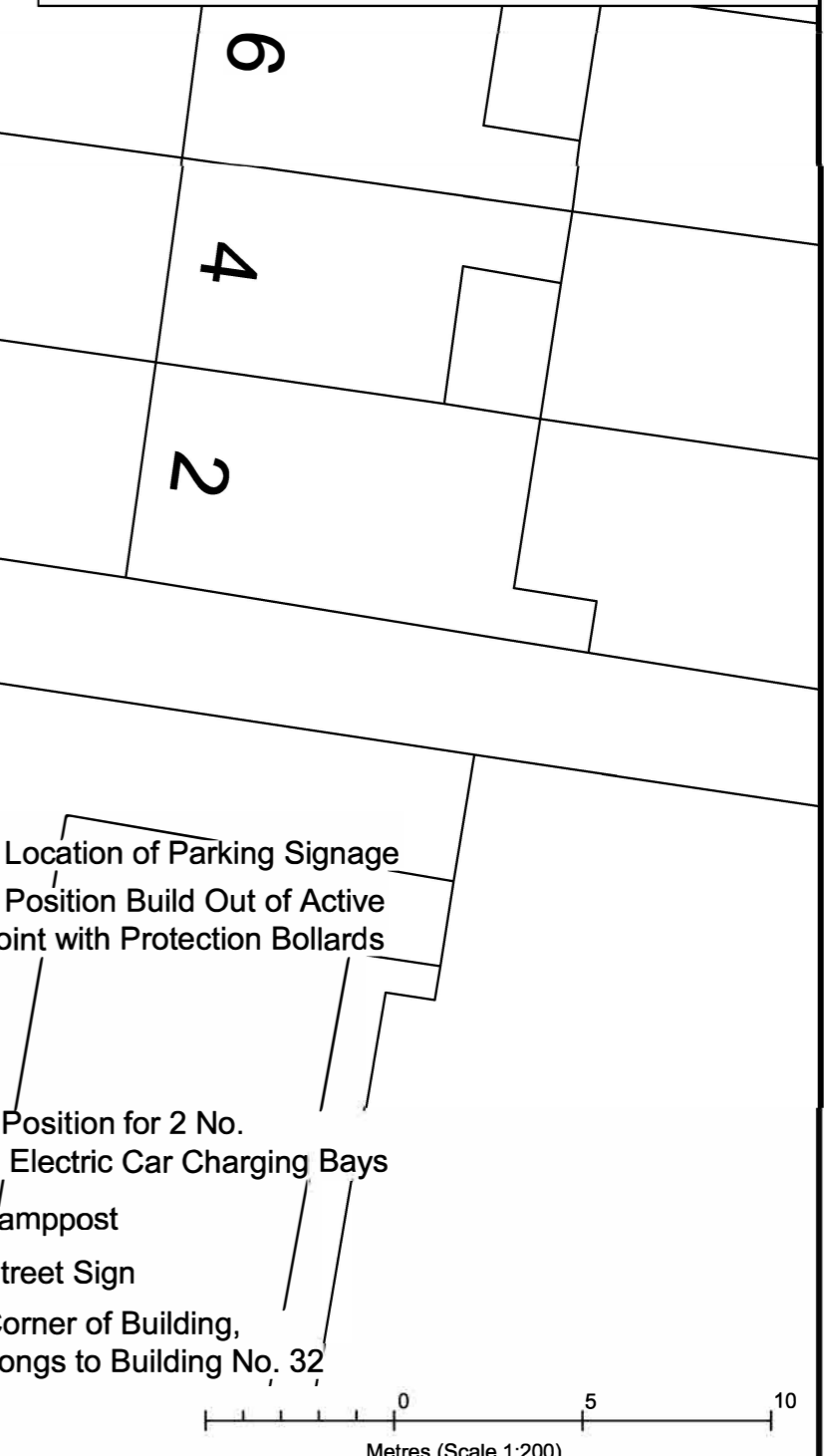

Any modifications to the drawing or use of alternative items to those specified must be agreed with Virgin Media's local planning department

Reproduction from the Ordnance Survey map by Virgin Media with permission of Ordnance Survey on behalf of the Controller of Her Majesty's Stationary Office © Crown Copyright Virgin Media (100019209)

Legend:	
	RG6 / RG11 Cable
	EVC Duct
	EV infrastructure boundary
	EVC Parking Bay
	EVC Charge Point
	EVC Feeder Pillar
	Bollard placement
	Build out island with protection
	Bench
	Barrier
	Existing Drain / Chamber
	Bollard / Sign
	Bin
	Hedge
	Tree & Bush
	Lamp post

Drawing Scale is 1:200 when plotted at A3

Originator:	Arkadiusz Panas
Company Name:	Quasar
Issue Date / No.:	29/01/2024   1
Office:	Sheffield
Line Manager:	Tomasz Polanowicz
Scale:	1:200

Internal Use Only

Reference:	NBU 287523 Walf-L398
EVC-ID	WALF_B08_L0398
Works Address:	VICTORIA ROAD, S/O 45 DOUGLAS ROAD, CHINGFORD, WF, LONDON E4 6BZ
Drawing No.	010 - TRO/TMO
Planned in accordance to: NSH3582 - Issue 1, NSH3132 - Issue 7, Site Visit & Drawing Guidance (18/05/2020) Partner Scoping Document - Issue 1.1, SoW for EVC Delivery v0.4, Statement of Requirements v0.7	

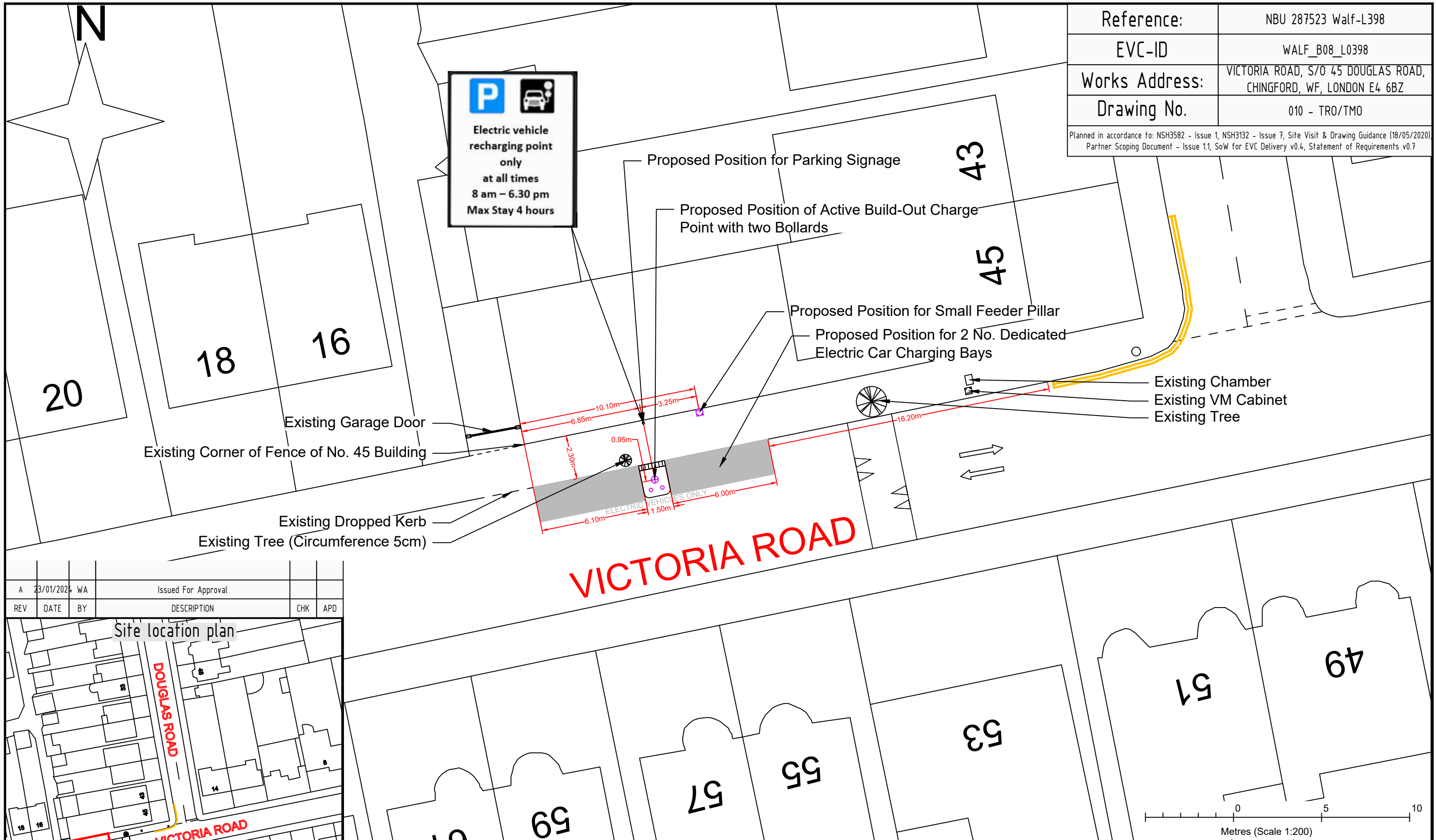

A	23/01/2024	WA	Issued For Approval		
REV	DATE	BY	DESCRIPTION	CHK	APD

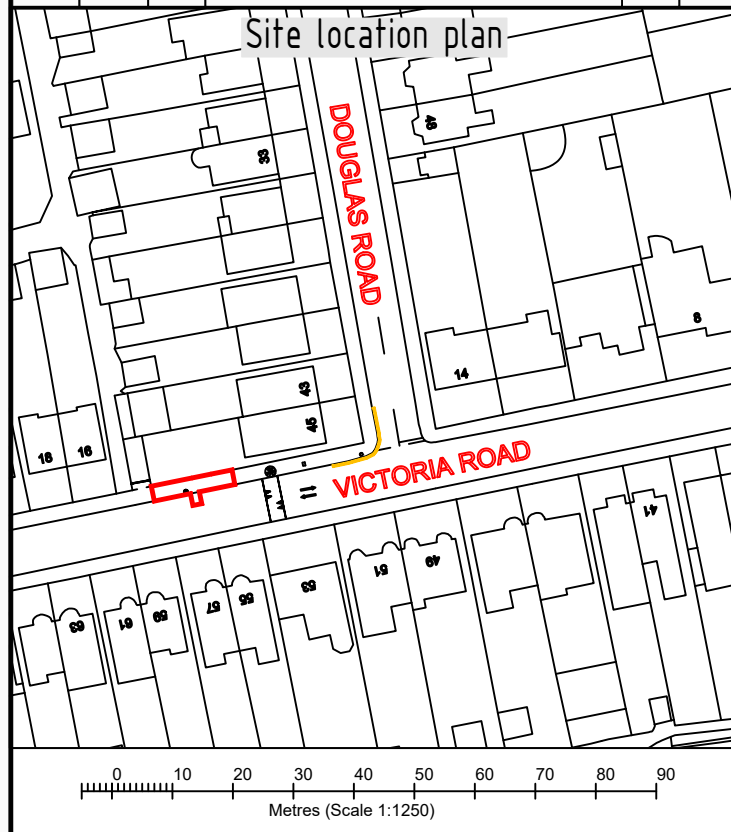

Any modifications to the drawing or use of alternative items to those specified must be agreed with Virgin Media's local planning department

Reproduction from the Ordnance Survey map by Virgin Media with permission of Ordnance Survey on behalf of the Controller of Her Majesty's Stationary Office © Crown Copyright Virgin Media (100019209)

**Legend:**

- RG6 / RG11 Cable
- EVC Duct
- EV infrastructure boundary
- EVC Parking Bay
- EVC Charge Point
- EVC Feeder Pillar
- Bollard placement
- Build out Island with protection
- Bench
- Barrier
- Existing Drain / Chamber
- Bollard / Sign
- Bin
- Hedge
- Tree & Bush
- Lamp post

**Drawing Scale is 1:200 when plotted at A3**

Originator:	Arkadiusz Panas
Company Name:	Quasar
Issue Date / No.:	23/01/2024 1
Office:	Sheffield
Line Manager:	Tomasz Polanowicz
Scale:	1:200

**Virgin media**

**Believ**

Internal Use Only

Reference:	NBU314069 Walf-L380
EVC-ID	WALF_B08_L0380
Works Address:	S/O 84 Waverley Avenue, Waltham Forest, London, E4 8HT
Drawing No.	010 - TR0/TMO
Planned in accordance to: NSH3582 - Issue 1, NSH3132 - Issue 7, Site Visit & Drawing Guidance (18/05/2020) Partner Scoping Document - Issue 1.1, SoW for EVC Delivery v0.4, Statement of Requirements v0.7	

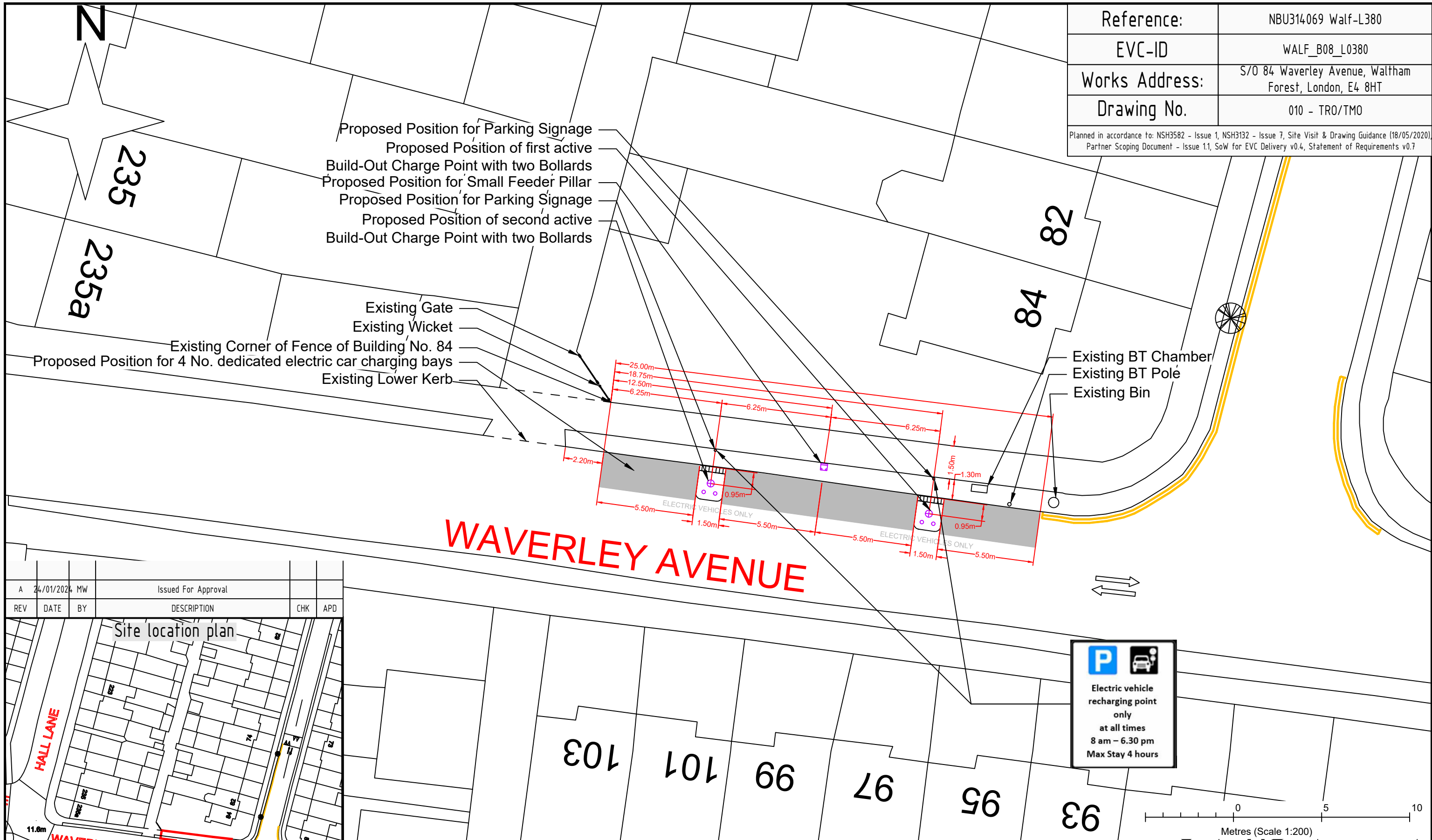

A	24/01/2024	MW	Issued For Approval		
REV	DATE	BY	DESCRIPTION	CHK	APD

Site location plan

HALL LANE

WAVERLEY AVENUE

11.6m

0 10 20 30 40 50 60 70 80 90  
Metres (Scale 1:1250)

Any modifications to the drawing or use of alternative items to those specified must be agreed with Virgin Media's local planning department

Reproduction from the Ordnance Survey map by Virgin Media with permission of Ordnance Survey on behalf of the Controller of Her Majesty's Stationary Office © Crown Copyright Virgin Media (100019209)

**Legend:**

- RG6 / RG11 Cable
- EVC Duct
- EV infrastructure boundary
- EVC Parking Bay
- EVC Charge Point
- EVC Feeder Pillar
- Bollard placement
- Build out Island with protection
- Bench
- Barrier
- Existing Drain / Chamber
- Bollard / Sign
- Bin
- Hedge
- Tree & Bush
- Lamp post

Drawing Scale is 1:200 when plotted at A3

Originator:	Arkadiusz Panas
Company Name:	Quasar
Issue Date / No.:	24/01/2024 / 1
Office:	Sheffield
Line Manager:	Tomasz Polanowicz
Scale:	1:200

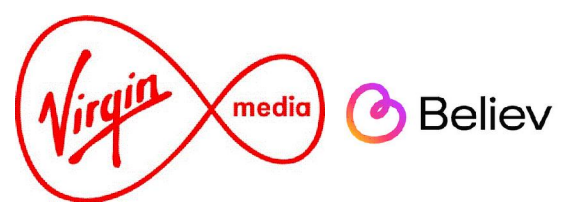
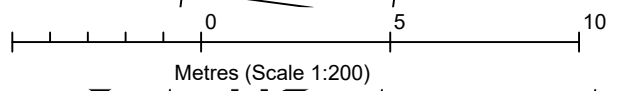
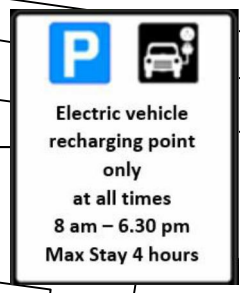

Internal Use Only

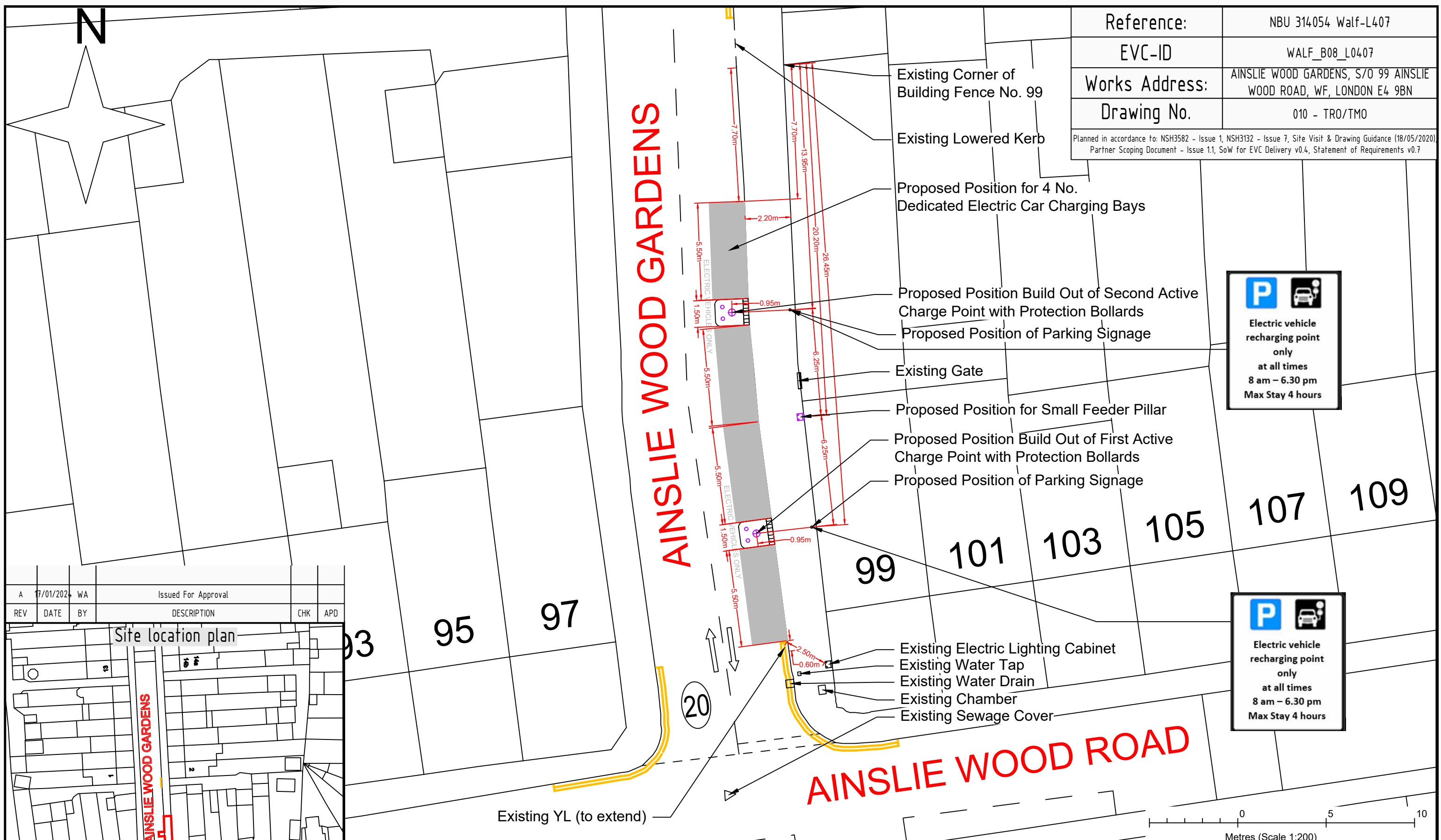

Reference:	NBU 314054 Walf-L407
EVC-ID	WALF_B08_L0407
Works Address:	AINSLIE WOOD GARDENS, S/O 99 AINSLIE WOOD ROAD, WF, LONDON E4 9BN
Drawing No.	010 - TR0/TMO
Planned in accordance to: NSH3582 - Issue 1, NSH3132 - Issue 7, Site Visit & Drawing Guidance (18/05/2020) Partner Scoping Document - Issue 1.1, SoW for EVC Delivery v0.4, Statement of Requirements v0.7	

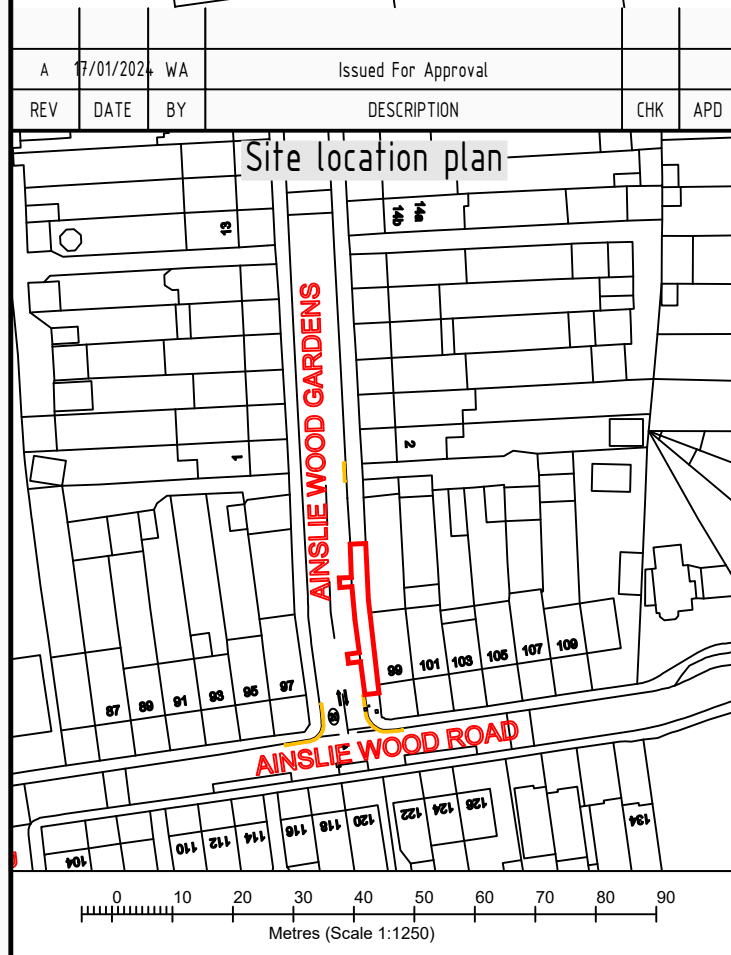
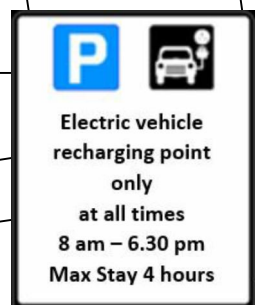

Any modifications to the drawing or use of alternative items to those specified must be agreed with Virgin Media's local planning department

Reproduction from the Ordnance Survey map by Virgin Media with permission of Ordnance Survey on behalf of the Controller of Her Majesty's Stationary Office © Crown Copyright Virgin Media (100019209)

**Legend:**

	RG6 / RG11 Cable		Bench
	EVC Duct		Barrier
	EV infrastructure boundary		Existing Drain / Chamber
	EVC Parking Bay		Bollard / Sign
	EVC Charge Point		Bin
	EVC Feeder Pillar		Hedge
	Bollard placement		Tree & Bush
	Build out Island with protection		Lamp post

Drawing Scale is 1:200 when plotted at A3

Originator:	Arkadiusz Panas
Company Name:	Quasar
Issue Date / No.:	17/01/2024 1
Office:	Sheffield
Line Manager:	Tomasz Polanowicz
Scale:	1:200

Internal Use Only