

# Calls for Expressions of Interest

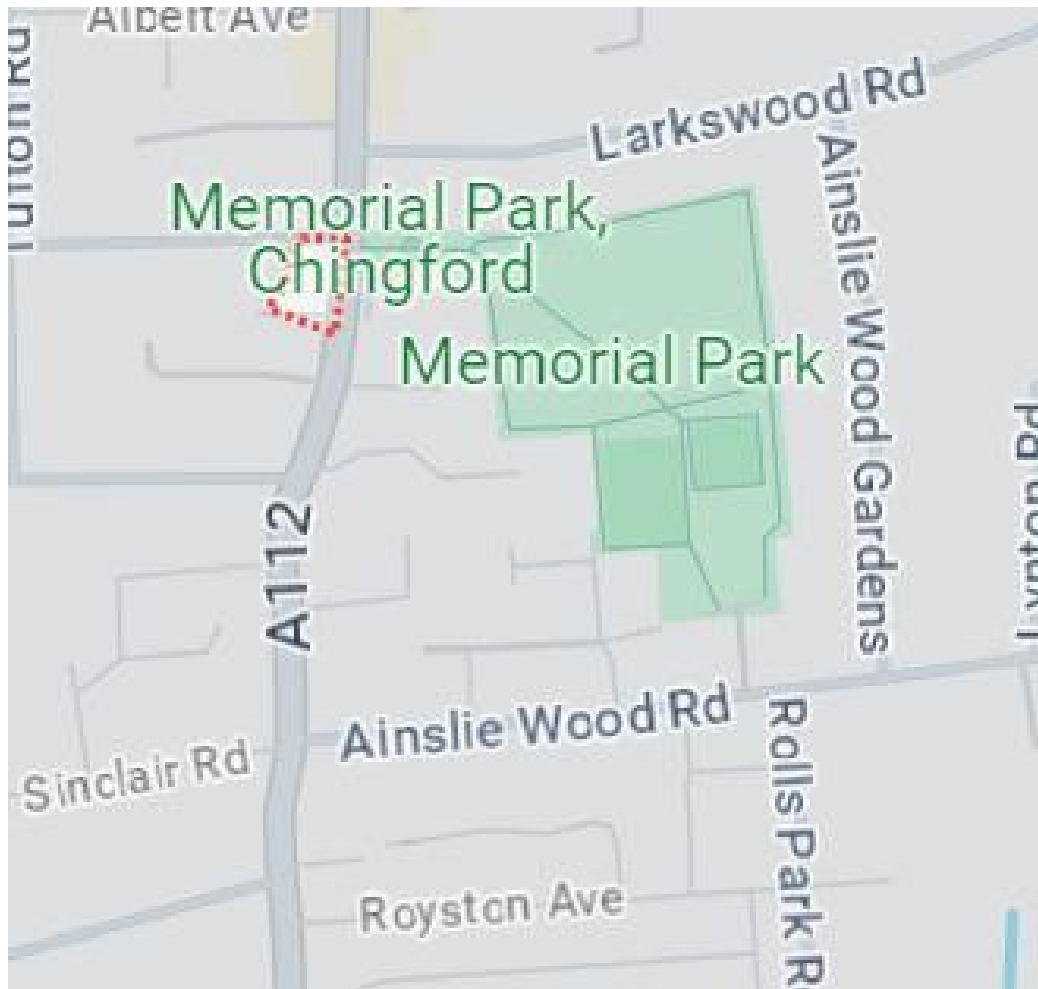

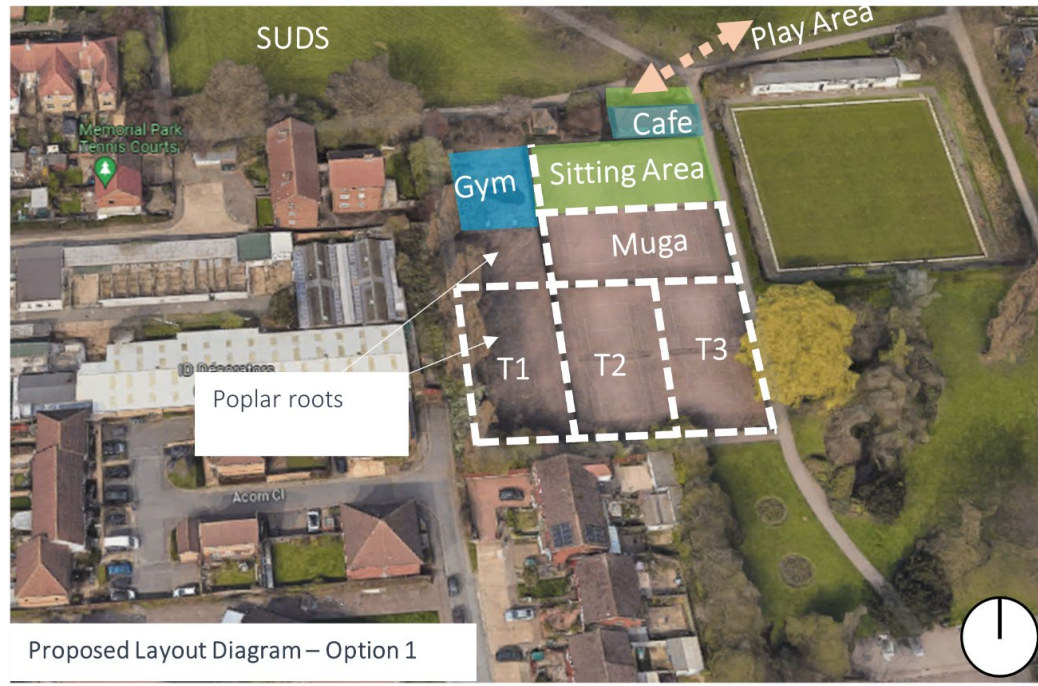



## LEASE TERM

A new flexible lease directly from the Landlord.

## LOCATION

The Pavilion is located in Memorial Park with a secondary entrance via the carpark on Ainslie Wood Road. It provides immediate access onto the A112, which then provides access to the A406 (North Circular).

## SIZE

The property has a Gross Internal Area of 68 sq m (731 sq ft).

## EXPRESSIONS OF INTEREST

The purpose of this Invitation for Expressions of Interest is to identify a long-term operator for the Pavilion following the refurbishment of the property.

Improvements to the landscape, play and leisure improvements within Memorial Park are also being undertaken.

The pavilion offers a significant opportunity for the introduction of community uses and for the generation of income from hiring out for functions, events and activities (subject to the operator securing the appropriate permissions and licences).

The expression of interest pack is available upon request.

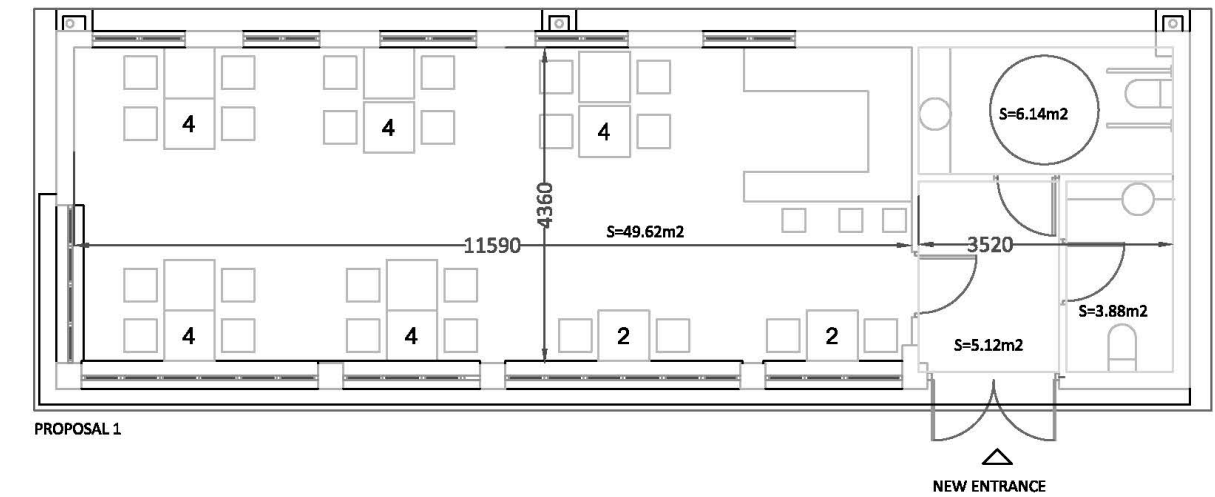

FOR FURTHER INFORMATION CONTACT:

Ryan Compton

07880 702286

[ryan.compton@walthamforest.gov.uk](mailto:ryan.compton@walthamforest.gov.uk)

