

**Davies Lane School Gateway**  
Proposed scheme / 3d view

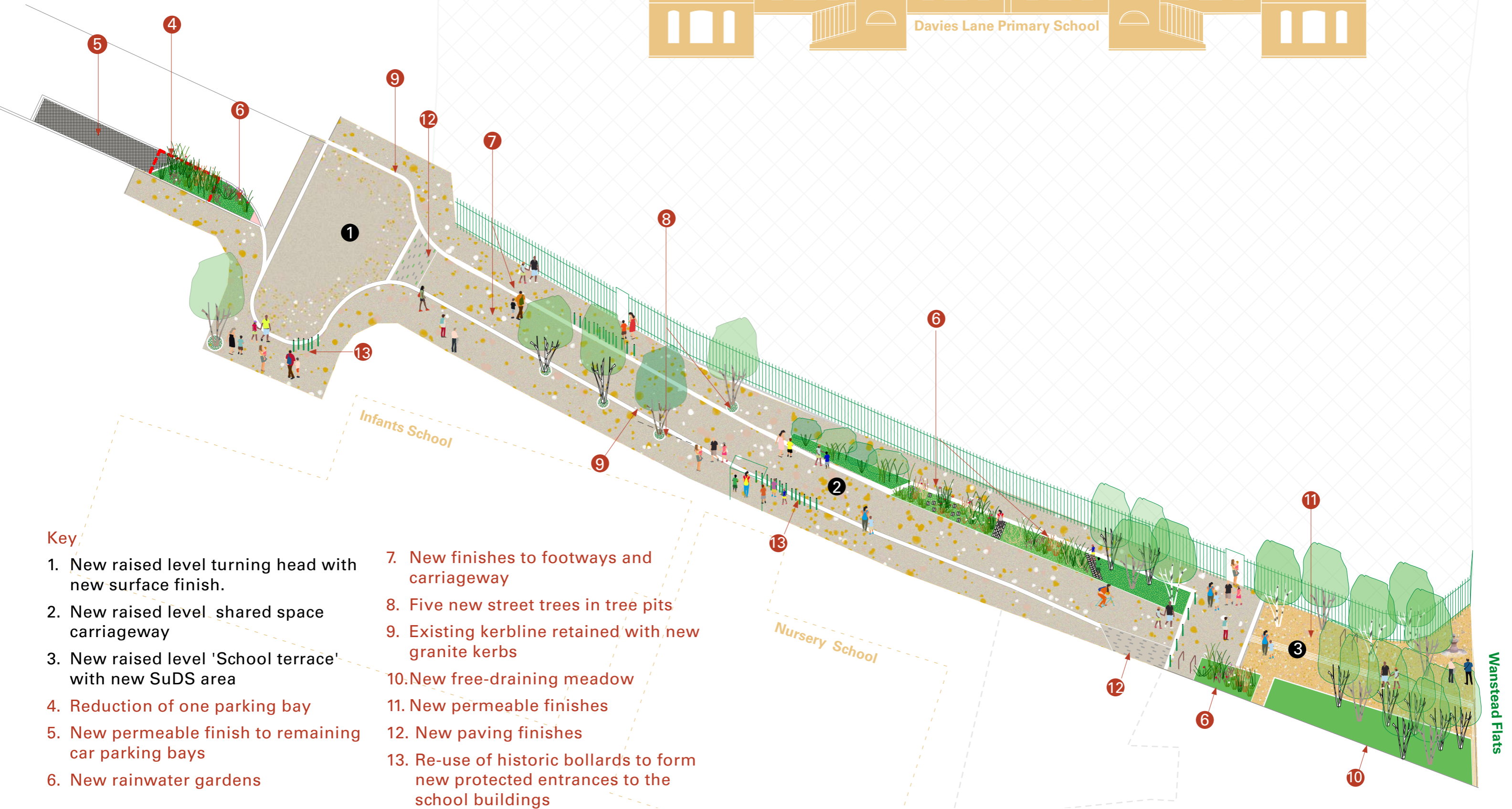
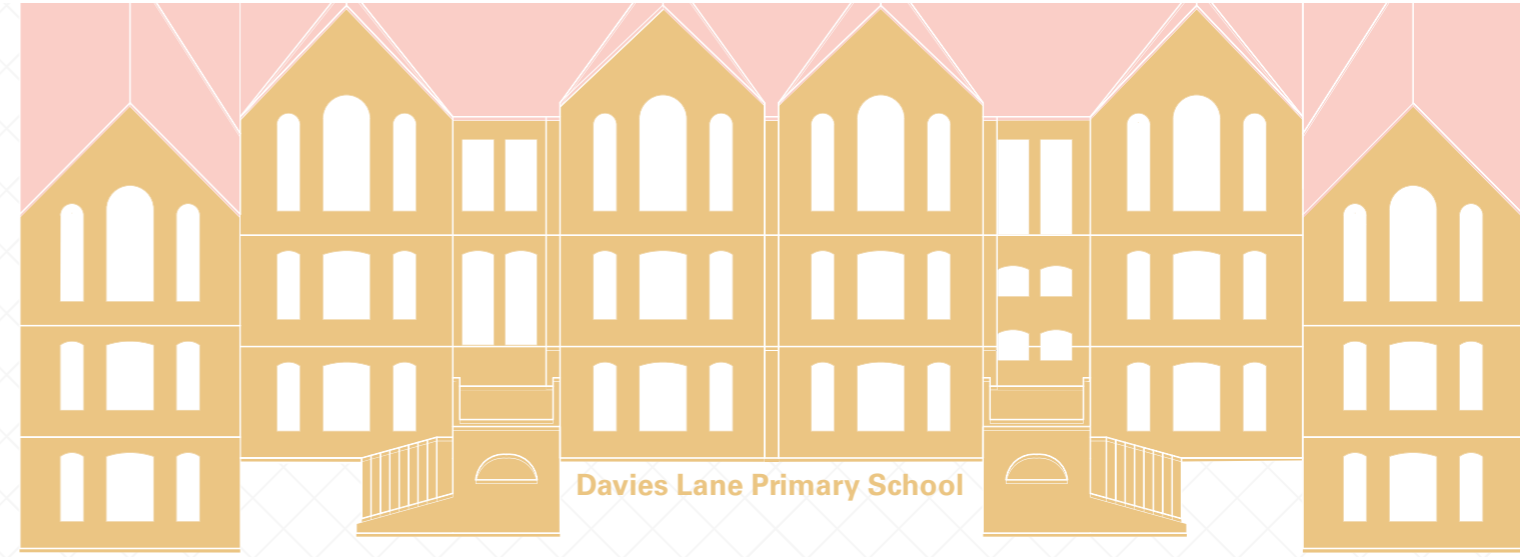

**Key**

- 1. New raised level turning head with new surface finish.
- 2. New raised level shared space carriageway
- 3. New raised level 'School terrace' with new SuDS area
- 4. Reduction of one parking bay
- 5. New permeable finish to remaining car parking bays
- 6. New rainwater gardens
- 7. New finishes to footways and carriageway
- 8. Five new street trees in tree pits
- 9. Existing kerbline retained with new granite kerbs
- 10. New free-draining meadow
- 11. New permeable finishes
- 12. New paving finishes
- 13. Re-use of historic bollards to form new protected entrances to the school buildings

Wanstead Flats

# Davies Lane School Gateway

## School Terrace / 3d view

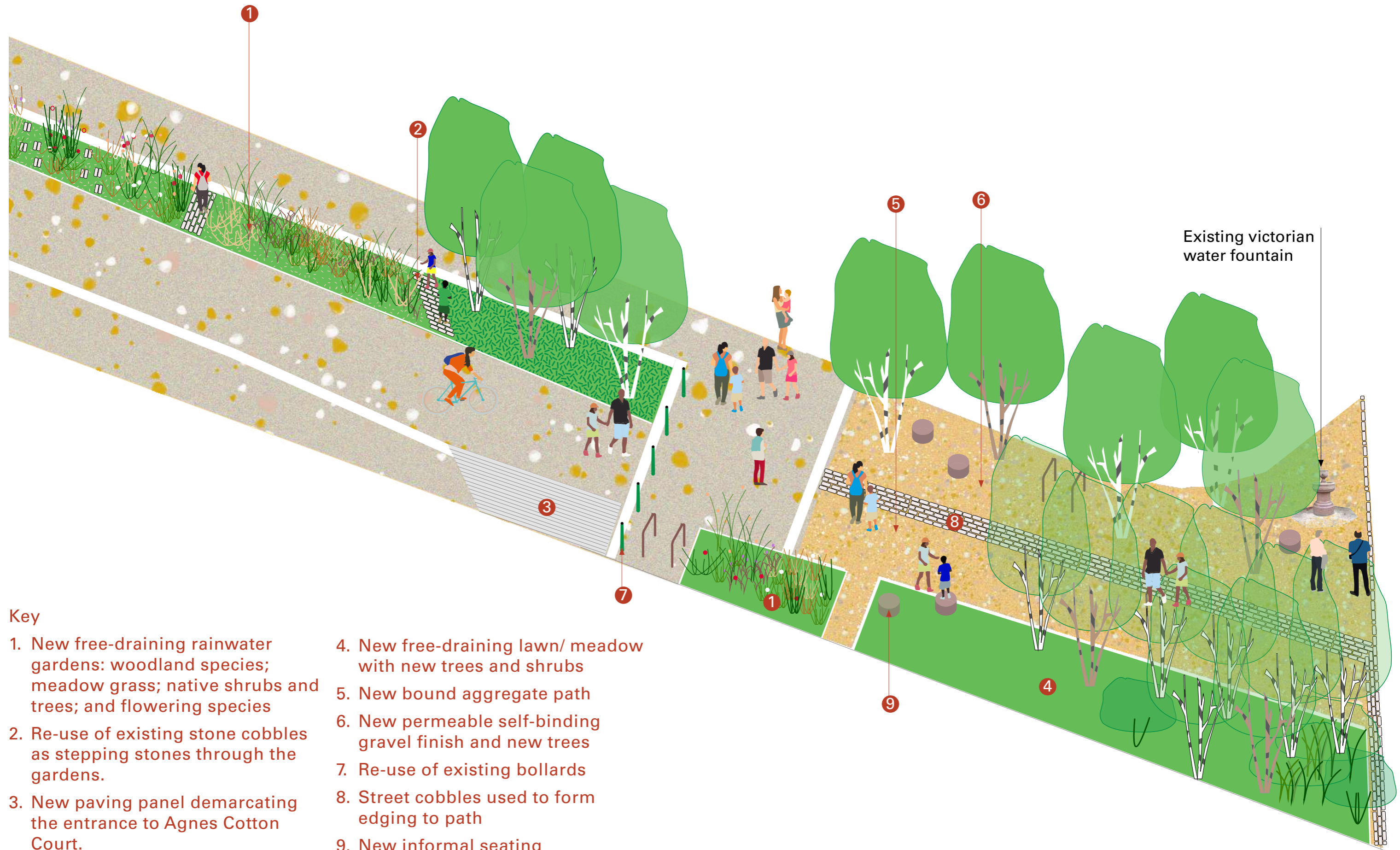

### Key

1. New free-draining rainwater gardens: woodland species; meadow grass; native shrubs and trees; and flowering species
2. Re-use of existing stone cobbles as stepping stones through the gardens.
3. New paving panel demarcating the entrance to Agnes Cotton Court.

4. New free-draining lawn/ meadow with new trees and shrubs
5. New bound aggregate path
6. New permeable self-binding gravel finish and new trees
7. Re-use of existing bollards
8. Street cobbles used to form edging to path
9. New informal seating

**Davies Lane School Gateway**  
View toward Wanstead Flats

**Key**

1. New surface finish to carriageway and footways
2. Playful bollard arrangements using existing bollards
3. New street trees
4. New rainwater gardens
5. New 'School Terrace'
6. Wanstead Flats

