

# A new crematorium.

Views of current Chingford Cemetery site

Waltham Forest Council is proposing a new crematorium at Chingford Mount Cemetery. Established in 1884, the 18-hectare cemetery came under council ownership in 1977. The burial ground features several noteworthy graves but it is anticipated that the cemetery will run out of available burial space within the next 8 to 10 years. Any new crematorium on the site will have to adhere to strict planning and environmental controls, limiting its effect on the surrounding area. Modern filtration systems mean there must be no smoke, smell or pollution coming from the crematorium, and it will be at least 100 yards away from any residential properties\*.

\*Source: London County Council (General Powers) Act 1935 Section 64, and 1971 Section 7.

This location will offer a tranquil, dignified setting to mourn the loss and celebrate the lives of loved ones, and brings the site major investment to secure a future for the cemetery.

The scheme addresses:

- Limited remaining burial space
- Lack of local capacity
- Lack of local funeral choice
- Cemetery future and financial security

**Engagement**

This consultation forms part of a series of community engagements, where the neighbours and stakeholder groups can be involved in developing this critical public service.

**Appointment**

A team of crematorium specialist consultants will be appointed to support designs up to planning submission in advance of the construction phase.

Indicative view of proposed location



**Site Heritage**



Original chapel



Original lodge and gates

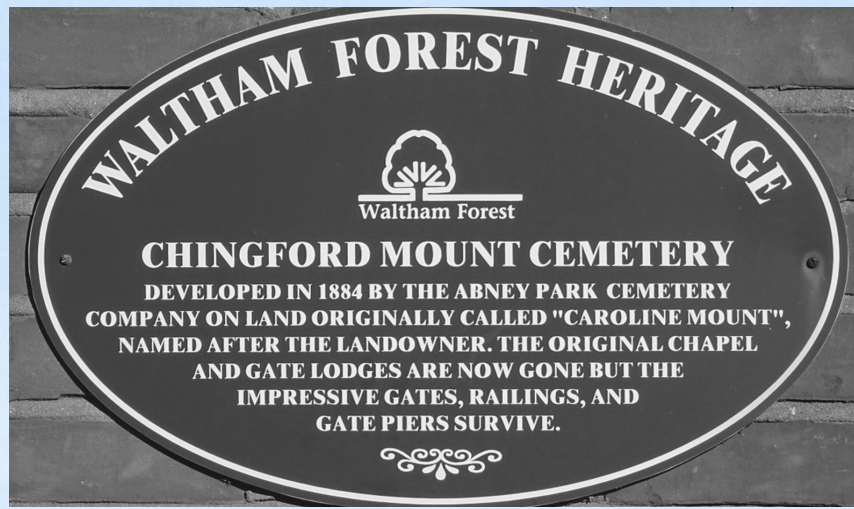

Historical photos from Chingford Mount Cemetery Facebook page





# A sense of peace.



## Waltham Forest Key Considerations—

### QUALITY

### EFFICIENCY

### SUSTAINABLE DESIGN

### PARTNERSHIPS

- Provision of a focal point for bereaved communities/families
- Support for local businesses; florists, hotels, and funeral-associated services
- Performance measured by the Institute of Cemetery & Crematorium Management (ICCM) standards
- Exemplar design that enhances the landscape and biodiversity
- Delivers a much needed service – cremation is favoured by an estimated 77% of residents
- Ensuring sufficient cemetery capacity over the next decade
- Wider funeral services choices
- Affordable funeral options
- Improved sustainable urban drainage
- Electric charging stations and cycle storage
- Photovoltaic system (PV)
- Green roof rainwater harvesting
- Re-uses generated energy
- Air source heat pumps
- Electric chambers

## Design Focus

Pedestrian & vehicular flow

Reflection spaces

Enhanced pond

Flower memorial space

Memorial garden

Woodland resting spaces

Parking & deliveries



**Water** has restorative properties located close to the building. The nearby pond allows this to flow through the site.

**Nature** symbolises the life cycle and is at the heart of the cemetery. Nature offers peace and calmness. The original chapel was located close to the proposed site.



Materials reflect setting



Reflective courtyard spaces will be considered as part of the design



Pond as part of the overall design



# A focal point for the community.

Based on an initial analysis of the constraints and opportunities for this scheme, the crematorium is proposed in the centre of the cemetery as indicated in the site location plan.

The indicative plans encompass an approximate area of 500-600m<sup>2</sup>, which will include the main vehicle approach and pedestrian entrance with waiting area, chapel, crematorium hall, office space and family area.

External provision will include wheelchair accessible parking spaces, cycle parking spaces and landscaping works.



Site Plan

## Indicative Layout

A dynamic form, the chapel block and entrance area is separated from staff areas celebrating its circular form.

Views from the chapel to the natural landscape beyond.

Crematory hall is sited at the back of the site in a separate block with a link to the chapel building.

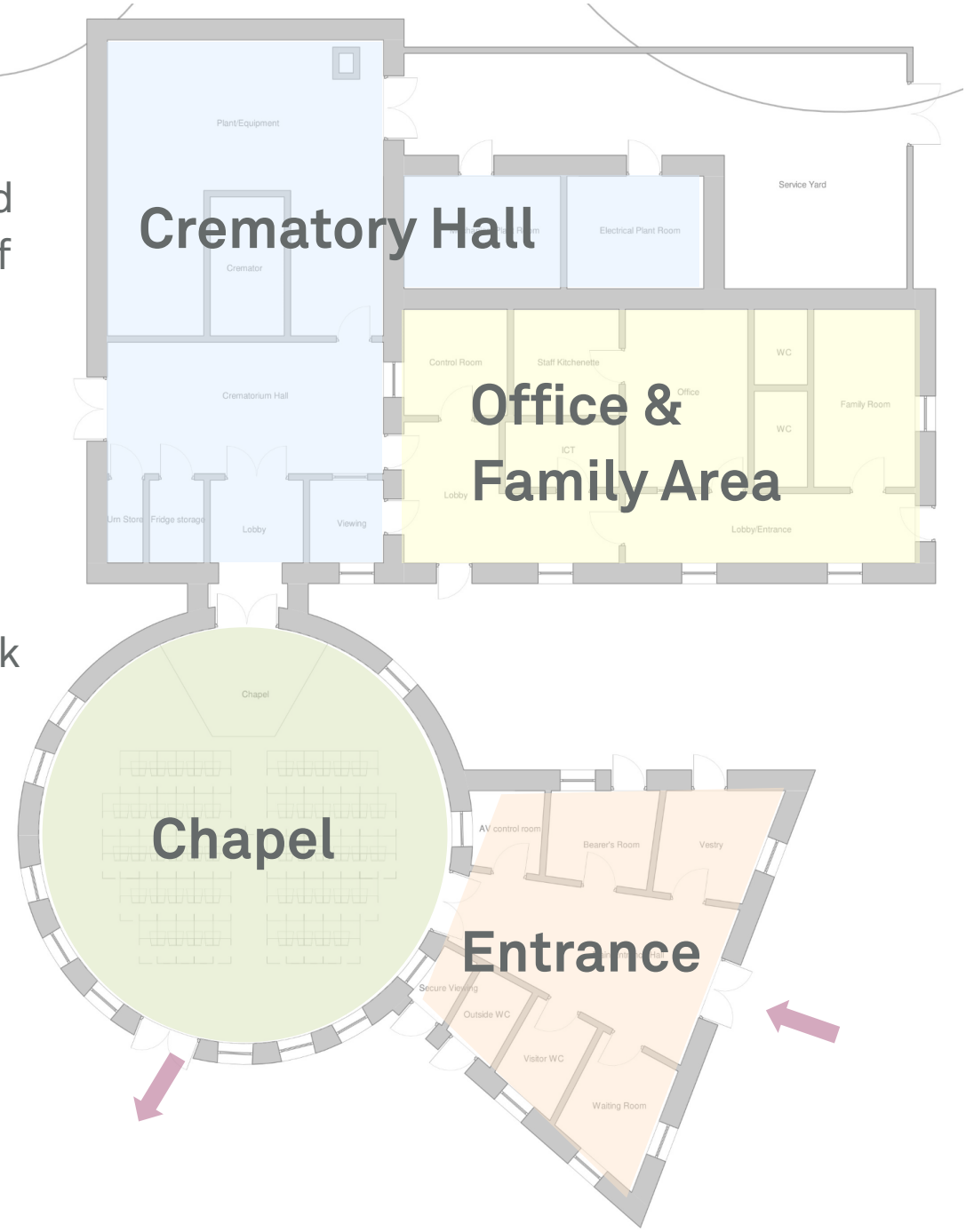

## Location Plan

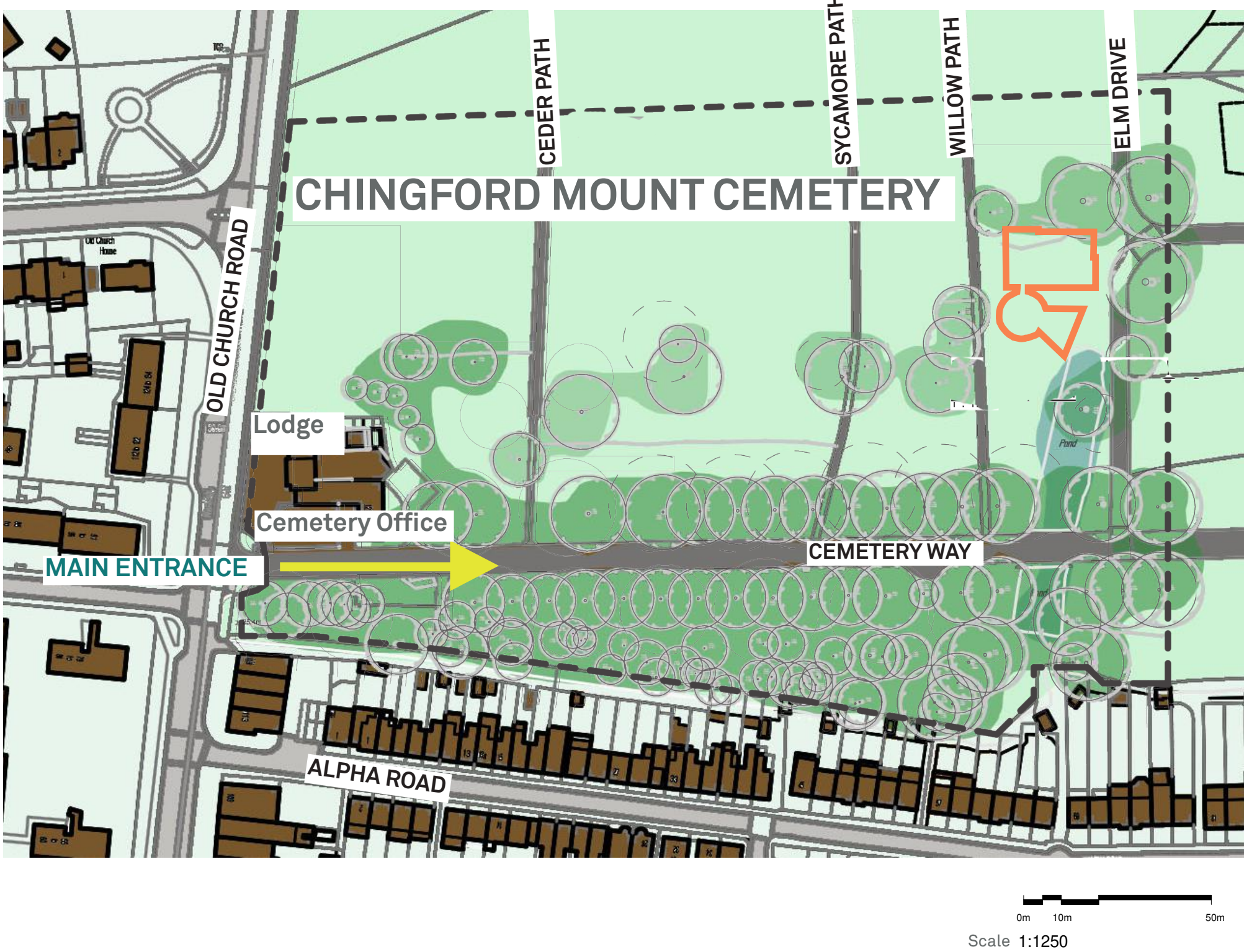

## Indicative Project Time-line

Design Stage - Summer 2024

Planning - Autumn/Winter 2024

Manufacturing and Construction - 2026

