



## LONDON BOROUGH OF WALTHAM FOREST

### TRAFFIC MANAGEMENT ORDER

202\* No. \*\*

---

The Waltham Forest (Housing Estate Car Parks) (No. 1) (Amendment No. \*) Order 202\*

Made \*\*\*

Coming into operation \*\*\*

---

The Council of the London Borough of Waltham Forest, after consulting the Commissioner of Police of the Metropolis, in exercise of the powers conferred by sections 35 and 124 of and Part IV of Schedule 9 to the Road Traffic Regulation Act 1984<sup>1</sup>, as amended, and of all other powers thereunto enabling, hereby make the following Order:

#### Citation and commencement

1. This Order shall come into operation on \*\*\* and may be cited as The Waltham Forest (Housing Estate Car Parks) (No. 1) (Amendment No. \*) Order 202\*.

#### Interpretation

2. (1) In this Order:

“the Order of 2021” means The Waltham Forest (Housing Estate Car Parks) (No. 1) Order 2021<sup>2</sup>;

“drawing” means a drawing attached to this Order and listed in the Schedule to this Order which identifies the estate, restricted areas and off-street parking places, along with types of parking bays within an off-street parking place, and, if appropriate, certain of their governing provisions;

“off-street parking place” means an area of land which has been provided for use by the Council as an off-street parking place under the powers conferred by section 32 of the 1984 Act, and to the conditions of use of which the provisions of this Order and the Order of 2021 apply;

“parking bay” means an area within an off-street parking place which is provided for the leaving of one vehicle only at a time, being either a permit parking bay, a disabled resident permit parking bay, a disabled persons’ blue badge parking bay, a solo motor cycle parking bay or a short term parking bay in each case being identified as such type on a drawing; and

“restricted area” means any area of an off-street parking place which is either a footpath, a pavement or a grassed area or which is indicated by:

- (a) double yellow lines, similar to the road marking shown in diagram 1018.1 of the Traffic Signs Regulations and General Directions 2016, marked on the surface of that off-street parking place;
- (b) yellow cross-hatching marked on the surface of that off-street parking place; or

---

<sup>1</sup> 1984 c.27

<sup>2</sup> LBWF 2021/85

- (c) signs indicating that the area is a 'restricted parking zone';
- (2) Any reference in this Order to any enactment shall be construed as a reference to that enactment as amended, applied, consolidated, re-enacted by or as having effect by virtue of any subsequent enactment.
- (3) Unless the context otherwise requires, any expression used in this Order which is also used in the Order of 2021 shall have the same meaning as in that Order.

#### Amendment to the Order of 2021

- 3. Without prejudice to the validity of anything done, or to any liability incurred in respect of any act or omission before the coming into operation of this Order, the Order of 2021 shall have effect as though there was added to Schedule 1 to that Order the drawing thereto specified in columns 1, 2 and 3 of the table of the Schedule to this Order; and

#### Waiting restrictions applicable in restricted areas

- 4. Without prejudice to the validity of anything done or to any liability incurred in respect of any act or omission before the coming into operation of this Order, the Order of 2021 shall have effect as though any restricted area identified in a drawing and, where applicable, by way of either a drawing label or legend, or both, and marked out and signed as a restricted area, shall be construed as though it were a restricted area referred to in the Order of 2021.

#### Placement of traffic signs and infrastructure in relation to off-street parking places

- 5. The Council shall:
  - (1) cause the limits of each off-street parking place, restricted area, and where appropriate, each parking bay, within an off-street parking place to be indicated by the placing and maintaining of appropriate traffic signs or surface markings;
  - (2) place and maintain in or in the vicinity of each off-street parking place, restricted area or parking bay, traffic signs indicating that such off-street parking place or parking bay may be used during the controlled hours for the leaving of vehicles specified in Article 3 of the Order of 2021; and
  - (3) carry out such other work as may be reasonably required for the purposes of the satisfactory operation of an off-street parking place.

Dated this \*\* day of \*\*\*202\*

Mr J. Griffin  
Corporate Director of Neighbourhoods  
(The officer appointed for the purpose)

**SCHEDULE – LIST OF DRAWINGS** (attached to this Order)

(see Article 2(1) of the Order of 2021 – definition of “drawing”)

**(ADDITION TO SCHEDULE 1 OF THE ORDER OF 2021)**

<b>1</b> <b>Drawing No.</b>	<b>2</b> <b>Drawing Title</b>	<b>3</b> <b>Date</b>
H-MBA-02	Master Baker Almshouses Restricted Parking Zone No Waiting “At Any Time” Except In Signed Bays	14/09/23

### **EXPLANATORY NOTE**

(This Note is not part of the Order, but is intended to indicate its general purport.)

This Order amends The Waltham Forest (Housing Estate Car Parks) (No. 1) Order 2021 to include the Bakers' Almshouses housing estate car park and to include the provision of the restricted parking zone "no waiting at any time", in the London Borough of Waltham Forest.

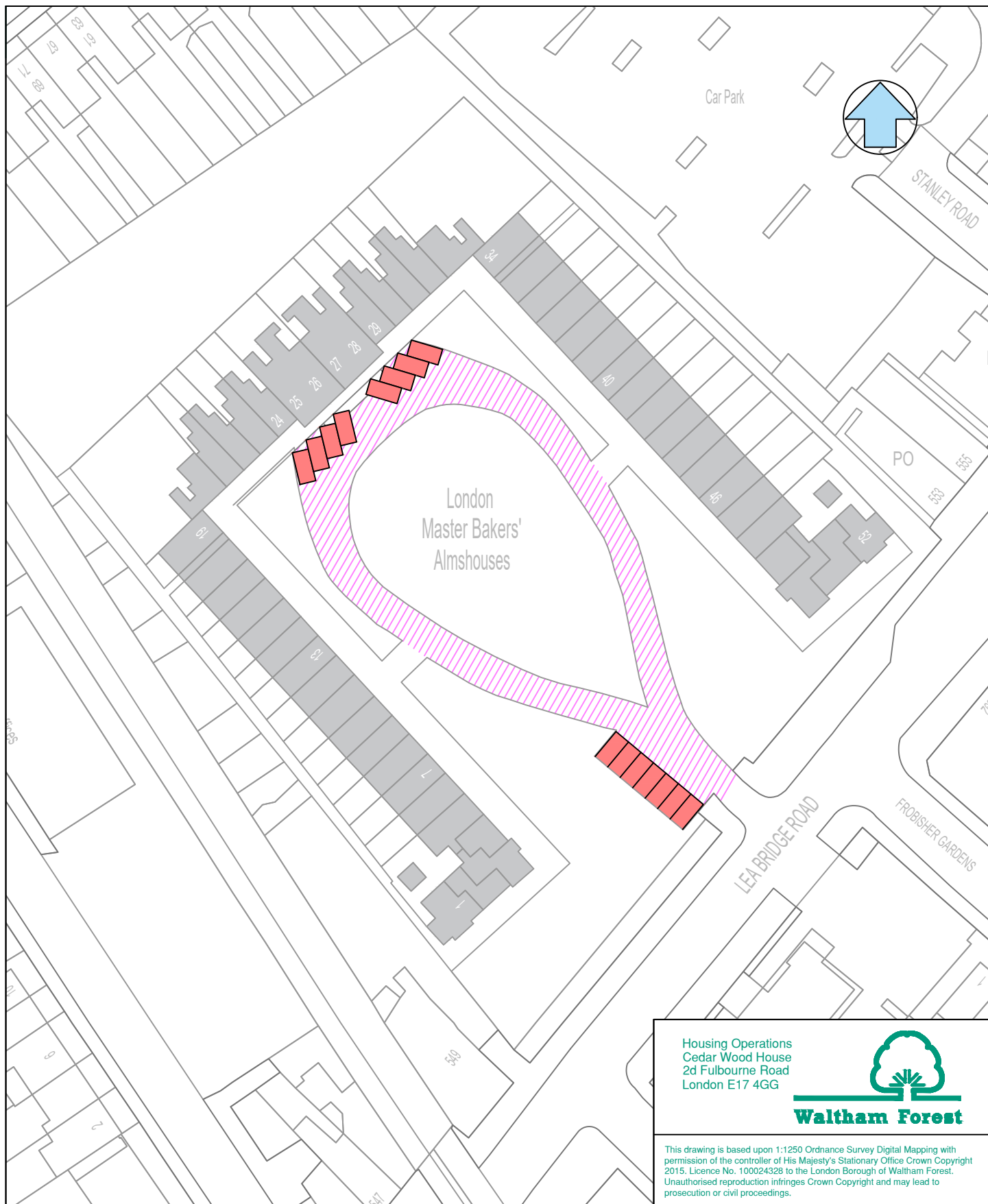

#### KEY



Restricted area "no waiting at any time"



Unrestricted parking bays "at any time"

Housing Operations  
Cedar Wood House  
2d Fulbourne Road  
London E17 4GG



This drawing is based upon 1:1250 Ordnance Survey Digital Mapping with permission of the controller of His Majesty's Stationary Office Crown Copyright 2015, Licence No. 100024328 to the London Borough of Waltham Forest. Unauthorised reproduction infringes Crown Copyright and may lead to prosecution or civil proceedings.

#### Job Title

MASTER BAKER ALMSHOUSES

#### Drawing Title

MASTER BAKER ALMSHOUSES RESTRICTED PARKING ZONE  
NO WAITING "AT ANY TIME" EXCEPT IN SIGNED BAYS

Chkd. by

Date

14/09/23

Scale

A4 @ 1:500

Drawn by

D.G.F.

Drawing No.

H-MBA-02