

Area of restricted zone. No waiting and no loading at any time

Key: <div><div><div><div><div>A</div><div>New raised level turning head and new surface finish</div></div><div><div>B</div><div>New raised level shared space carriageway</div></div><div><div>C</div><div>New raised level 'School terrace' with new SuDS area</div></div><div><div>D</div><div>Driveway entrance to housing car park</div></div><div><div>1</div><div>Gate to primary school</div></div><div><div>2</div><div>Gate to nursery school</div></div><div><div>3</div><div>Gate to infants school</div></div><div><div>4</div><div>Gate to adjacent private property</div></div></div><div><div><div><div><div></div><div>New and reused 150mm and 300mm width granite kerbs/channels granite units</div></div><div><div></div><div>Outline of existing granite kerbs, to be retained and re-used.</div></div><div><div></div><div>Charcon Andover Textured units and Marker blocks panel</div></div><div><div></div><div>Charcon Andover Textured units</div></div><div><div></div><div>Ayton Colourchip footway and carriageway finish – ref. <i>Norfolk Gravel</i></div></div><div><div></div><div>Breedon Golden Amber path</div></div><div><div></div><div>CEDEC loose self-binding gravel – ref. <i>Gold</i></div></div><div><div></div><div>ECO Grid 50 finish with gravel topping - <i>Norfolk Gravel</i></div></div></div><div><div><div><div><div></div><div>Re-use of existing stone cobbles</div></div><div><div></div><div>Re-use of existing granite kerbs, as stepping stones.</div></div><div><div></div><div>Special granite unit including engraving.</div></div><div><div></div><div>Re-use of existing 'heritage' bollards</div></div><div><div></div><div>New bollards</div></div><div><div></div><div>New cycle stands</div></div><div><div></div><div>New bespoke timber seats</div></div><div><div></div><div>New trees</div></div><div><div></div><div>New shrubs</div></div><div><div></div><div>New tree pits</div></div><div><div></div><div>New rainwater gardens</div></div><div><div></div><div>New free-draining garden</div></div><div><div></div><div>New free-draining grass lawn/meadow</div></div><div><div></div><div>New gully</div></div><div><div></div><div>Existing gully</div></div><div><div></div><div>Existing lamppost</div></div><div><div></div><div>Existing illuminated signpost</div></div><div><div></div><div>Location of existing signpost</div></div><div><div></div><div>Location of existing street service covers</div></div><div><div></div><div>Reduction in parking bays (1No. Bay)</div></div></div></div></div></div></div></div></div>	Notes: <div><div>1.01 Retain existing kerb line and form new areas of reconfigured kerb line/carriageway demarcation as shown.</div><div>1.02 Remove and retain existing granite kerbs and stone cobbles. To be re-used in landscaping details as shown. New Finishes / Surfaces.</div><div>1.03 Remove 5m of parking extend nearby no waiting and no loading restrictions</div><div>2.01 New and/or reused 300mm wide 300mm depth granite kerbs to form carriageway demarcation. Units to be laid flush with carriageway and footway. (ref Silver Grey).</div><div>2.02 New 150mm wide 300mm depth granite kerbs to form edge restraints to resurfaced parking bay and raingardens to the carriageway side (ref Silver Grey).</div><div>2.03 New Ayton Colourchip footway and carriageway finishes. Resin coated chippings fully bonded to new HRA finish. PC14 20mm Norfolk Gravel clear coated aggregate laid at 25% coverage spread rate (6.5kg per square metre).</div><div>2.04 Two metre width coverage of Colourchip resin coated chippings from edge of kerb/channel face to turning head new finish (spread rates as note 2.03)</div><div>2.05 Charcon Andover Textured 100x200x80mm paving units. Units laid in stretcher bond pattern, set parallel to</div></div> <div>Davies Lane. Rigid construction, with 2-5mm joints. Units laid over 30mm depth nominal bedding layer over sub-base. 300mm width linear section to laid to form shallow gully, adjacent panel forming demarcation for entrance to housing car park. (ref: Medium Grey)</div> <div>2.06 New panel of block paving formed from Charcon Andover Textured 100x200x80mm units (ref: Medium Grey) and Tobermore Marker Block 100x200x80mm units (ref: Green)</div> <div>2.07 Breedon Golden Amber Gravel path laid at a finished compacted thickness of 50mm over laid onto a 150mm depth compacted quarried MOT Type 1 sub-base. Rolled and vibrated surface laid to a cross fall minimum of 1 in 40.</div> <div>2.08 CEDEC loose self-binding gravel finish laid to 65mm depth. Compact finish to 50mm depth and set at 5-10mm lower than the adjacent edging. Foundation layer laid to uniform crossfall (geotextile may be used underneath the sub-base if ground conditions so indicate) - 150mm min. compacted sub-base consisting of a free draining layer of inert MOT Type 1.</div> <div>2.09 Re-used stone cobbles as edging between Breedon path and free-draining lawn. Laid in stretcher bond and forming shallow gutter.</div>
--	---

2.10 Kinley ExcelEdge BISON heavy-duty 150mm steel kerb to form edging to footway raingarden and new free-draining garden; footway edge to Andover Textured entrance panel; between Breedon and Cedec finishes.

2.11 Kinley Aluexcel pre-formed circular tree-pit surrounds, 4No. units with 450mm radius, 1No. unit with 600mm radius.

Landscaping

3.01 New tree pits: Excavate to min. depth 1.5 x rootball. For clay / compacted subbase provide perforation holes at base of pit. Soil: 50% backfill, 40% screened loam and 10% organic matter. To include SuperCEDEC loose self-binding gravel topping, **compacted to 50mm depth**.

3.02. Main carriageway rainwater garden:

3.03 'Flush-edged' rainwater gardens:

3.04 Free-draining garden

3.05 Free draining lawn meadow

3.06 New trees and street trees

Street furniture

4.01 New timber bollards TBC

4.02 6no. new Broxap CaMden 'M' bike stands.

4.03 Re-used 'heritage' bollards. Existing paintwork to be stripped back and units to receive new painted finish (colour and graphics to be confirmed)

4.04 10 No. new bespoke timber seating units supplied by *Owen Bullet*.

4.05 5No. existing 'heritage' lampposts to be re-painted. (Colour TBC).

4.06. Existing water fountain to be cleaned and receive remedial restoration works.

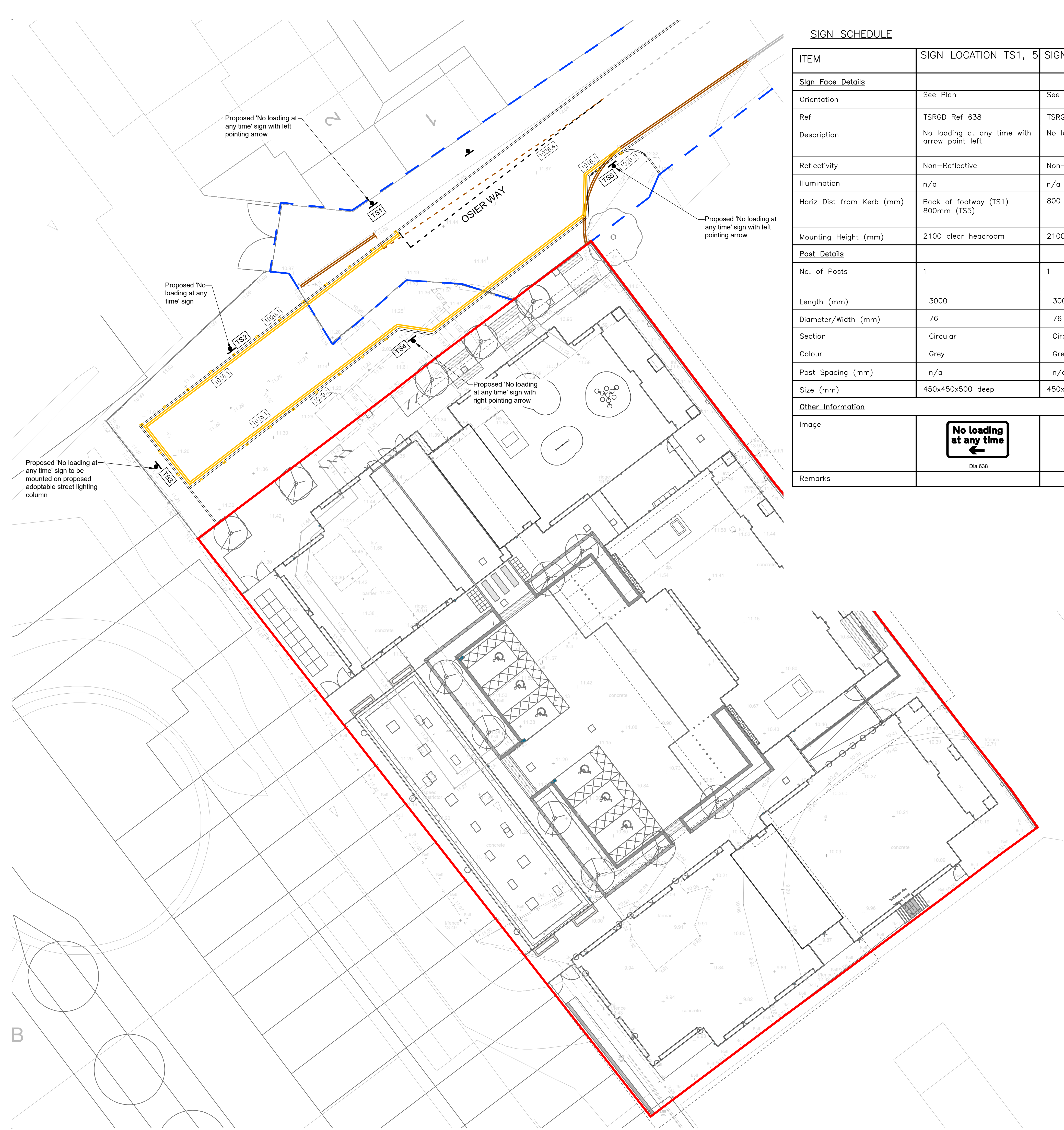

SIGN SCHEDULE

ITEM	SIGN LOCATION TS1, 5	SIGN LOCATION TS2	SIGN LOCATION TS3	SIGN LOCATION TS4
Sign Face Details				
Orientation	See Plan	See Plan	See Plan	See Plan
Ref	TSRGD Ref 638	TSRGD Ref 638	TSRGD Ref 638	TSRGD Ref 638
Description	No loading at any time with arrow point left	No loading at any time	No loading at any time	No loading at any time with arrow point right
Reflectivity	Non-Reflective	Non-Reflective	Non-Reflective	Non-Reflective
Illumination	n/a	n/a	n/a	n/a
Horiz Dist from Kerb (mm)	Back of footway (TS1) 800mm (TS5)	800	800	2000
Mounting Height (mm)	2100 clear headroom	2100 clear headroom	2100 clear headroom	2100 clear headroom
Post Details				
No. of Posts	1	1	Proposed Lamp Column to be used	1
Length (mm)	3000	3000	n/a	n/a
Diameter/Width (mm)	76	76	n/a	n/a
Section	Circular	Circular	n/a	n/a
Colour	Grey	Grey	n/a	n/a
Post Spacing (mm)	n/a	n/a	n/a	n/a
Size (mm)	450x450x500 deep	450x450x500 deep	450x450x500 deep	450x450x500 deep
Other Information				
Image				
Remarks	Dia 638	Dia 638	Dia 638	Dia 638

General Notes

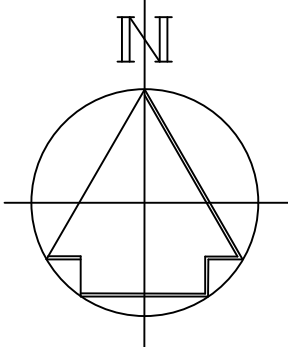

Highway works are subject to agreement with Waltham Forest

All S278 and S38 Works shall be in accordance with:
The Specification for Highway Works (MCHW).

The position of underground utilities shall be verified and established on site by the contractor prior to commencing construction.

F	24.04.23	Road markings updated to suit changes to loading bay kerbline. Sign locations amended, and schedule updated to suit.	CH	MFD
E	31.03.23	Kerbs updated and road markings amended to suit. Loading markings replaced with double yellow. No loading at any time markings and signs added.	CH	MFD
D	16.03.23	Site layout updated. Kerb lines updated. Double yellow lines updated.	AGSC	MFD
C	11.01.23	Landscape architect layout updated. Topo and Proposals layers assigned different shades of gray. Color of existing road markings changed to gray. S278 Boundary Updated. Tactile Paving removed. Scale of drawing changed.	AGSC	CH
B	21.11.22	Double yellow markings added to western end of Osier Way. Extent of 278 boundary updated. Junction and markings to eastern end of 278 works added. Landscape layout to site updated.	AGSC	CH
A	11.11.22	Issued for comment.	AGSC	CH

REV DATE DESCRIPTION BY CHK'D

FOR APPROVAL

POCKET LIVING

TITLE:
Section 278/38
Road Markings and Signs

PROJECT:
Osier Way
Waltham Forest

SCALE: 1:20000A1 DATE: Nov 2022 DRAWN: AGSC CHK'D: CH
DRG NO.
14844-TDA-XX-XX-DR-C-60004

REV. TDA PROJECT NUMBER.
F 14844

Tullys

T: 01342 828 000 E: info@tullydeath.com W: www.tullydeath.com

Legend

Other Symbols

Existing Highway Boundary	
Site Boundary	
Road Markings - Existing parking bays to be removed	
Road Markings - Proposed parking/loading bays (TSRGD reference in box)	
Road Markings - Existing double yellows to be removed	
Road Markings - Proposed double yellows (TSRGD reference in box)	
Road Markings - Proposed no loading (TSRGD reference in box)	
Existing road markings to be retained	

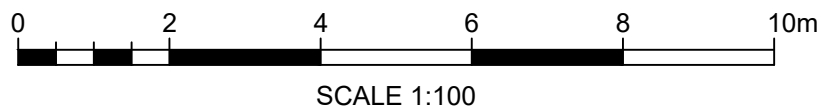

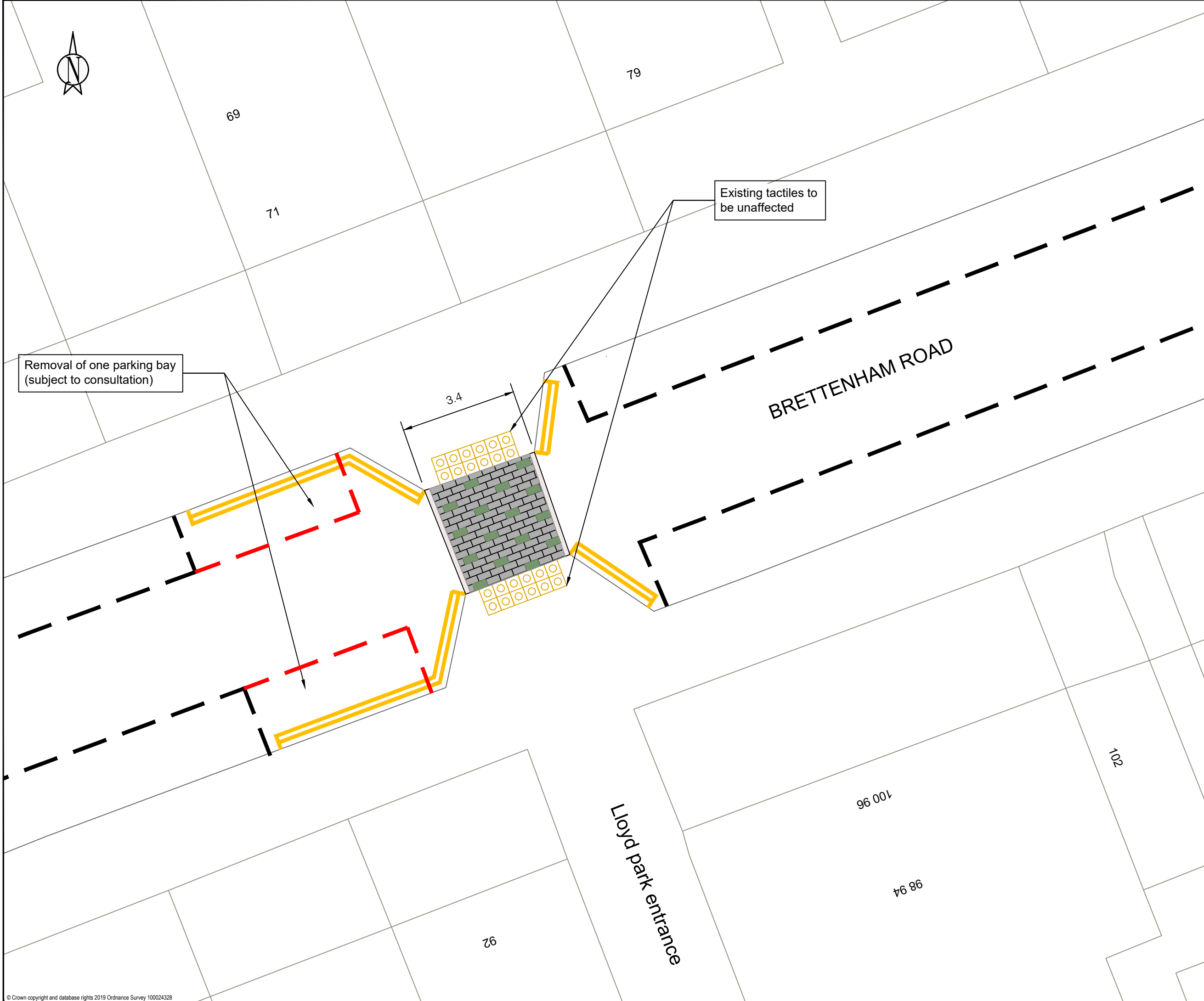

- NOTES:
- 1. All dimensions are in metres unless otherwise stated
 - 2. All levels are in metres unless otherwise stated

KEYS:

New pattern finish to crossing:
Andover textured block paving
(medium grey) and Marker
block (green)

New granite kerbs: 150mm
wide kerbs, channels and
garden surrounds.

Removal of one parking bay
(subject to consultation)

Existing tactiles to
be unaffected

BRETTENHAM ROAD

Lloyd park entrance

-			
-	-	-	-

RevNo.	Date	Description	By
--------	------	-------------	----

Revision	
TITLE	
Brettenham Road	
Sheet 1 of 1	

LONDON BOROUGH OF WALTHAM FOREST

Engineering Design
Group

Low Hall
Argall Ave
Leyton
London E10 7AS.

Designed by:	FS
Checked by:	ZJ
Drawing Size:	A3
Scale:	1:100
Location:	-
Filename:	-
Date:	26/07/2022
Drawing No.:	-
Revision:	-

Proposed Bikehangar
location occupying 2.5m of
space in front of border
between 6 and 8.

