

Reference:	NBU 284652 Walf-L338
EVC-ID	WALF_B07_L0338
Works Address:	o/s 3-9 Fernhill Court, Waltham Forest, London, E17 3RP
Drawing No.	010 - TR0/TMO
Planned in accordance to: NSH3582 - Issue 1, NSH3132 - Issue 7, Site Visit & Drawing Guidance (18/05/2020), Partner Scoping Document - Issue 1.1, SoW for EVC Delivery v0.4, Statement of Requirements v0.7	

A	01.09.2022	RG	Issued For Approval		
REV	DATE	BY	DESCRIPTION	CHK	APD
Site location plan					
0 10 20 30 40 50 60 70 80 90 Metres (Scale 1:1250)					

Any modifications to the drawing or use of alternative items to those specified must be agreed with Virgin Media's local planning department		Originator:	Arkadiusz Panas	
		Company Name:	Quasar	
		Issue Date / No.:	01/09/2022	1
		Office:	Sheffield	
		Line Manager:	Tomasz Polanowicz	
		Scale:	1:200	



Internal Use Only

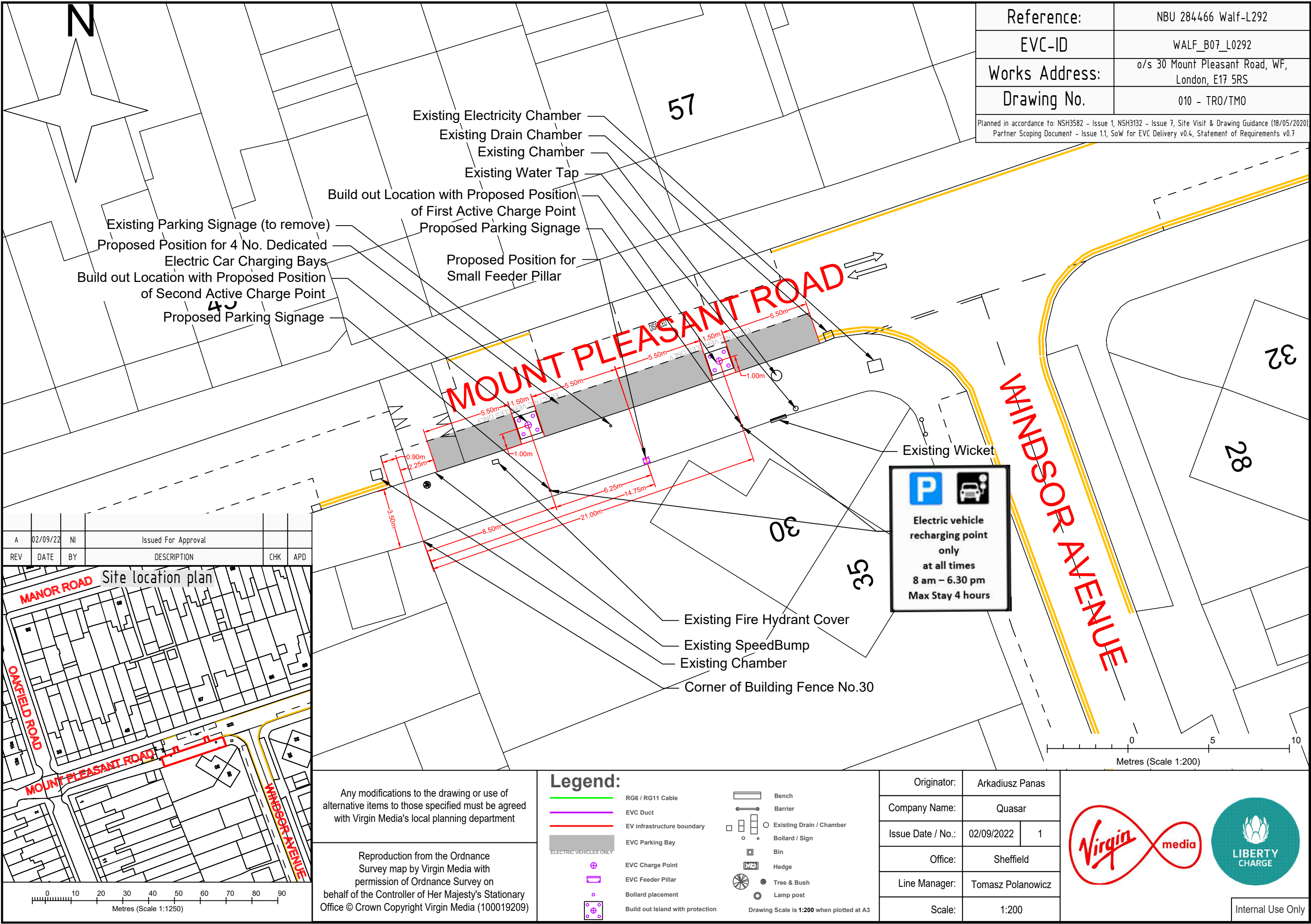

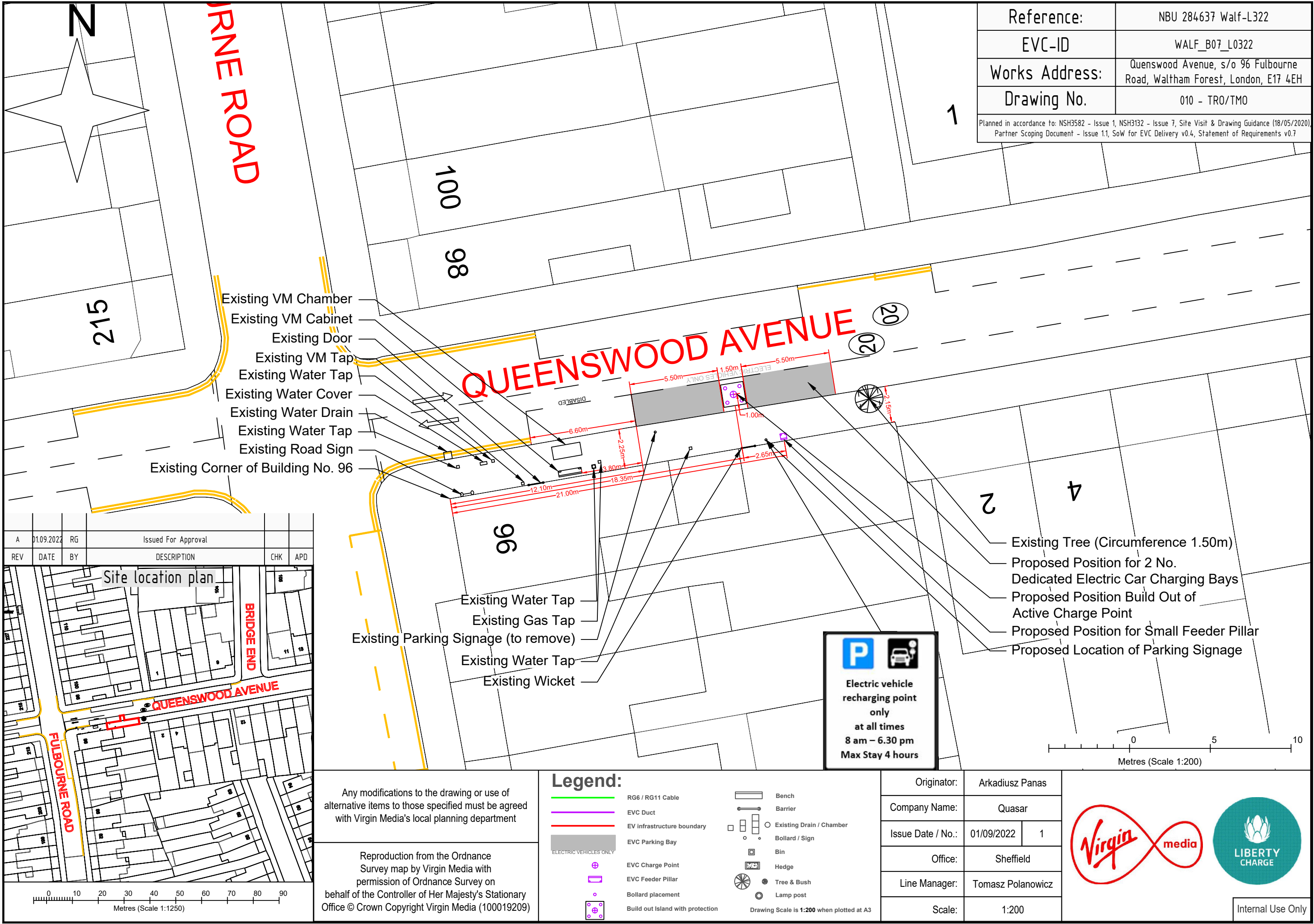

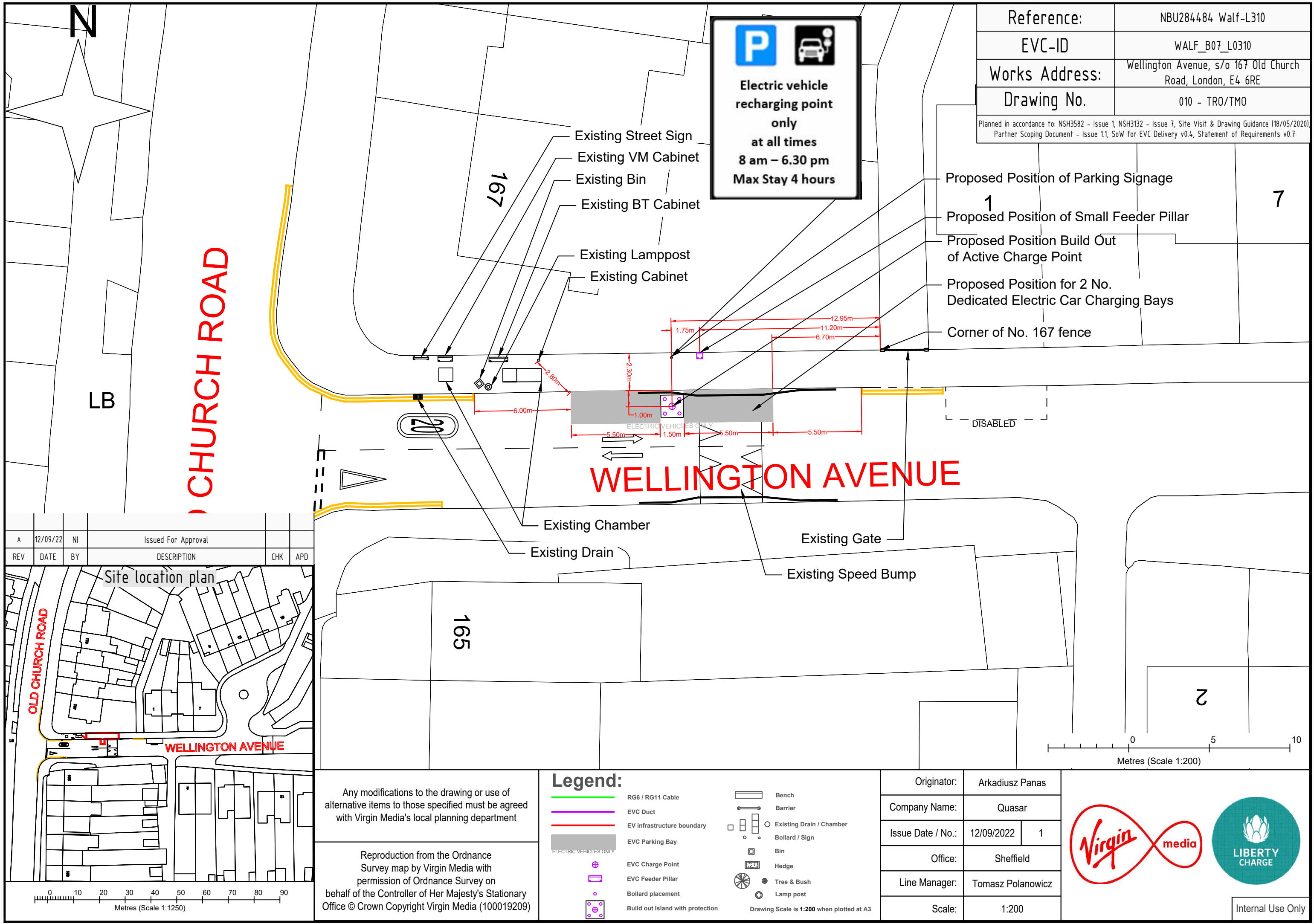

Reference:	NBU284484 Walf-L310
EVC-ID	WALF_B07_L0310
Works Address:	Wellington Avenue, s/o 167 Old Church Road, London, E4 6RE
Drawing No.	010 - TR0/TMO
Planned in accordance to: NSH3582 - Issue 1, NSH3132 - Issue 7, Site Visit & Drawing Guidance (18/05/2020) Partner Scoping Document - Issue 1.1, SoW for EVC Delivery v0.4, Statement of Requirements v0.7	

A	12/09/22	NI	Issued For Approval		
REV	DATE	BY	DESCRIPTION	CHK	APD

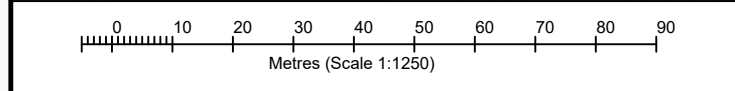
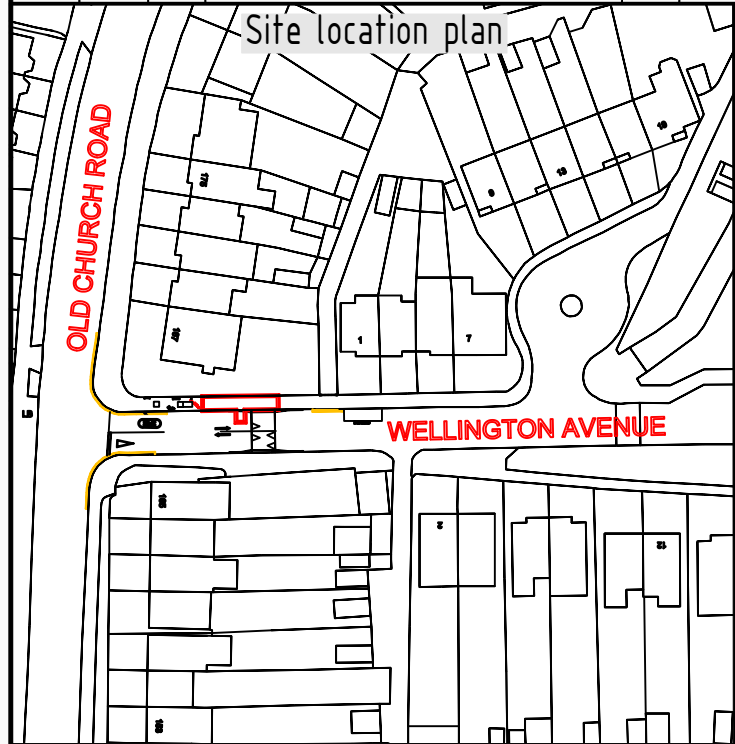

Any modifications to the drawing or use of alternative items to those specified must be agreed with Virgin Media's local planning department

Reproduction from the Ordnance Survey map by Virgin Media with permission of Ordnance Survey on behalf of the Controller of Her Majesty's Stationary Office © Crown Copyright Virgin Media (100019209)

Legend:

- RG6 / RG11 Cable
- EVC Duct
- EV infrastructure boundary
- EVC Parking Bay
- EVC Charge Point
- EVC Feeder Pillar
- Bollard placement
- Build out Island with protection
- Bench
- Barrier
- Existing Drain / Chamber
- Bollard / Sign
- Bin
- Hedge
- Tree & Bush
- Lamp post

Drawing Scale is 1:200 when plotted at A3

Originator:	Arkadiusz Panas	
Company Name:	Quasar	
Issue Date / No.:	12/09/2022	1
Office:	Sheffield	
Line Manager:	Tomasz Polanowicz	
Scale:	1:200	

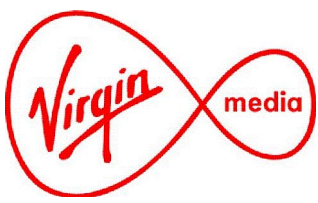

Internal Use Only

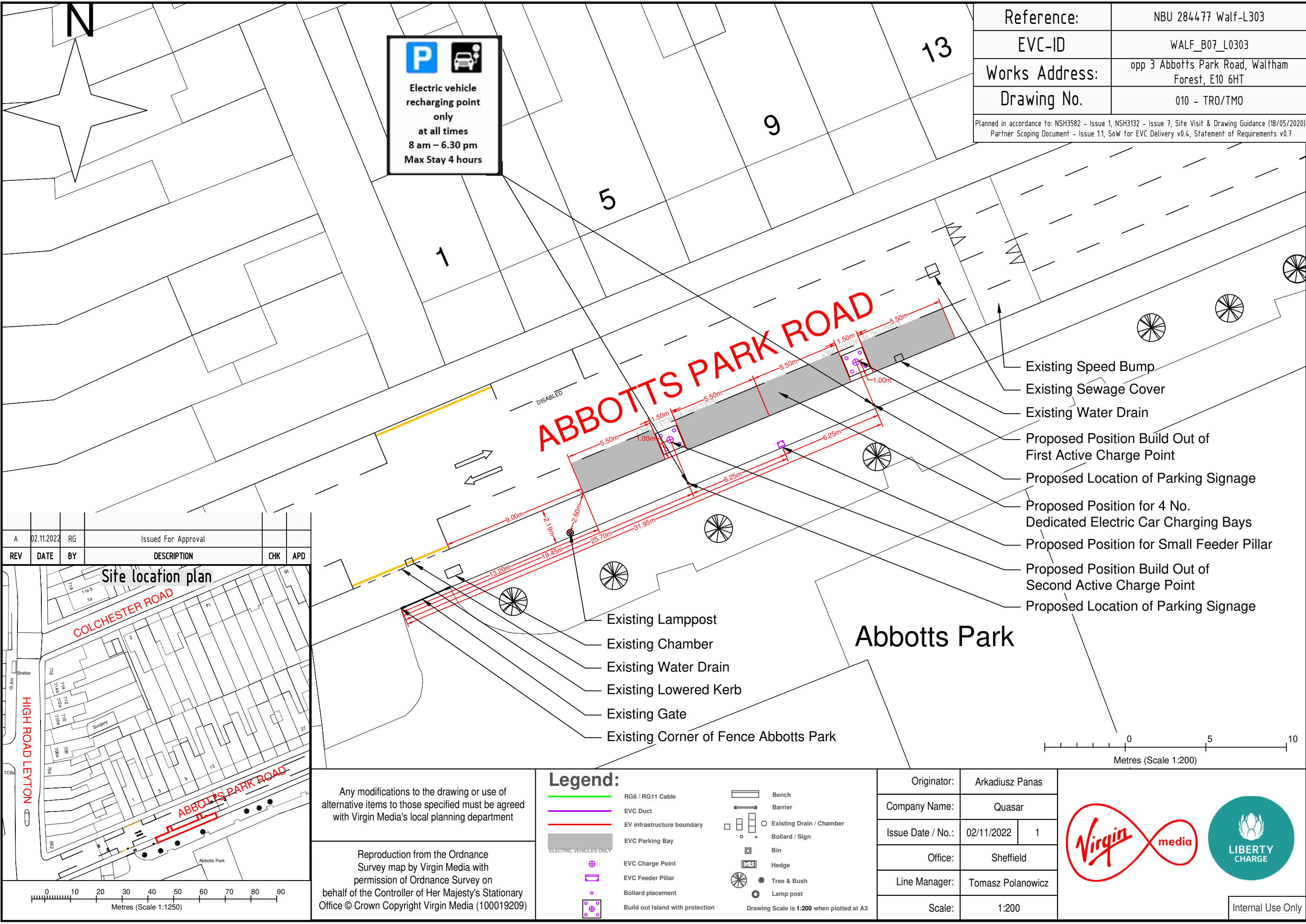

Reference:	NBU 284477 Walf-L303
EVC-ID	WALF_B07_L0303
Works Address:	opp 3 Abbots Park Road, Waltham Forest, E10 6HT
Drawing No.	010 - TR0/TM0
Planned in accordance to: NSH3582 - Issue 1, NSH3132 - Issue 7, Site Visit & Drawing Guidance (18/05/2020) Partner Scoping Document - Issue 1.1, SoW for EVC Delivery v0.4, Statement of Requirements v0.7	

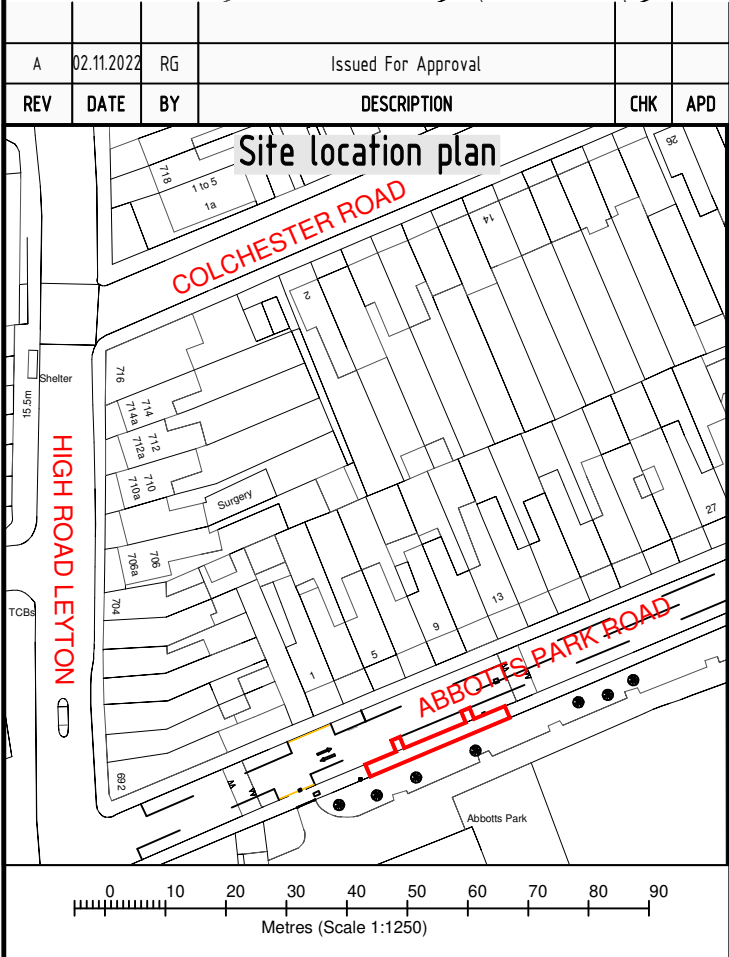

Any modifications to the drawing or use of alternative items to those specified must be agreed with Virgin Media's local planning department

Reproduction from the Ordnance Survey map by Virgin Media with permission of Ordnance Survey on behalf of the Controller of Her Majesty's Stationary Office © Crown Copyright Virgin Media (100019209)

Legend:

- RG6 / RG11 Cable
- EVC Duct
- EV infrastructure boundary
- EVC Parking Bay
- EVC Charge Point
- EVC Feeder Pillar
- Bollard placement
- Build out Island with protection
- Bench
- Barrier
- Existing Drain / Chamber
- Bollard / Sign
- Bin
- Hedge
- Tree & Bush
- Lamp post

Originator:	Arkadiusz Panas
Company Name:	Quasar
Issue Date / No.:	02/11/2022 1
Office:	Sheffield
Line Manager:	Tomasz Polanowicz
Scale:	1:200



Internal Use Only

