

Reference:	NBU 314050 Walf-L364
EVC-ID	WALF_B08_L0364
Works Address:	S/O 1-9 Newton House Prospect Hill, Waltham Forest, London, E17 3ER
Drawing No.	010 - TR0/TM0
Planned in accordance to: NSH3582 - Issue 1, NSH3132 - Issue 7, Site Visit & Drawing Guidance (18/05/2020) Partner Scoping Document - Issue 1.1, SoW for EVC Delivery v0.4, Statement of Requirements v0.7	

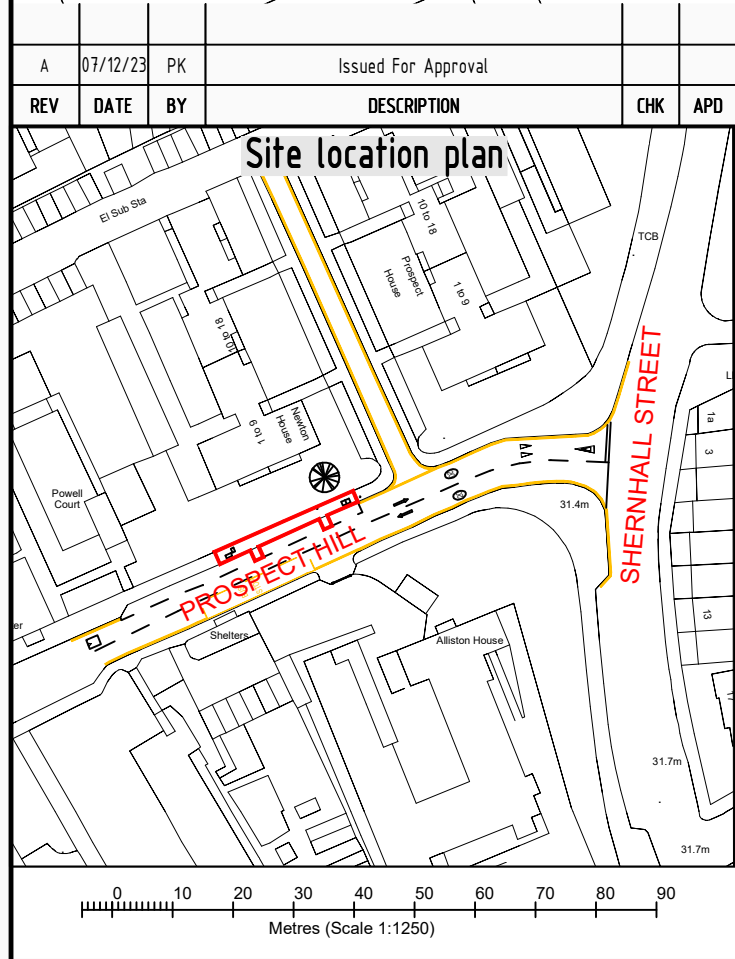

Any modifications to the drawing or use of alternative items to those specified must be agreed with Virgin Media's local planning department

Reproduction from the Ordnance Survey map by Virgin Media with permission of Ordnance Survey on behalf of the Controller of Her Majesty's Stationary Office © Crown Copyright Virgin Media (100019209)

Legend:

	RG6 / RG11 Cable		Existing Drain / Chamber
	EVC Duct		Bollard / Sign
	EV infrastructure boundary		Bin
	EVC Parking Bay		Hedge
	EVC Charge Point		Tree & Bush
	EVC Feeder Pillar		Lamp post
	Bollard placement		
	Build out Island with protection		

Drawing Scale is 1:200 when plotted at A3

Originator:	Arkadiusz Panas	
Company Name:	Quasar	
Issue Date / No.:	07/12/2023	1
Office:	Sheffield	
Line Manager:	Tomasz Polanowicz	
Scale:	1:200	

Internal Use Only

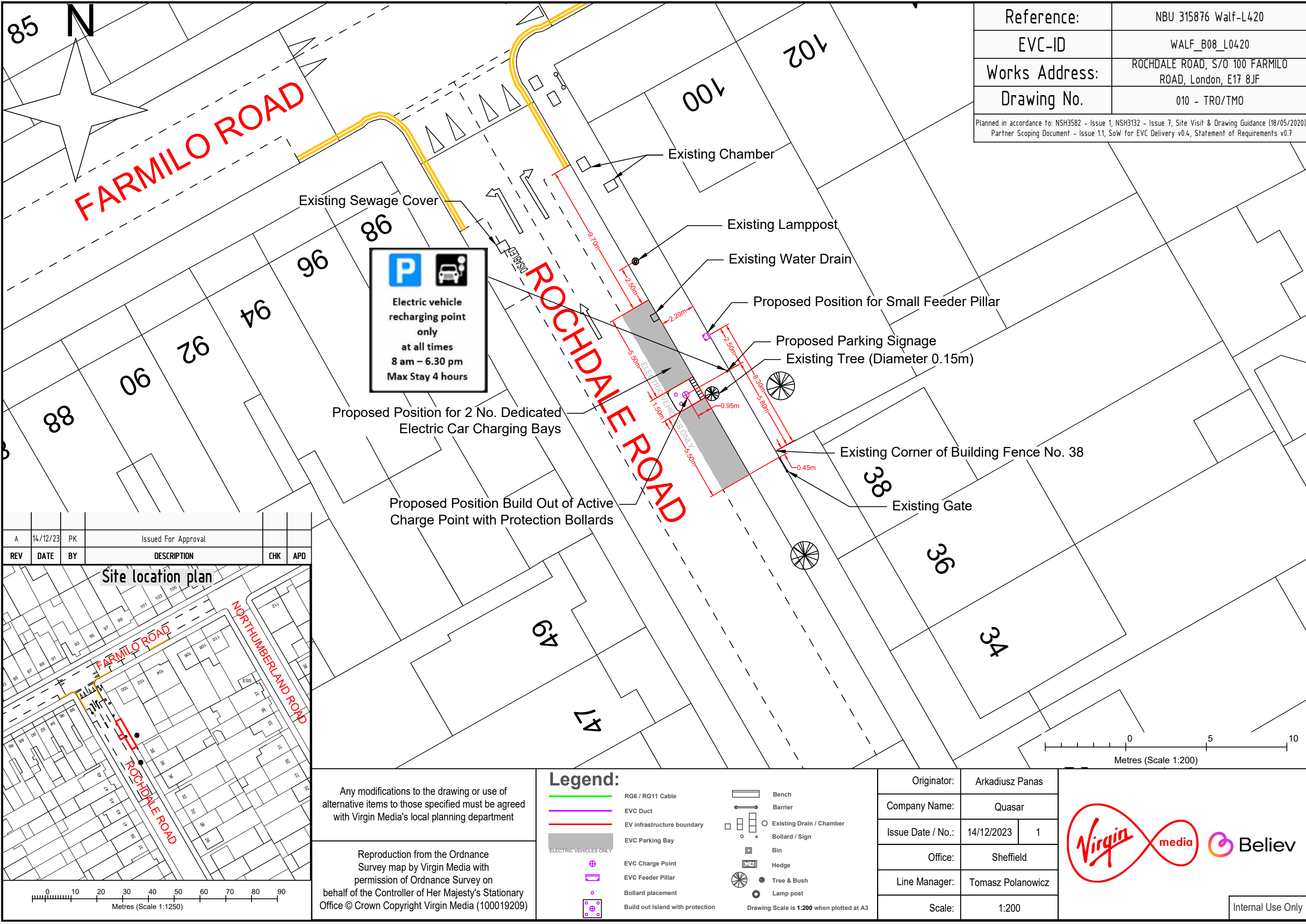

Reference:	NBU 315876 Walf-L420
EVC-ID	WALF_B08_L0420
Works Address:	ROCHDALE ROAD, S/O 100 FARMILO ROAD, London, E17 8JF
Drawing No.	010 - TRO/TMO
Planned in accordance to: NSH3582 - Issue 1, NSH3132 - Issue 7, Site Visit & Drawing Guidance (18/05/2020) Partner Scoping Document - Issue 1.1, SoW for EVC Delivery v0.4, Statement of Requirements v0.7	

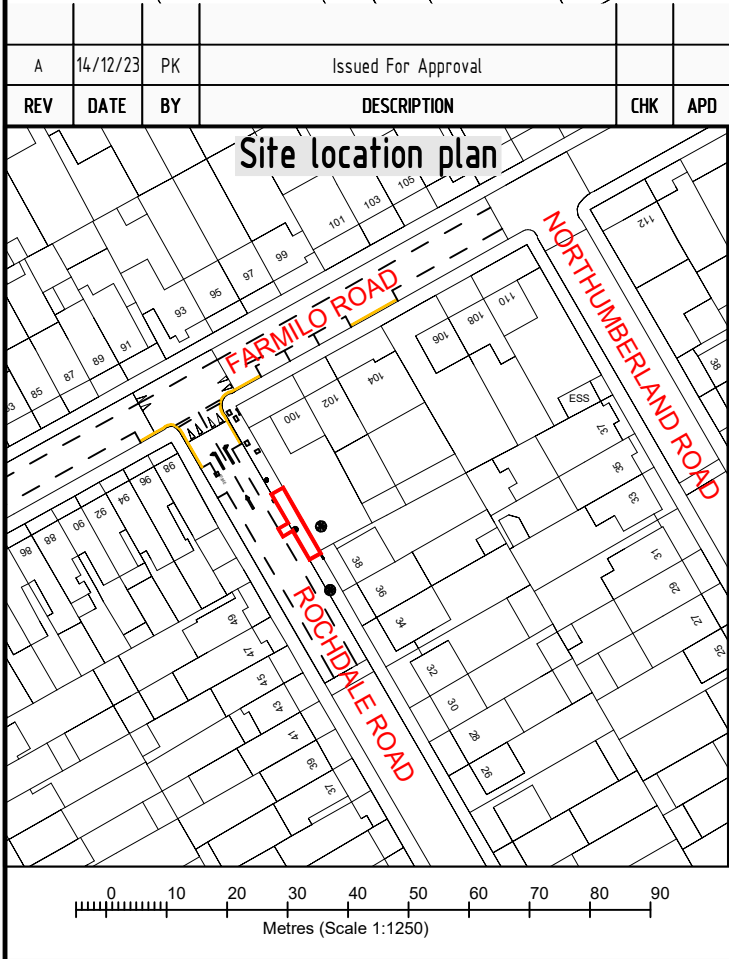

Any modifications to the drawing or use of alternative items to those specified must be agreed with Virgin Media's local planning department

Reproduction from the Ordnance Survey map by Virgin Media with permission of Ordnance Survey on behalf of the Controller of Her Majesty's Stationary Office © Crown Copyright Virgin Media (100019209)

Legend:

- RG6 / RG11 Cable
 - EVC Duct
 - EV infrastructure boundary
 - EVC Parking Bay
 - EVC Charge Point
 - EVC Feeder Pillar
 - Bollard placement
 - Build out Island with protection
 - Bench
 - Barrier
 - Existing Drain / Chamber
 - Bollard / Sign
 - Bin
 - Hedge
 - Tree & Bush
 - Lamp post
- ELECTRIC VEHICLES ONLY
- Drawing Scale is 1:200 when plotted at A3

Originator:	Arkadiusz Panas	
Company Name:	Quasar	
Issue Date / No.:	14/12/2023	1
Office:	Sheffield	
Line Manager:	Tomasz Polanowicz	
Scale:	1:200	

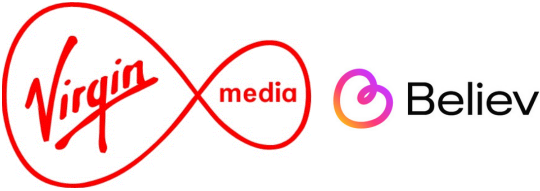

Internal Use Only

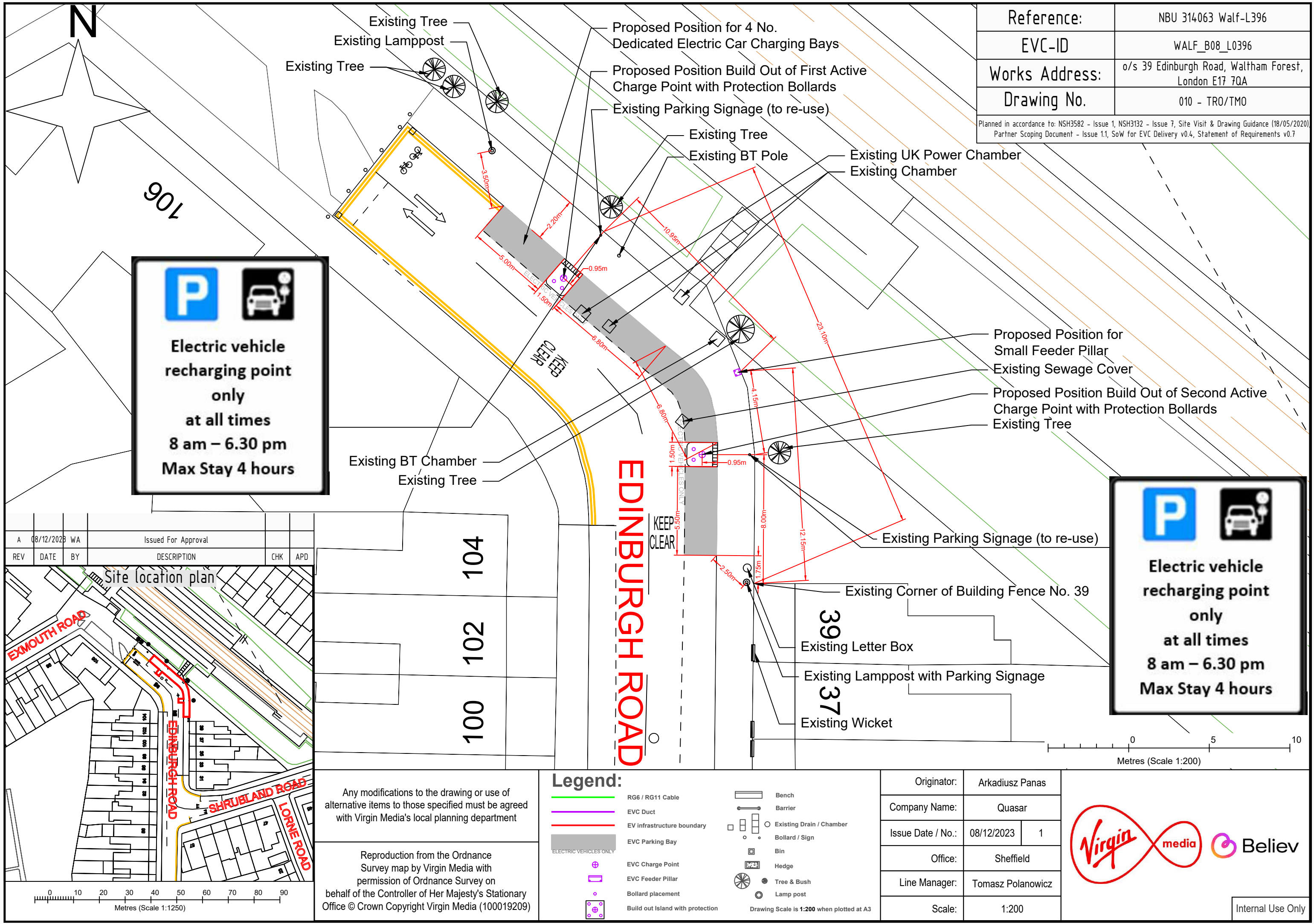

Reference:	NBU 314063 Walf-L396
EVC-ID	WALF_B08_L0396
Works Address:	o/s 39 Edinburgh Road, Waltham Forest, London E17 7QA
Drawing No.	010 - TR0/TMO
Planned in accordance to: NSH3582 - Issue 1, NSH3132 - Issue 7, Site Visit & Drawing Guidance (18/05/2020) Partner Scoping Document - Issue 1.1, SoW for EVC Delivery v0.4, Statement of Requirements v0.7	

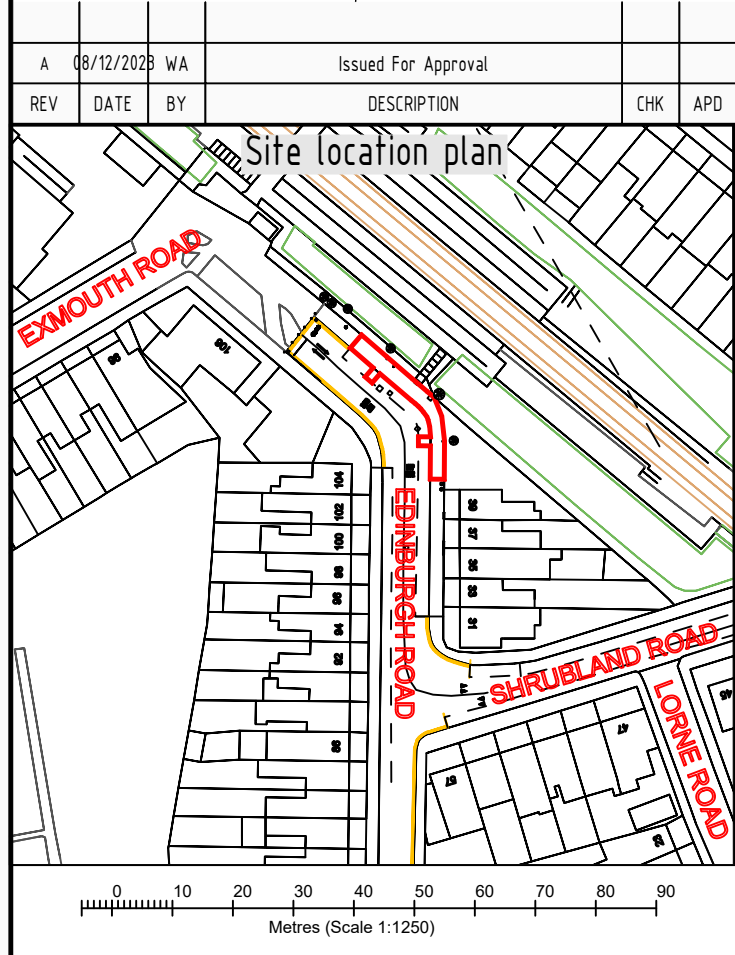

Any modifications to the drawing or use of alternative items to those specified must be agreed with Virgin Media's local planning department

Reproduction from the Ordnance Survey map by Virgin Media with permission of Ordnance Survey on behalf of the Controller of Her Majesty's Stationary Office © Crown Copyright Virgin Media (100019209)

Legend:

	RG6 / RG11 Cable		Bench
	EVC Duct		Barrier
	EV infrastructure boundary		Existing Drain / Chamber
	EVC Parking Bay		Bollard / Sign
	EVC Charge Point		Bin
	EVC Feeder Pillar		Hedge
	Bollard placement		Tree & Bush
	Build out Island with protection		Lamp post

Drawing Scale is 1:200 when plotted at A3

Originator:	Arkadiusz Panas
Company Name:	Quasar
Issue Date / No.:	08/12/2023 1
Office:	Sheffield
Line Manager:	Tomasz Polanowicz
Scale:	1:200

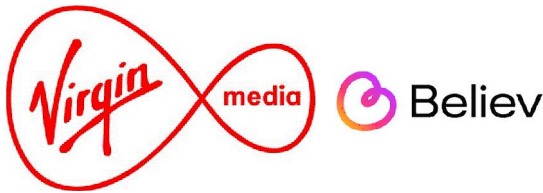

Internal Use Only

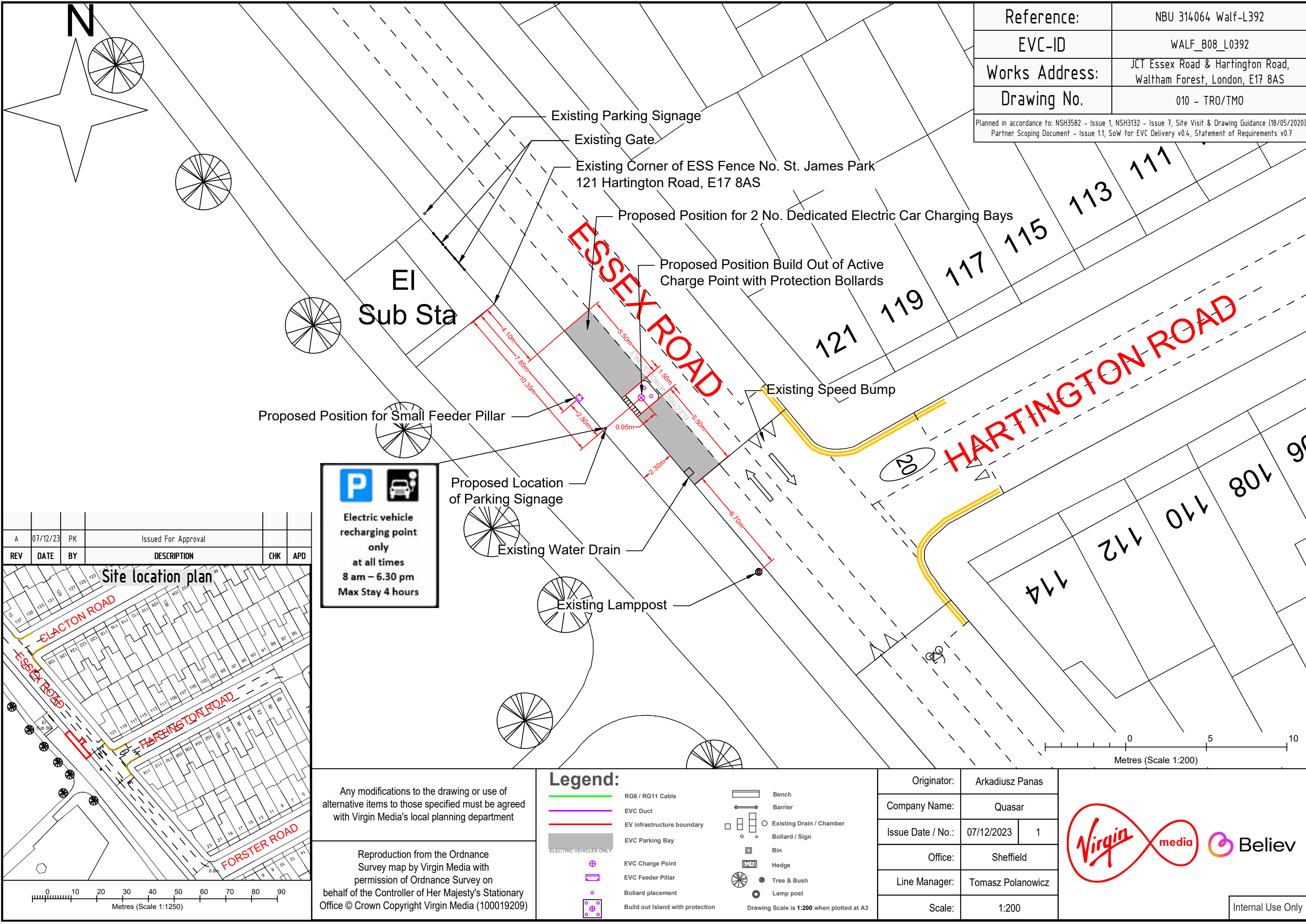

Reference:	NBU 314064 Walf-L392
EVC-ID	WALF_B08_L0392
Works Address:	JCT Essex Road & Hartington Road, Waltham Forest, London, E17 8AS
Drawing No.	010 - TR0/TM0
Planned in accordance to: NSH3582 - Issue 1, NSH3132 - Issue 7, Site Visit & Drawing Guidance (18/05/2020) Partner Scoping Document - Issue 1.1, SoW for EVC Delivery v0.4, Statement of Requirements v0.7	

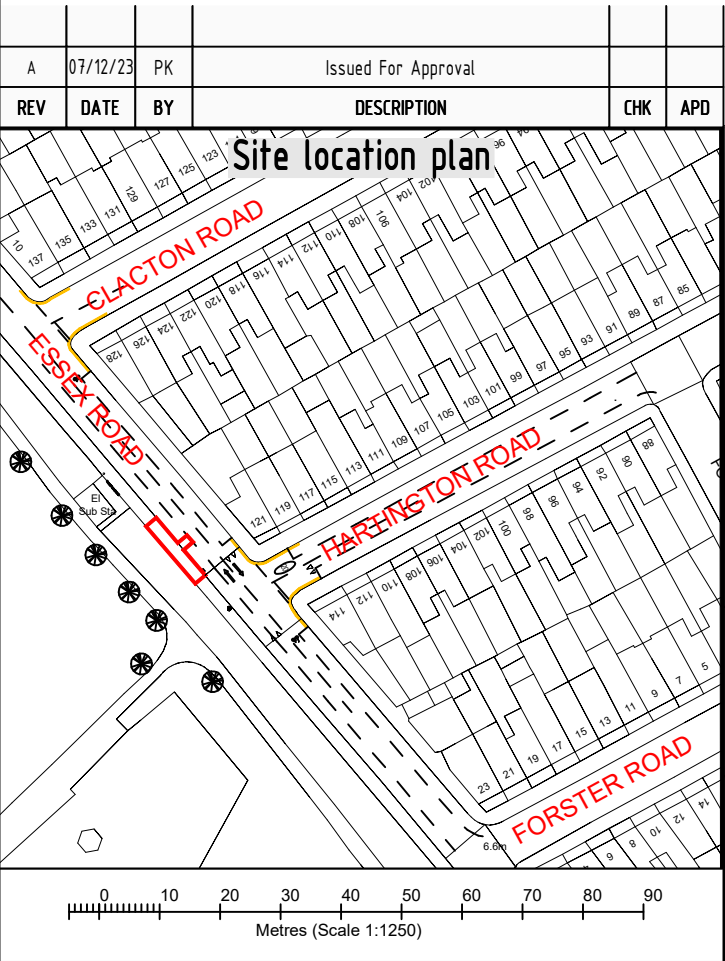

Electric vehicle
recharging point
only
at all times
8 am – 6.30 pm
Max Stay 4 hours

Any modifications to the drawing or use of alternative items to those specified must be agreed with Virgin Media's local planning department

Reproduction from the Ordnance Survey map by Virgin Media with permission of Ordnance Survey on behalf of the Controller of Her Majesty's Stationary Office © Crown Copyright Virgin Media (100019209)

Legend:

- RG6 / RG11 Cable
- EVC Duct
- EV infrastructure boundary
- EVC Parking Bay
- EVC Charge Point
- EVC Feeder Pillar
- Bollard placement
- Build out Island with protection

ELECTRIC VEHICLES ONLY

- Bench
- Barrier
- Existing Drain / Chamber
- Bollard / Sign
- Bin
- Hedge
- Tree & Bush
- Lamp post

Drawing Scale is 1:200 when plotted at A3

Originator:	Arkadiusz Panas	
Company Name:	Quasar	
Issue Date / No.:	07/12/2023	1
Office:	Sheffield	
Line Manager:	Tomasz Polanowicz	
Scale:	1:200	

Internal Use Only

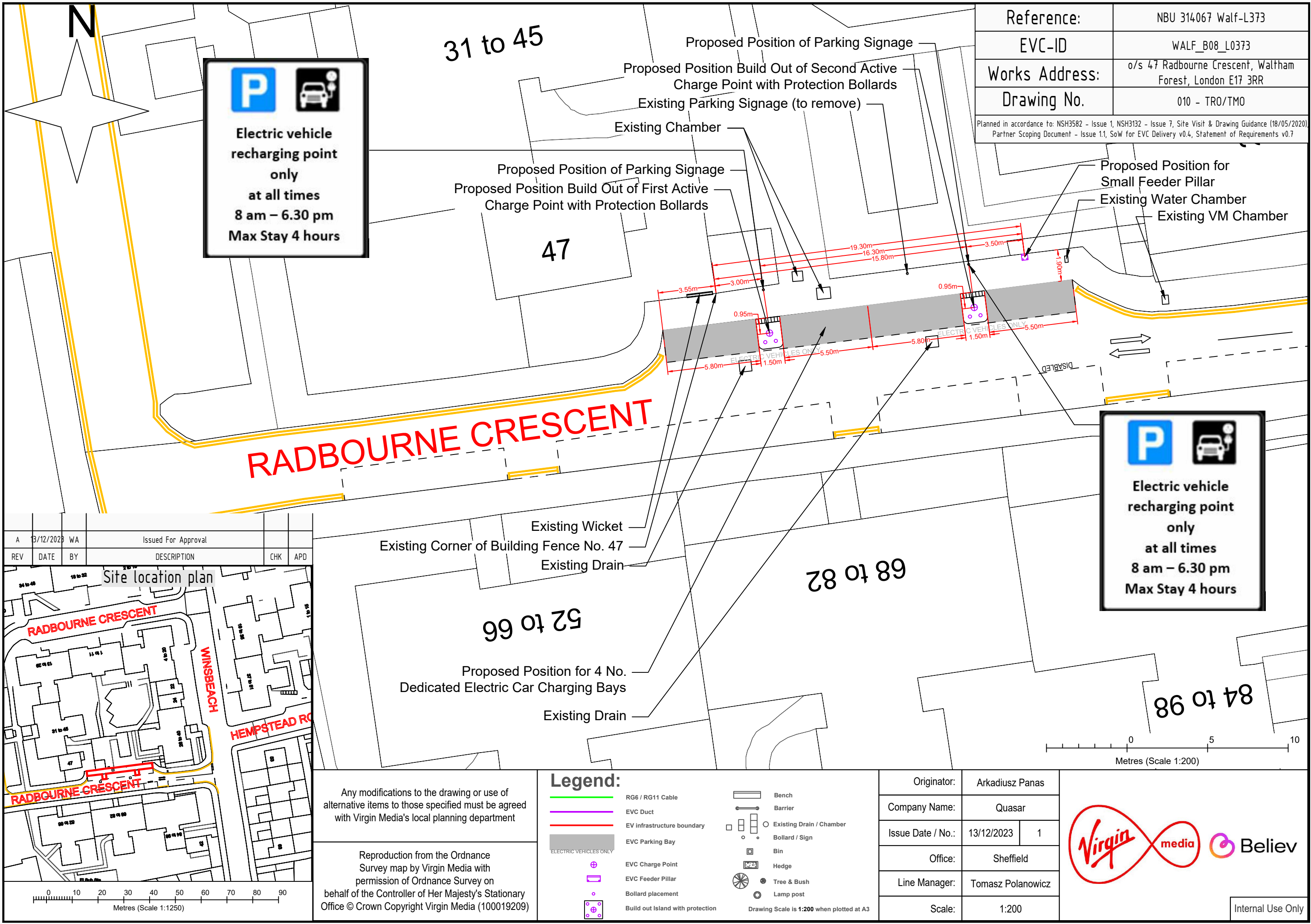

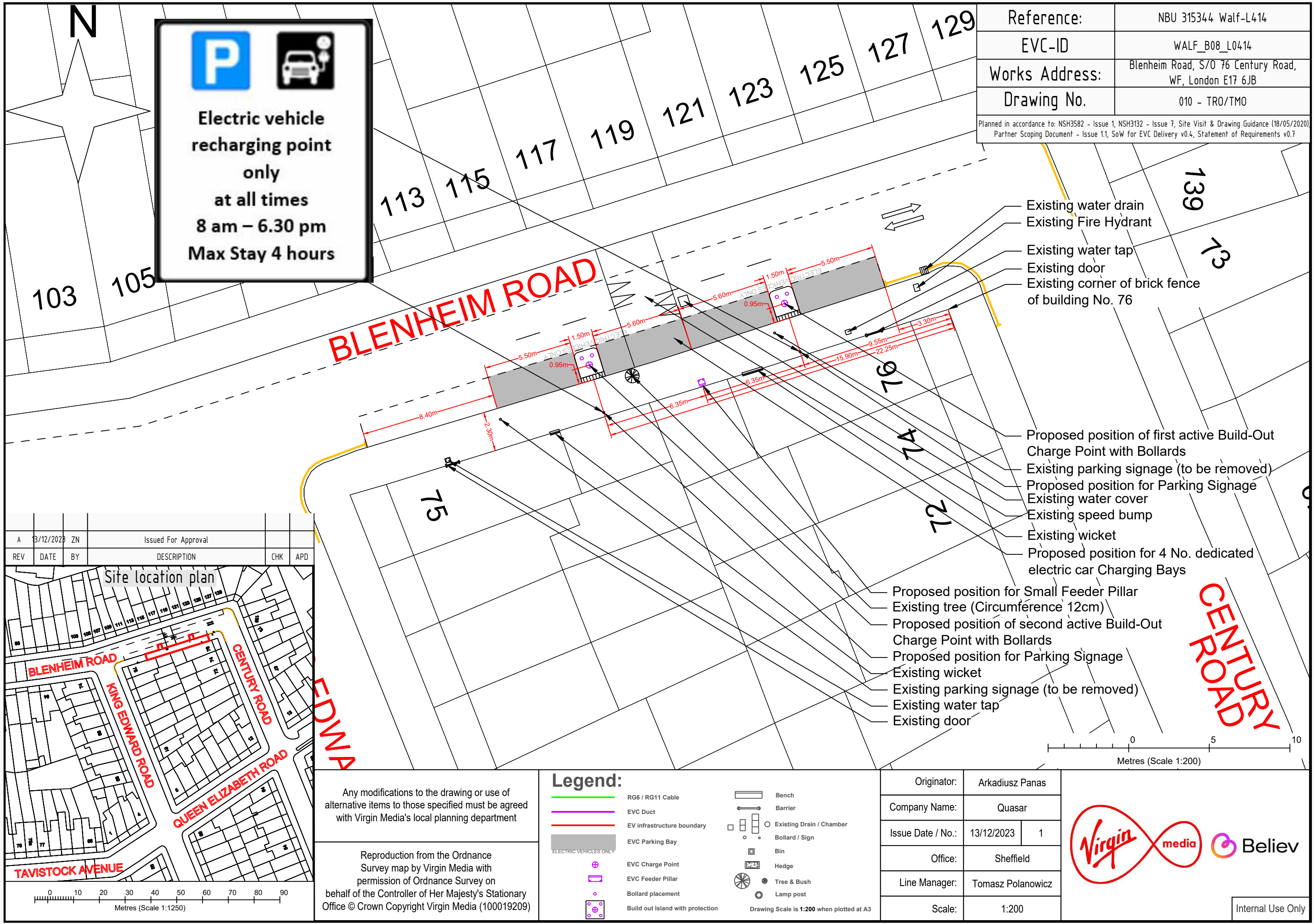

Reference:	NBU 315344 Walf-L414
EVC-ID	WALF_B08_L0414
Works Address:	Blenheim Road, S/O 76 Century Road, WF, London E17 6JB
Drawing No.	010 - TR0/TMO
Planned in accordance to: NSH3582 - Issue 1, NSH3132 - Issue 7, Site Visit & Drawing Guidance (18/05/2020) Partner Scoping Document - Issue 1.1, SoW for EVC Delivery v0.4, Statement of Requirements v0.7	

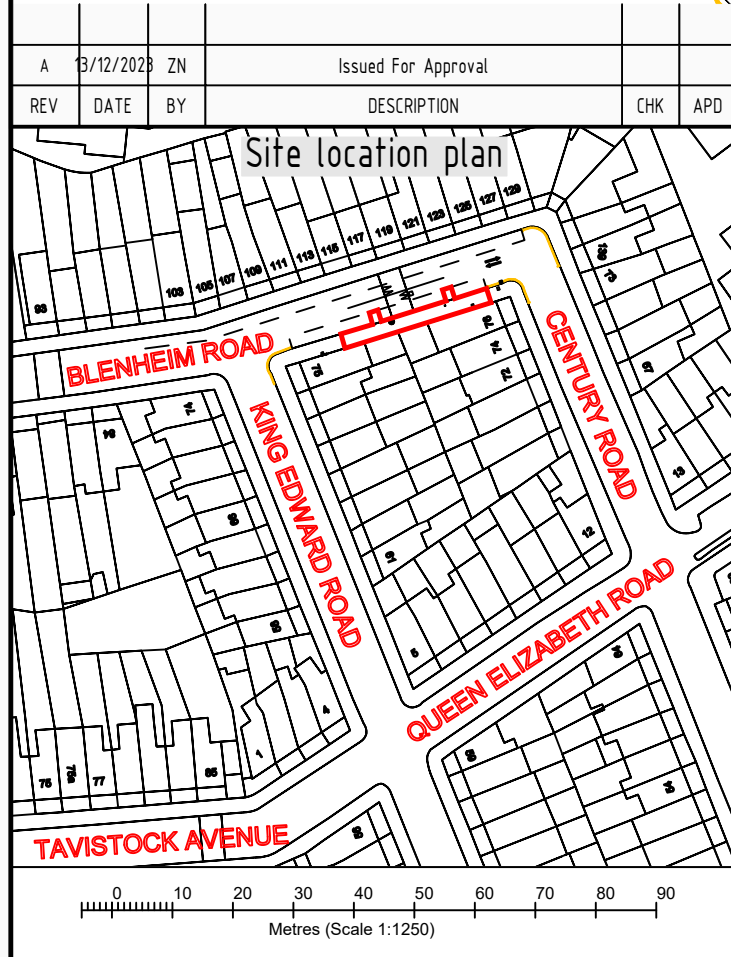

Any modifications to the drawing or use of alternative items to those specified must be agreed with Virgin Media's local planning department

Reproduction from the Ordnance Survey map by Virgin Media with permission of Ordnance Survey on behalf of the Controller of Her Majesty's Stationary Office © Crown Copyright Virgin Media (100019209)

Legend:

- RG6 / RG11 Cable
- EVC Duct
- EV infrastructure boundary
- EVC Parking Bay
- EVC Charge Point
- EVC Feeder Pillar
- Bollard placement
- Build out Island with protection
- Bench
- Barrier
- Existing Drain / Chamber
- Bollard / Sign
- Bin
- Hedge
- Tree & Bush
- Lamp post

Drawing Scale is 1:200 when plotted at A3

Originator:	Arkadiusz Panas
Company Name:	Quasar
Issue Date / No.:	13/12/2023 1
Office:	Sheffield
Line Manager:	Tomasz Polanowicz
Scale:	1:200

Virgin media Believ

Internal Use Only

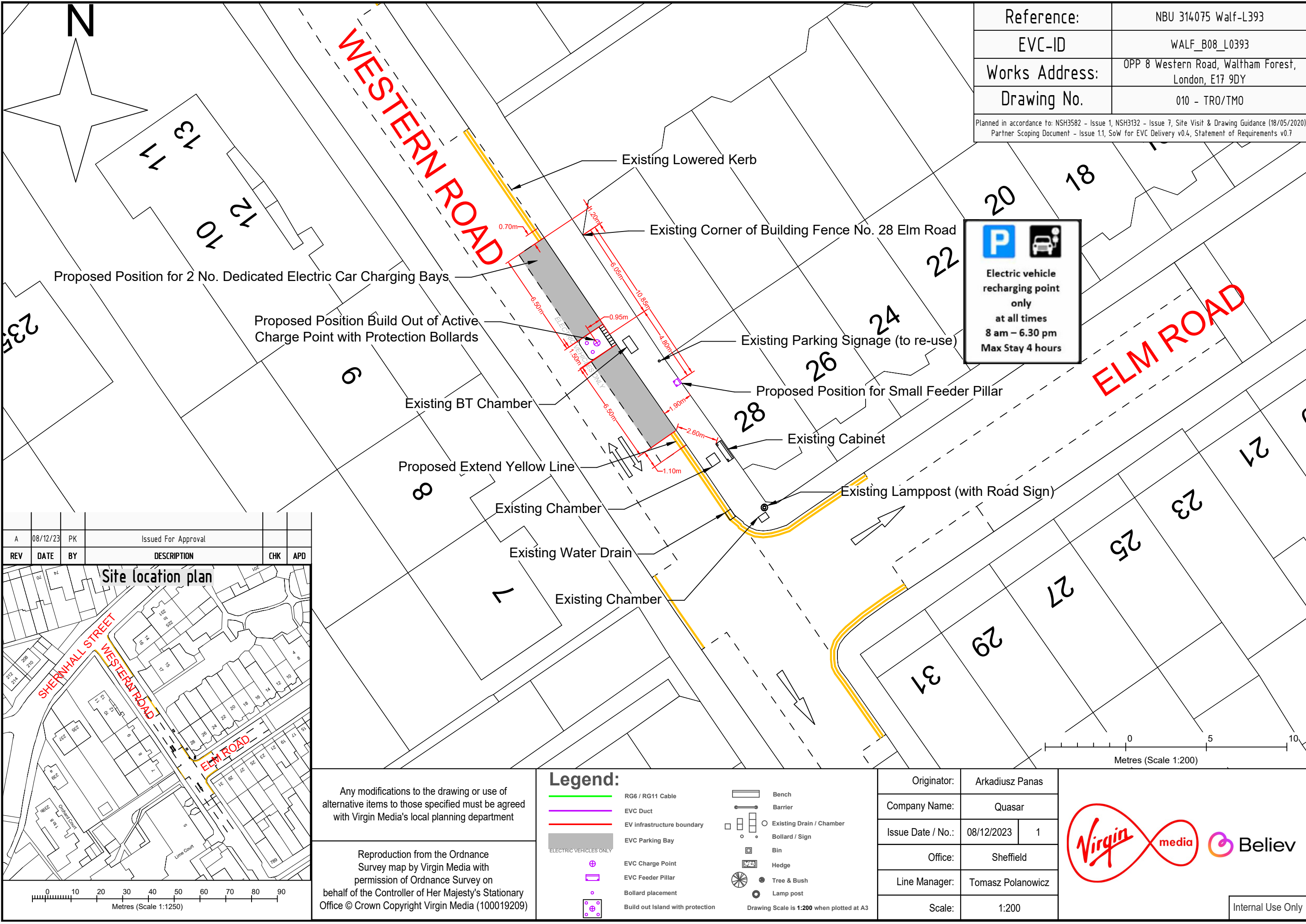

Reference:	NBU 314075 Walf-L393
EVC-ID	WALF_B08_L0393
Works Address:	OPP 8 Western Road, Waltham Forest, London, E17 9DY
Drawing No.	010 - TR0/TM0
Planned in accordance to: NSH3582 - Issue 1, NSH3132 - Issue 7, Site Visit & Drawing Guidance (18/05/2020) Partner Scoping Document - Issue 1.1, SoW for EVC Delivery v0.4, Statement of Requirements v0.7	

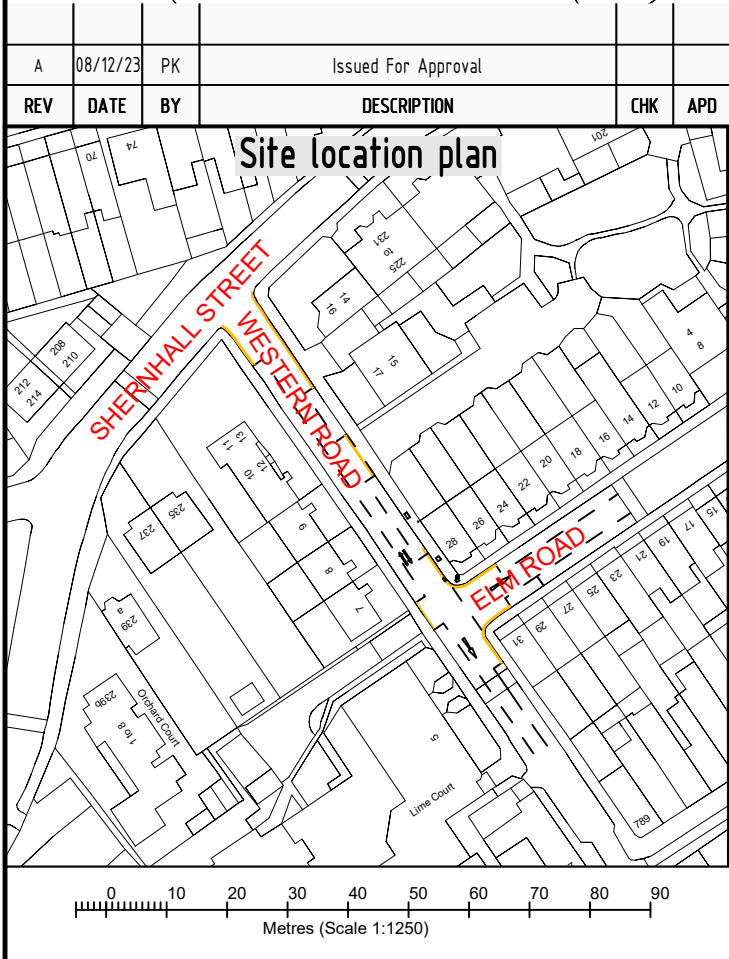

Any modifications to the drawing or use of alternative items to those specified must be agreed with Virgin Media's local planning department

Reproduction from the Ordnance Survey map by Virgin Media with permission of Ordnance Survey on behalf of the Controller of Her Majesty's Stationary Office © Crown Copyright Virgin Media (100019209)

Legend:

- RG6 / RG11 Cable

EVC Duct

EV infrastructure boundary

EVC Parking Bay

ELECTRIC VEHICLES ONLY

EVC Charge Point

EVC Feeder Pillar

Bollard placement

Build out Island with protection
- Bench

Barrier

Existing Drain / Chamber

Bollard / Sign

Bin

Hedge

Tree & Bush

Lamp post

Drawing Scale is 1:200 when plotted at A3

Originator:	Arkadiusz Panas	
Company Name:	Quasar	
Issue Date / No.:	08/12/2023	1
Office:	Sheffield	
Line Manager:	Tomasz Polanowicz	
Scale:	1:200	

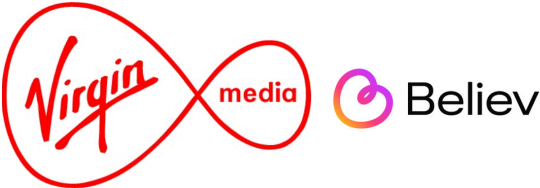

Internal Use Only

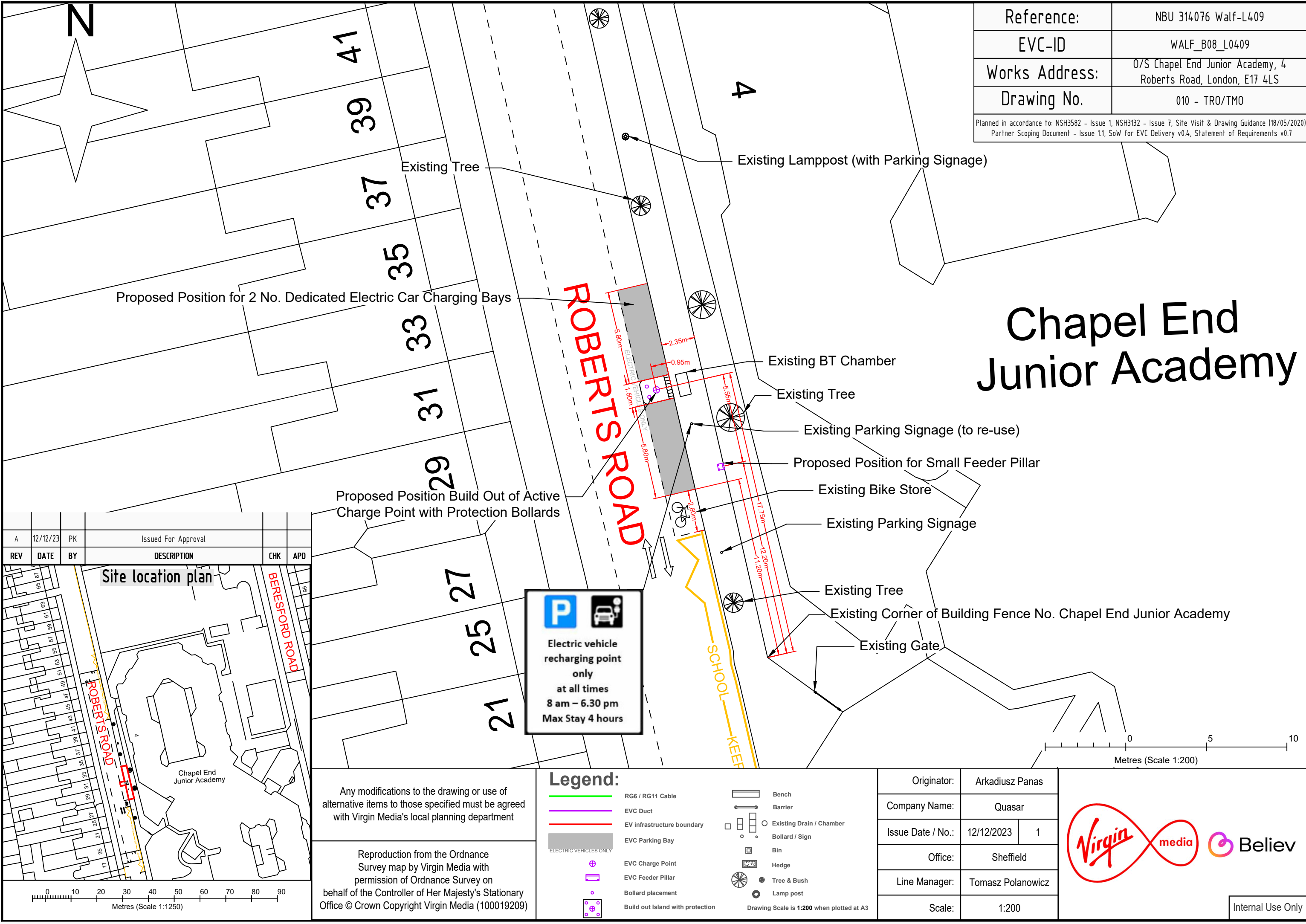

Reference:	NBU 314076 Walf-L409
EVC-ID	WALF_B08_L0409
Works Address:	0/S Chapel End Junior Academy, 4 Roberts Road, London, E17 4LS
Drawing No.	010 - TR0/TM0

Planned in accordance to: NSH3582 - Issue 1, NSH3132 - Issue 7, Site Visit & Drawing Guidance (18/05/2020)
Partner Scoping Document - Issue 1.1, SoW for EVC Delivery v0.4, Statement of Requirements v0.7

Chapel End Junior Academy

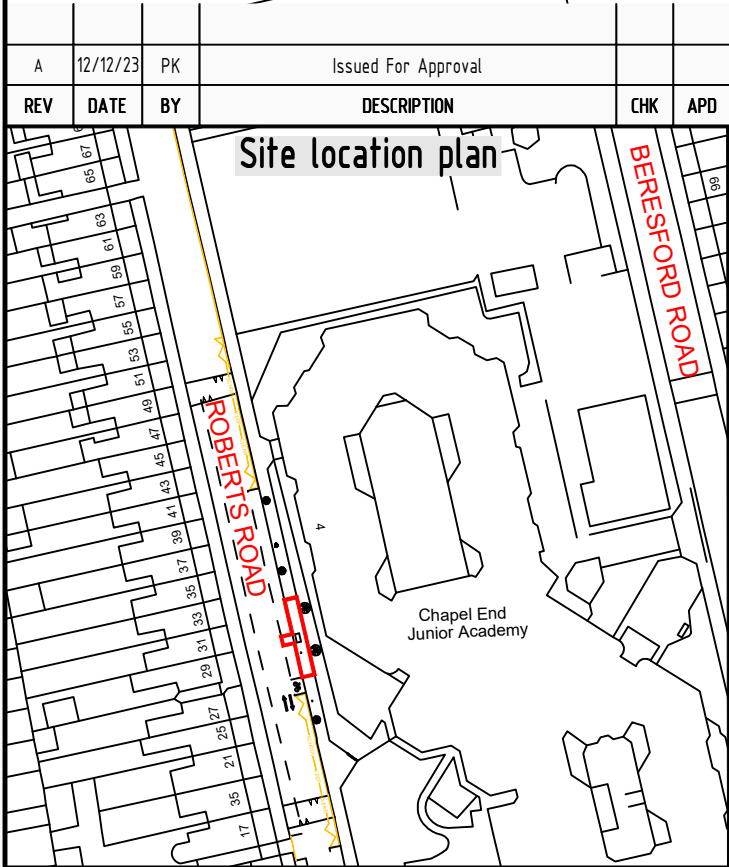

A	12/12/23	PK	Issued For Approval		
REV	DATE	BY	DESCRIPTION	CHK	APD

Electric vehicle
recharging point
only
at all times
8 am – 6.30 pm
Max Stay 4 hours

Any modifications to the drawing or use of alternative items to those specified must be agreed with Virgin Media's local planning department

Reproduction from the Ordnance Survey map by Virgin Media with permission of Ordnance Survey on behalf of the Controller of Her Majesty's Stationary Office © Crown Copyright Virgin Media (100019209)

Legend:

- RG6 / RG11 Cable

EVC Duct

EV infrastructure boundary

EVC Parking Bay

EVC Charge Point

EVC Feeder Pillar

Bollard placement

Build out Island with protection
- Bench

Barrier

Existing Drain / Chamber

Bollard / Sign

Bin

Hedge

Tree & Bush

Lamp post

Drawing Scale is 1:200 when plotted at A3

Originator:	Arkadiusz Panas
Company Name:	Quasar
Issue Date / No.:	12/12/20231
Office:	Sheffield
Line Manager:	Tomasz Polanowicz
Scale:	1:200

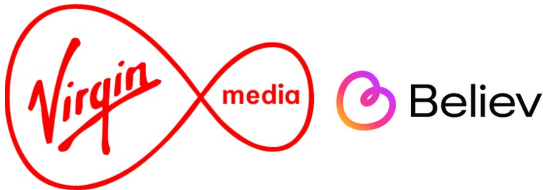

Internal Use Only

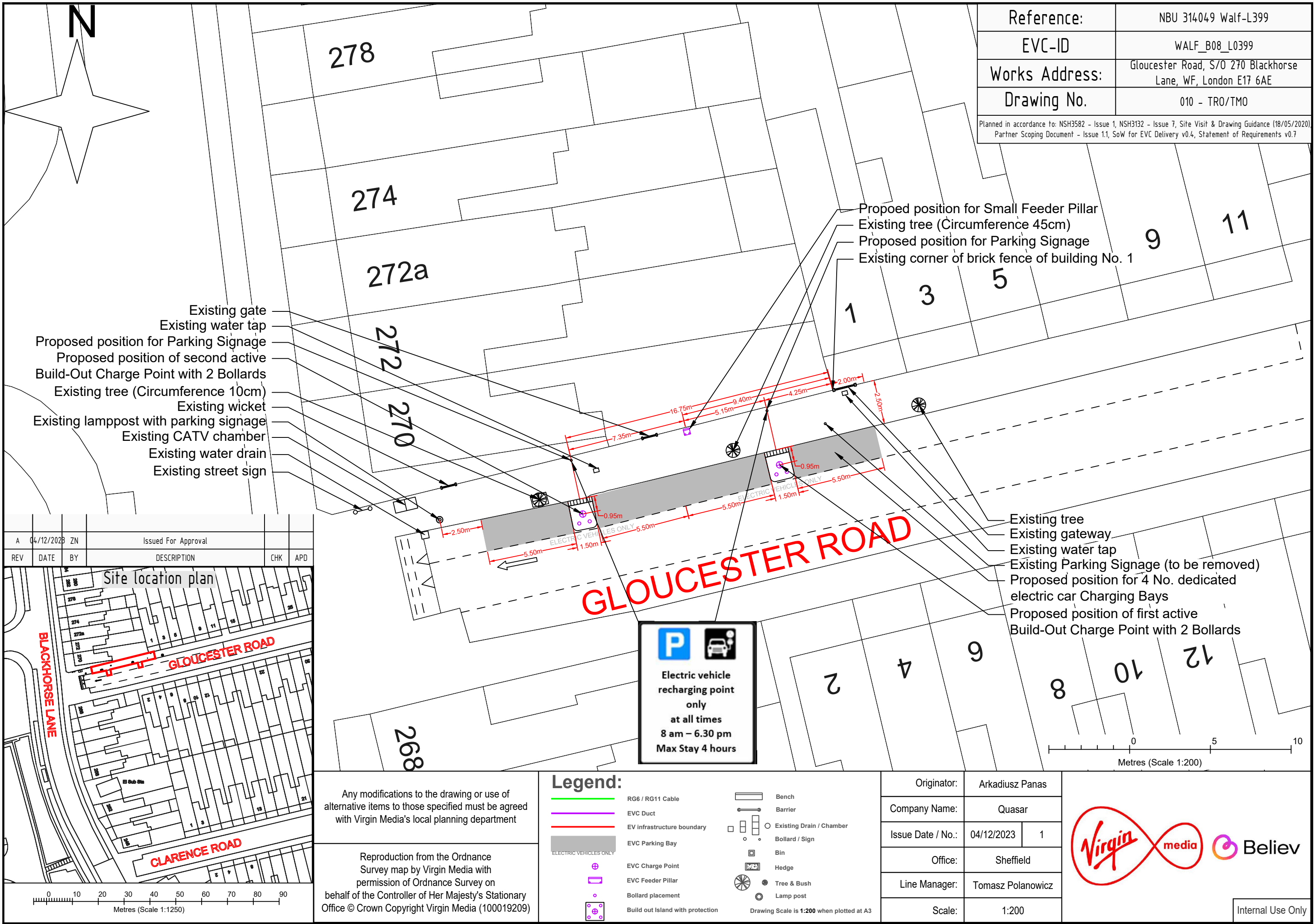

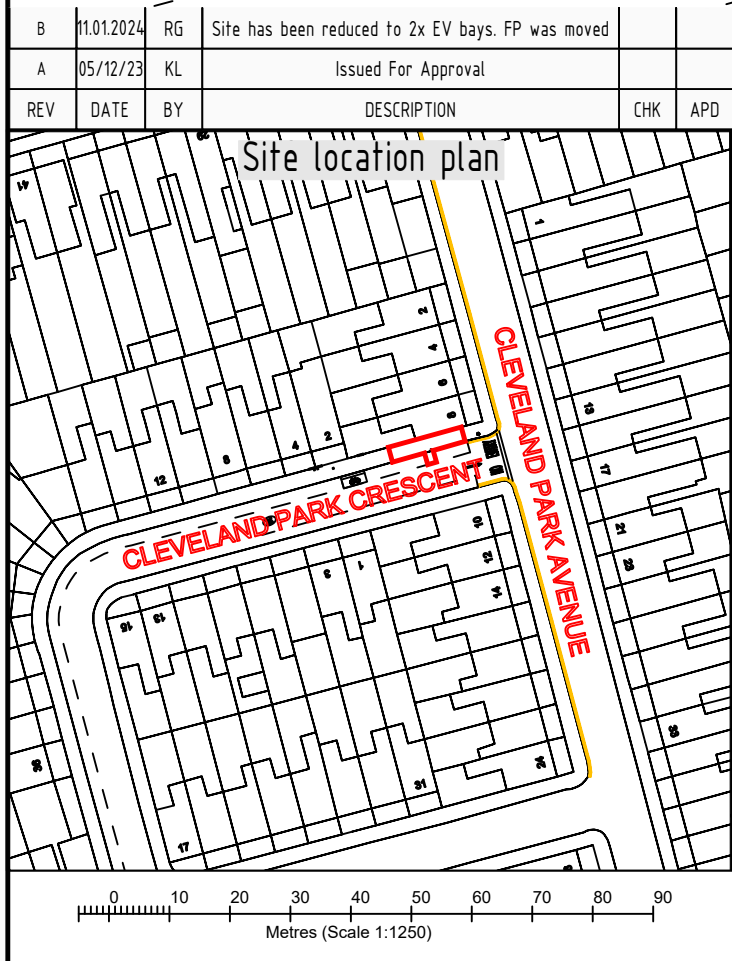
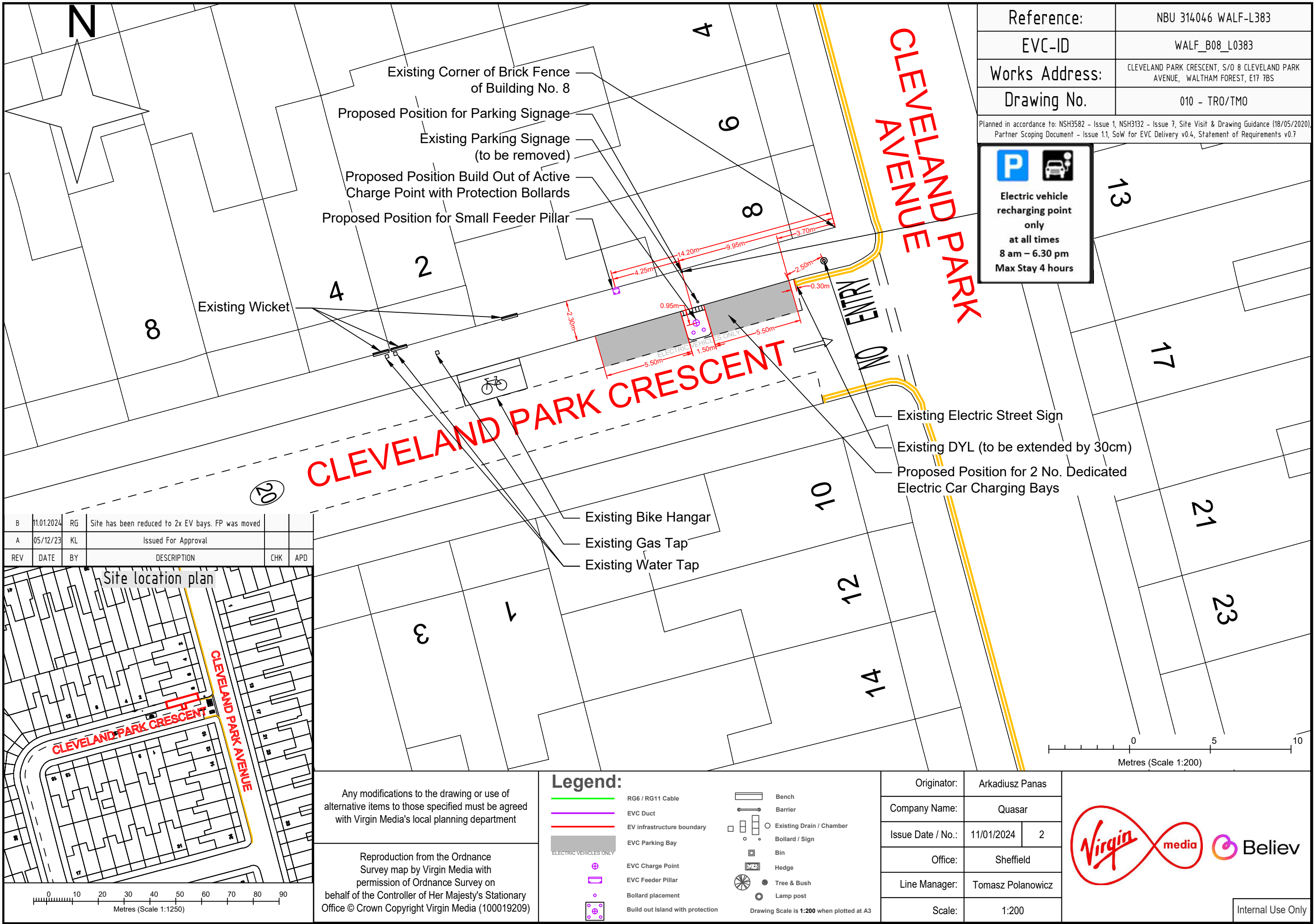

Any modifications to the drawing or use of alternative items to those specified must be agreed with Virgin Media's local planning department



Reproduction from the Ordnance Survey map by Virgin Media with permission of Ordnance Survey on behalf of the Controller of Her Majesty's Stationary Office © Crown Copyright Virgin Media (100019209)

Legend:

- RG6 / RG11 Cable
- EVC Duct
- EV infrastructure boundary
- EVC Parking Bay
- EVC Charge Point
- EVC Feeder Pillar
- Bollard placement
- Build out Island with protection
- Bench
- Barrier
- Existing Drain / Chamber
- Bollard / Sign
- Bin
- Hedge
- Tree & Bush
- Lamp post

Drawing Scale is 1:200 when plotted at A3

Originator:	Arkadiusz Panas	
Company Name:	Quasar	
Issue Date / No.:	11/01/2024	2
Office:	Sheffield	
Line Manager:	Tomasz Polanowicz	
Scale:	1:200	



Internal Use Only