

Drawn By	FS
Drawing No.	WA-MF-23-18
Date	04/08/23
Scale	1:250 @ A4

## Winns Area Modal Filter Thorpe Crescent

Notes

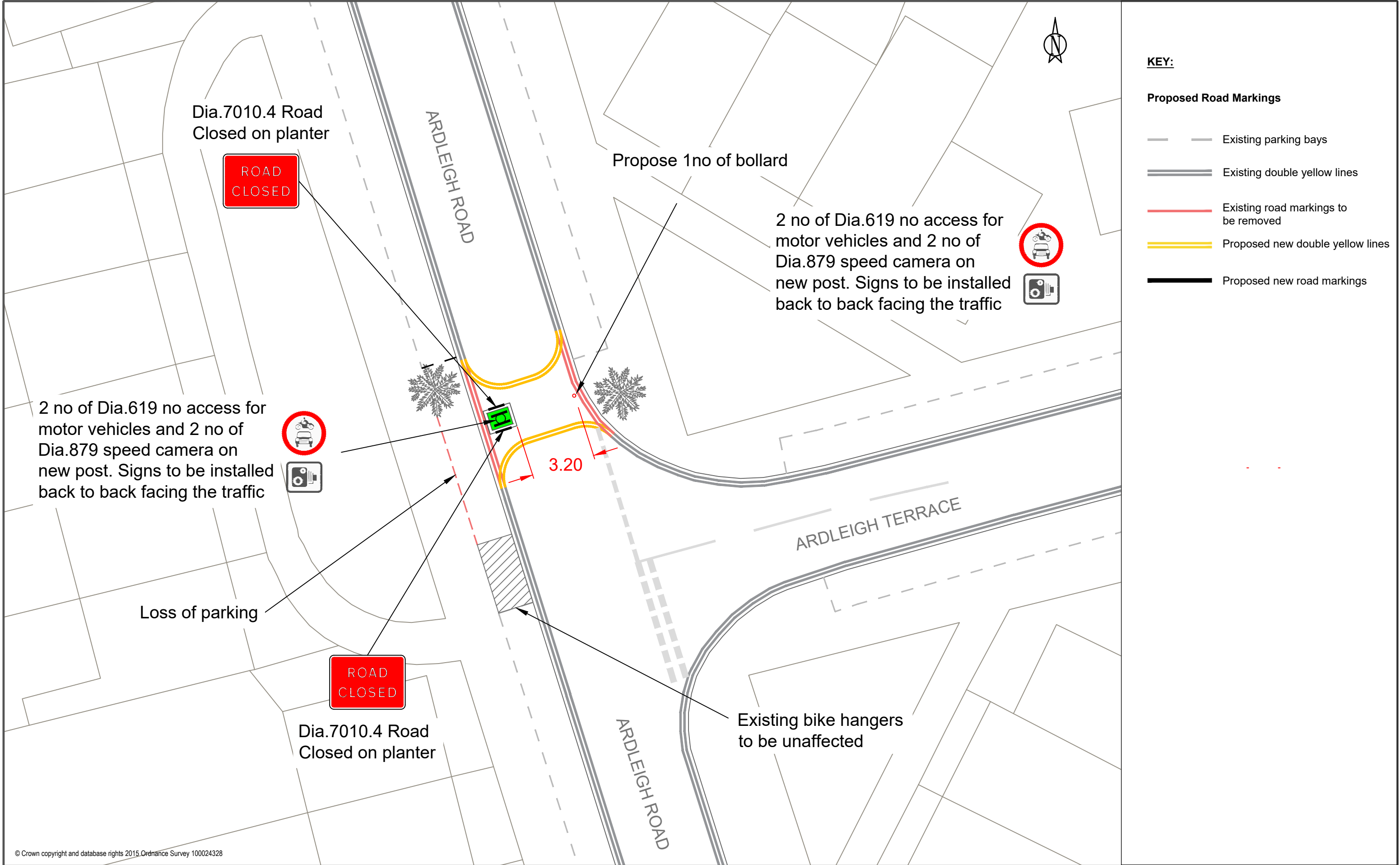



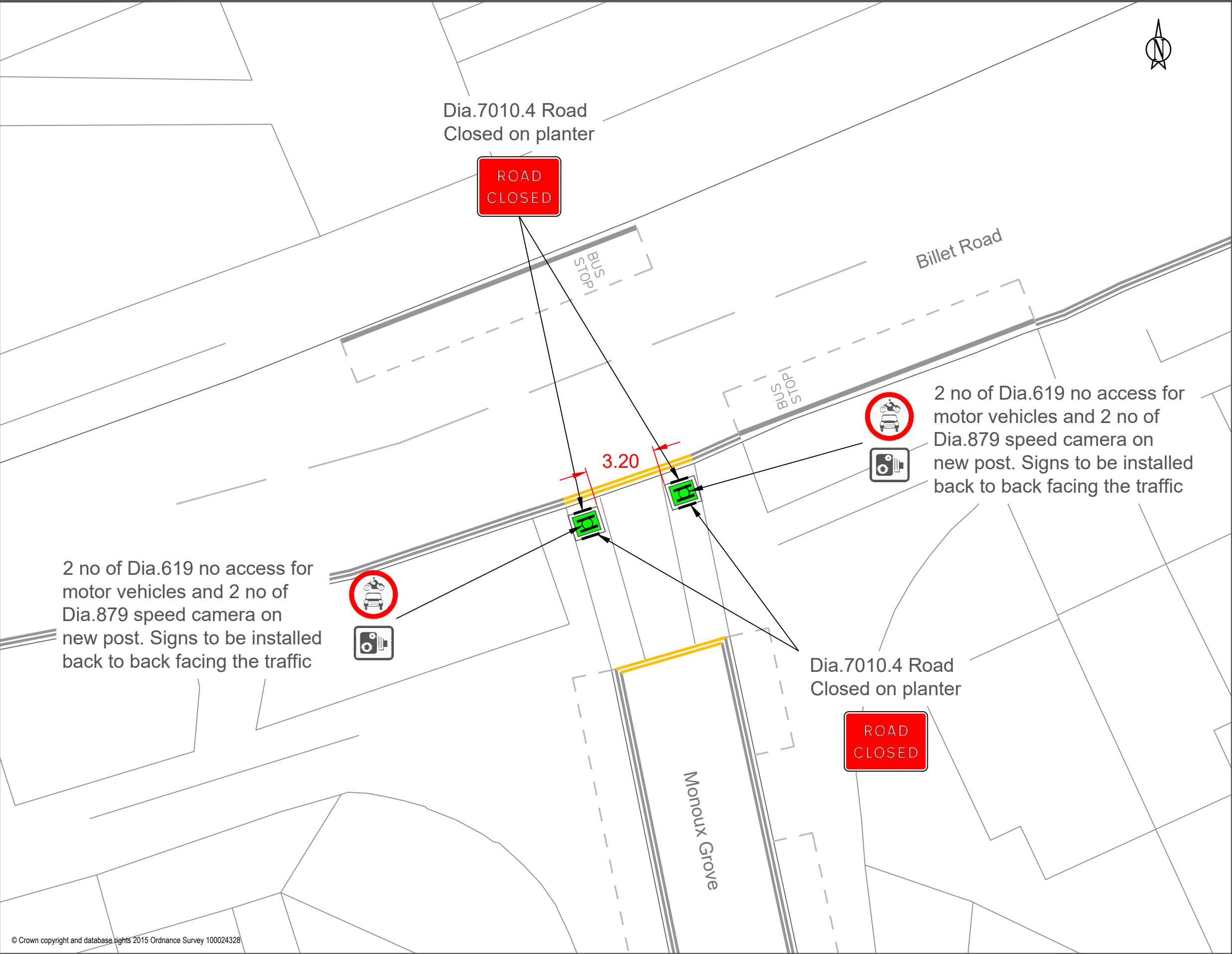

**KEY:**

**Proposed Road Markings**

- Existing parking bays
- Existing double yellow lines
- Existing road markings to be removed
- Proposed new double yellow lines
- Proposed new road markings

© Crown copyright and database rights 2015 Ordnance Survey 100024328

Drawn By	SF
Drawing No.	WA-MF-23-20
Date	07/08/23
Scale	1:250 @ A4

Title

**Winns Area Modal Filter**

**Monoux Grove**

Notes









# NOTES

Based upon the Ordnance Survey mapping with the permission of the controller of Her Majesty Stationary Office - Crown copyright. Unauthorised reproduction may lead to prosecution or civil proceedings. L.B. Newham LA086517 1997.

## NOTES:

Oak Timber Sleeper 100mm x 200mm x 2400mm by Travis Perkins pr similar approved. Cut to suit, remove and smooth rough edges.

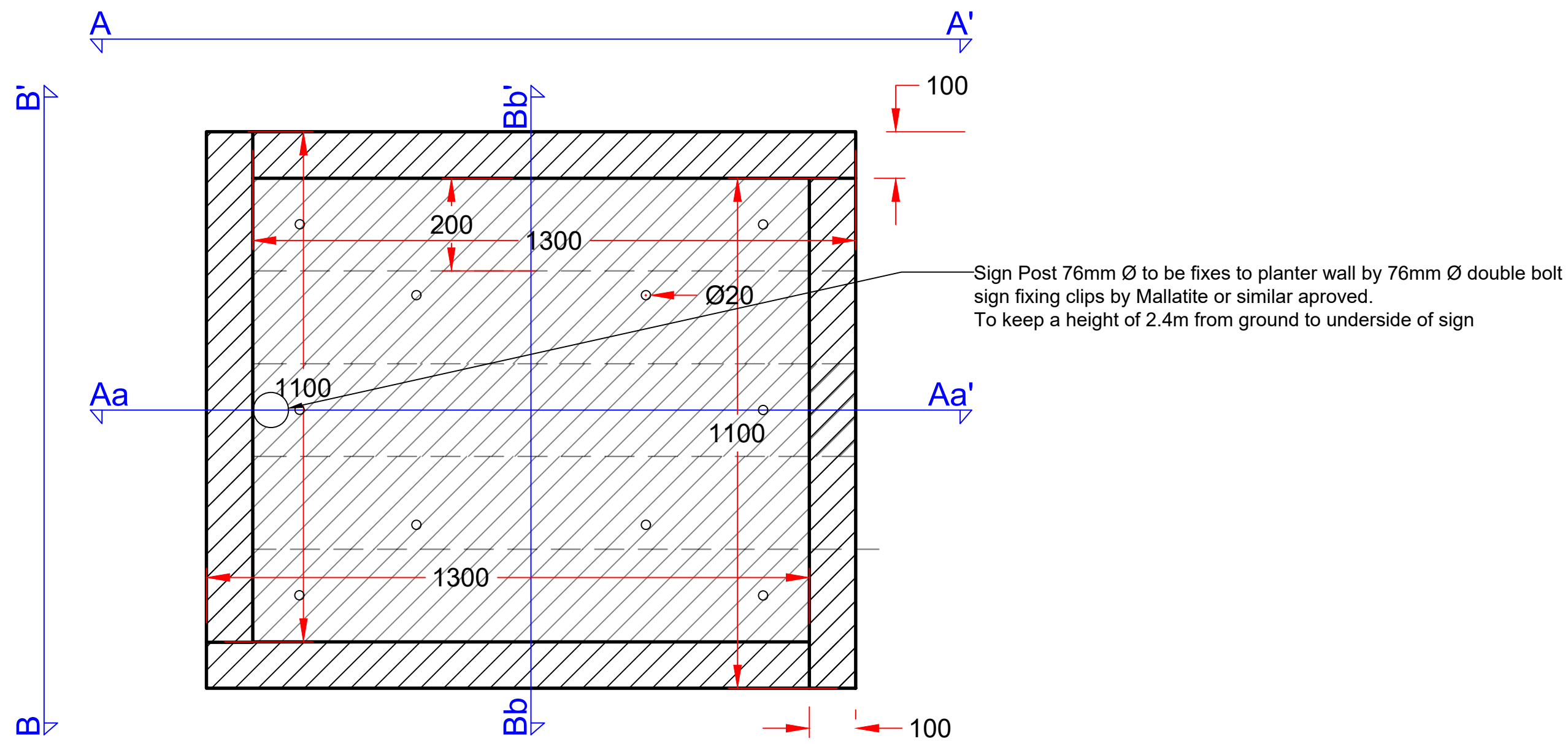

01 PLAN VIEW FROM ABOVE  
Planter  
1:10

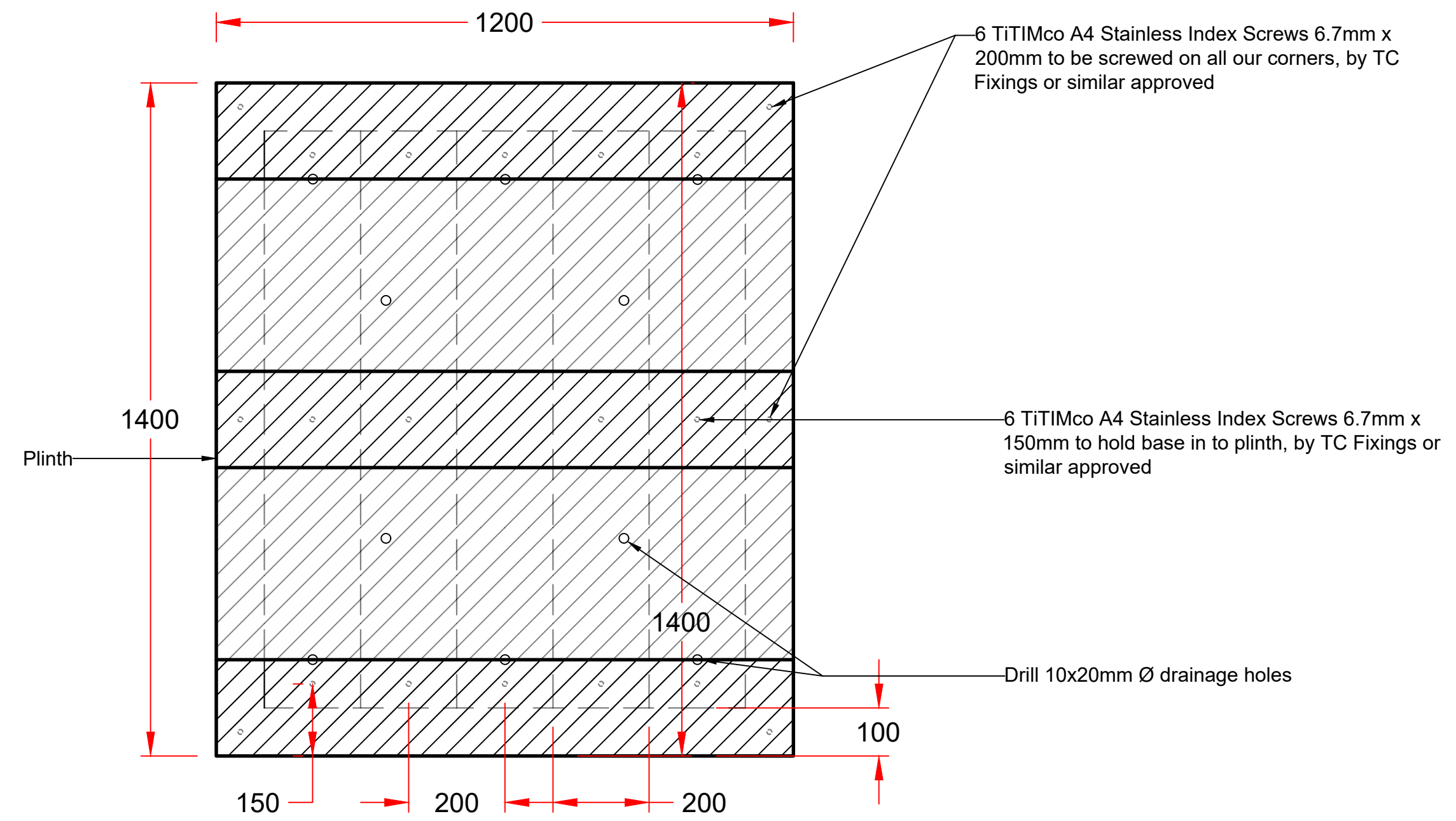

02 VIEW FROM BELOW  
Planter  
1:10

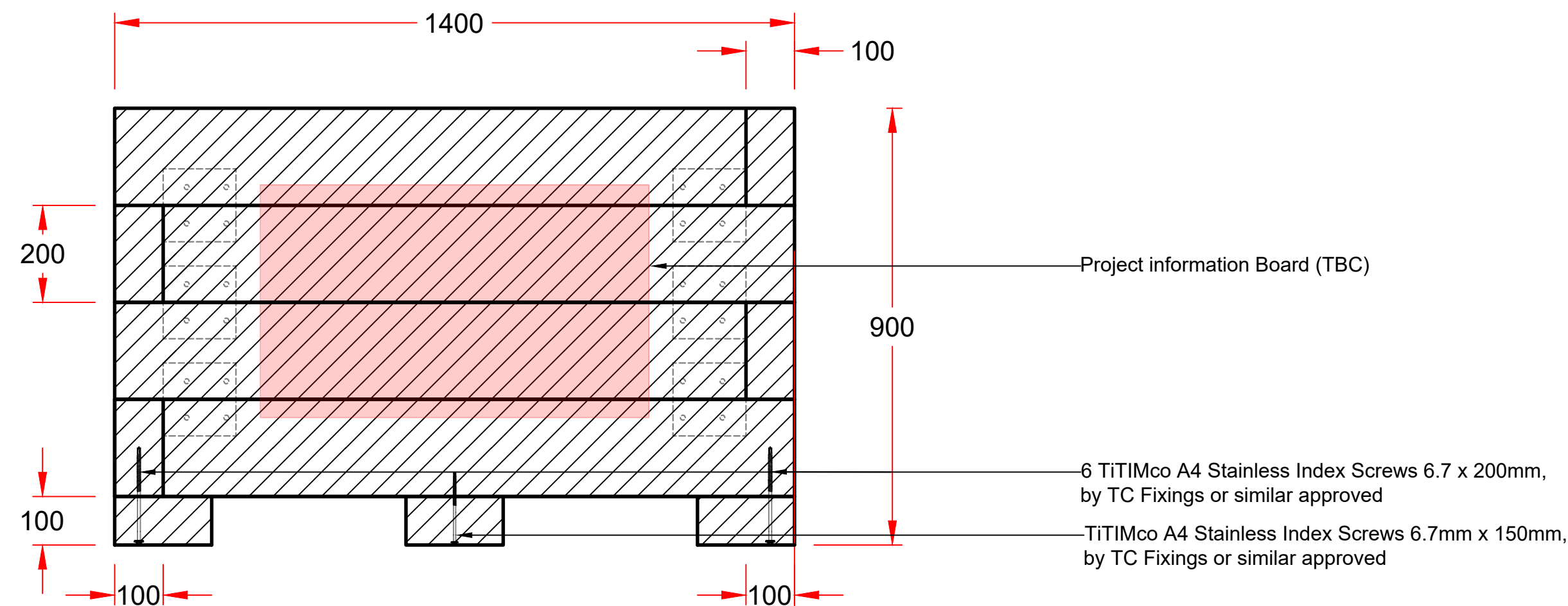

03 ELEVATION A-A'  
Planter  
1:10

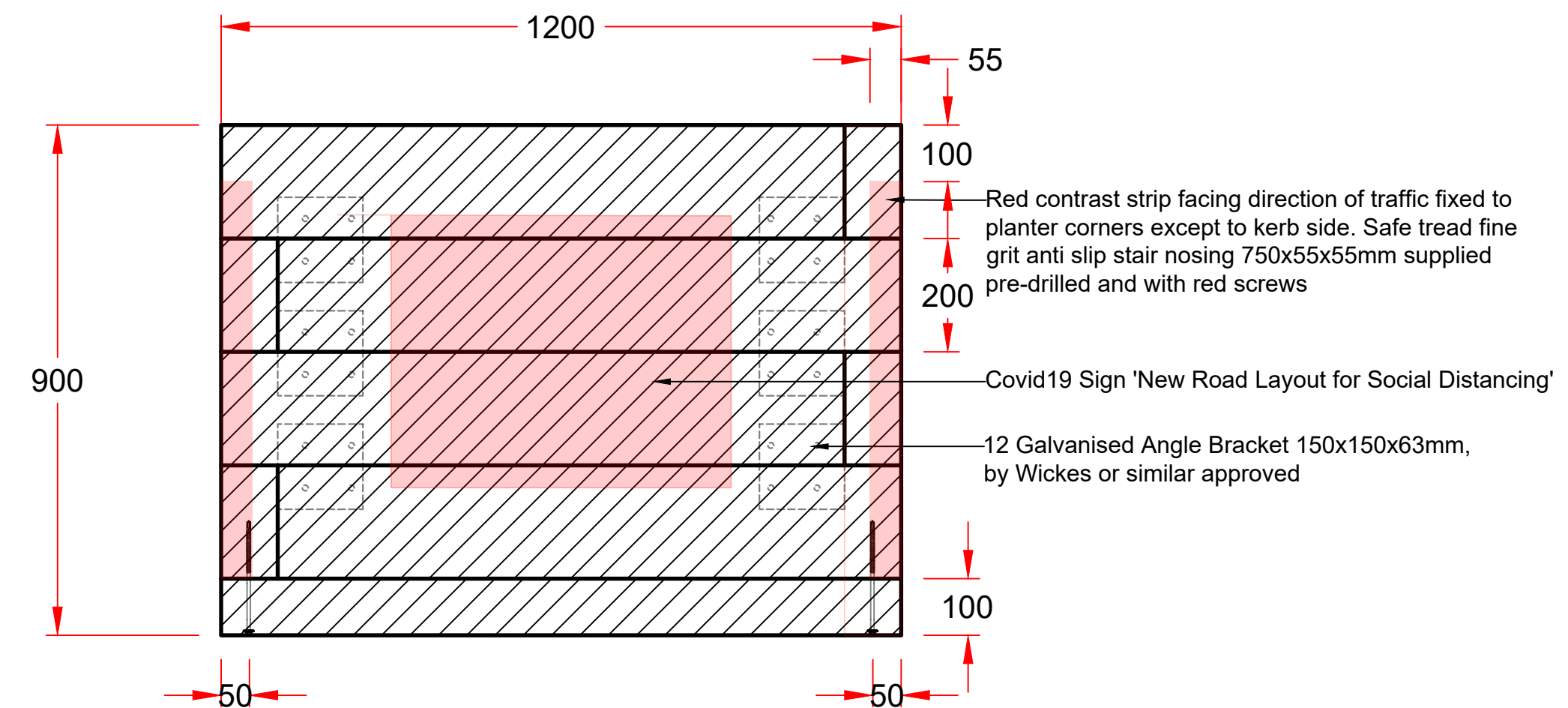

04 ELEVATION B-B'  
Planter  
1:10

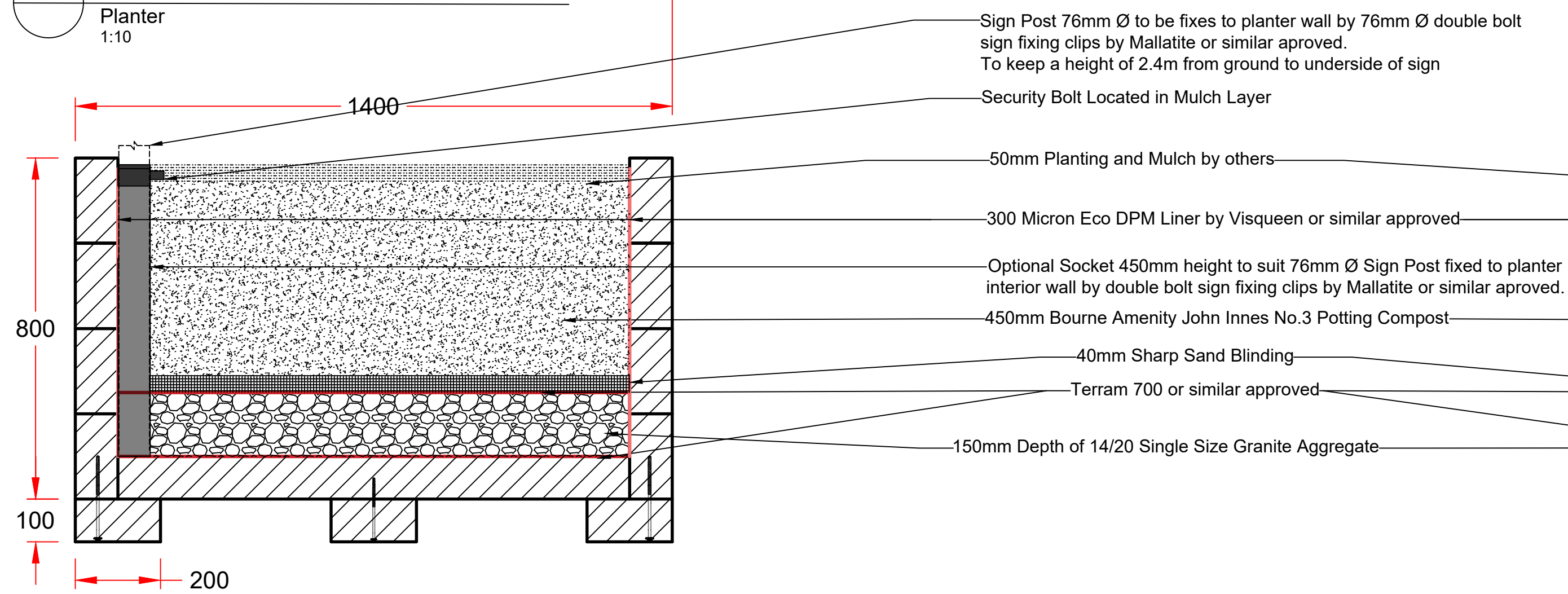

05 SECTION Aa-Aa'  
Planter  
1:10

- Sign Post 76mm Ø to be fixed to planter wall by 76mm Ø double bolt sign fixing clips by Mallatite or similar approved. To keep a height of 2.4m from ground to underside of sign
- Security Bolt Located in Mulch Layer
- 50mm Planting and Mulch by others
- 300 Micron Eco DPM Liner by Visqueen or similar approved
- Optional Socket 450mm height to suit 76mm Ø Sign Post fixed to planter interior wall by double bolt sign fixing clips by Mallatite or similar approved.
- 450mm Bourne Amenity John Innes No.3 Potting Compost
- 40mm Sharp Sand Blinding
- Terram 700 or similar approved
- 150mm Depth of 14/20 Single Size Granite Aggregate

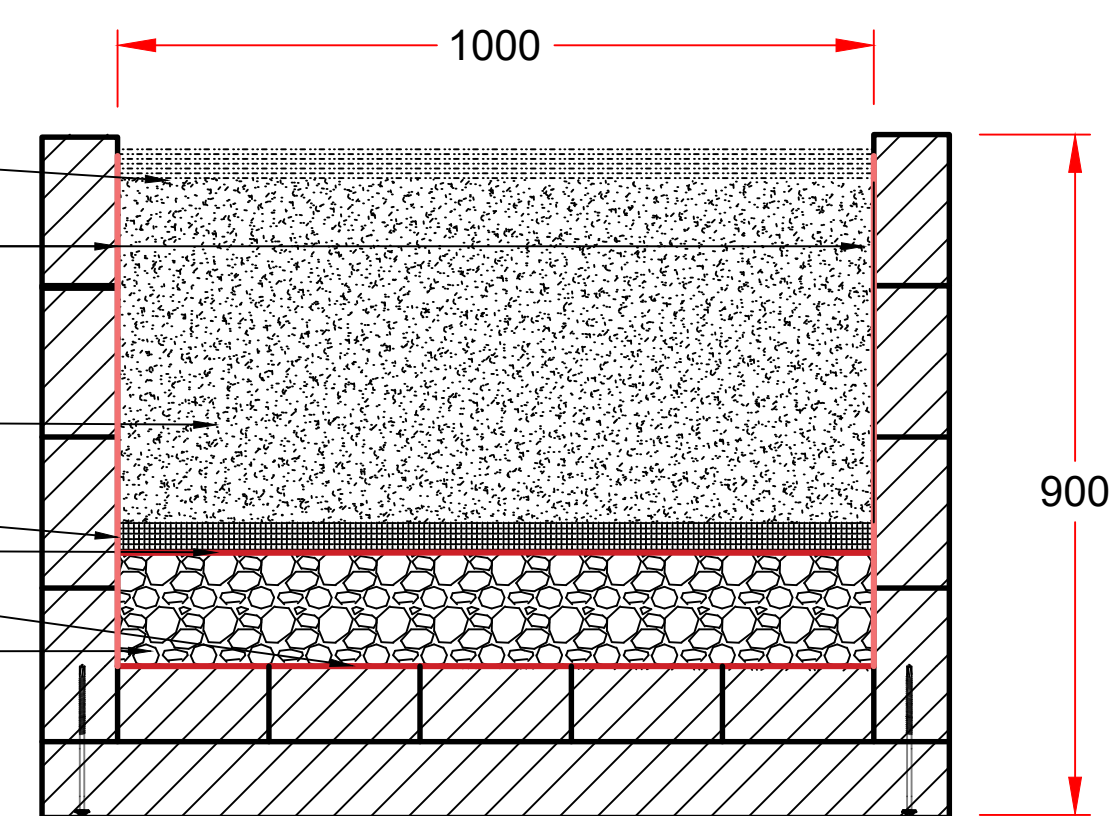

06 SECTION Bb-Bb'  
Planter  
1:10

C	26/06/20	UPDATES ON DRAWING	GG	KT
B	23/06/20	UPDATES ON DRAWING	SS	KT
A	04/06/20	UPDATES ON DRAWING	GG	KT
REV	DATE	DESCRIPTION	BY	CHKD



CLIENT LONDON BOROUGH OF NEWHAM

HIGHWAYS & TRAFFIC

PROJECT Low Traffic Neighbourhoods

SUBJECT Typical Planter Details

CONTRACT No. XXXXX

SCALE 1:10 @A1

DRAWING No. XXXXX / XXXX / XX

PROJECT STAGE Preliminary

DATE ISSUED May 2020

REVISION C

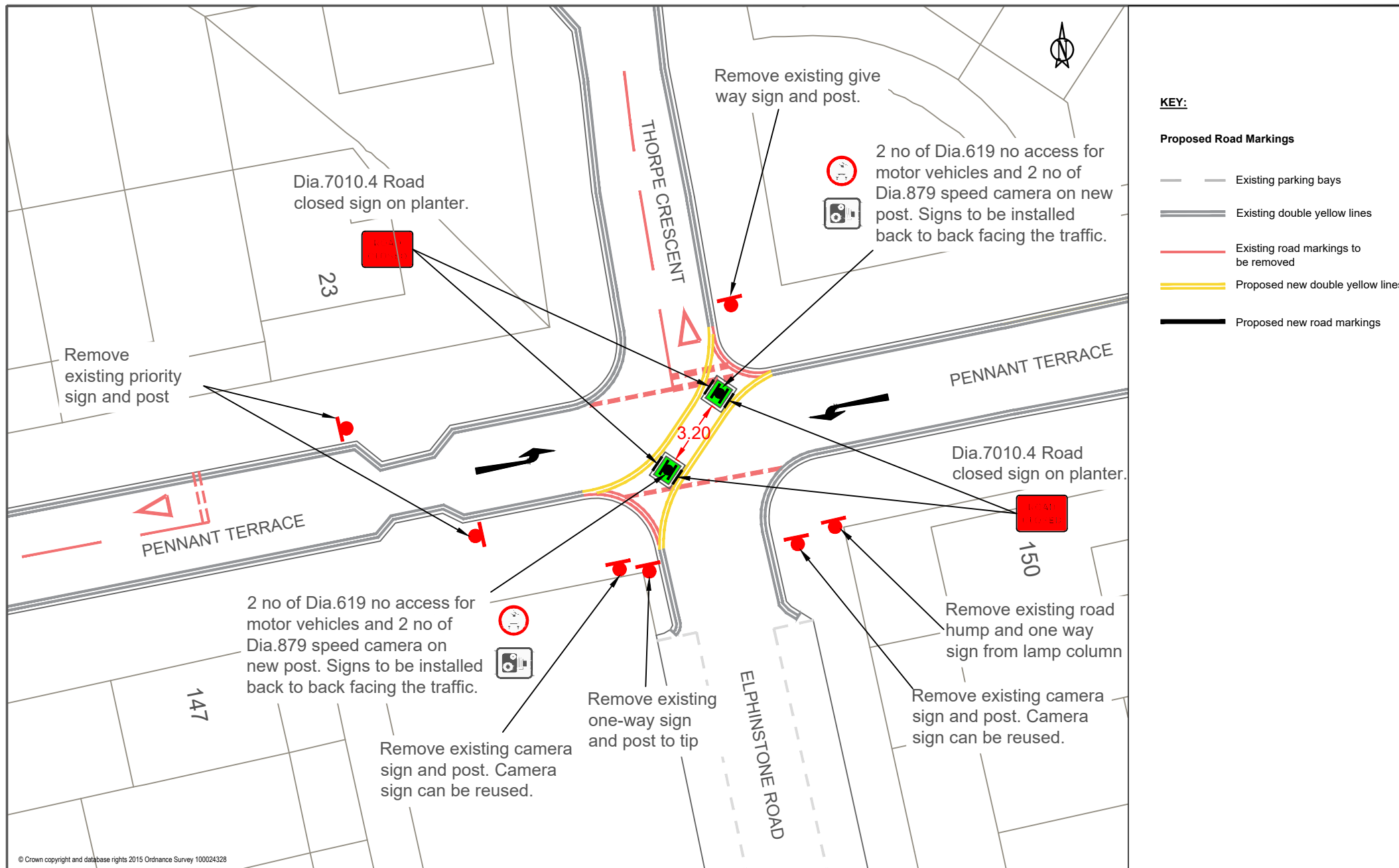

Drawn By	FS
Drawing No.	WA-MF-23-11
Date	03/08/23
Scale	1:250 @ A4

**Winns Area Modal Filter**  
Elphinstone Road and Thorpe Cres

Notes





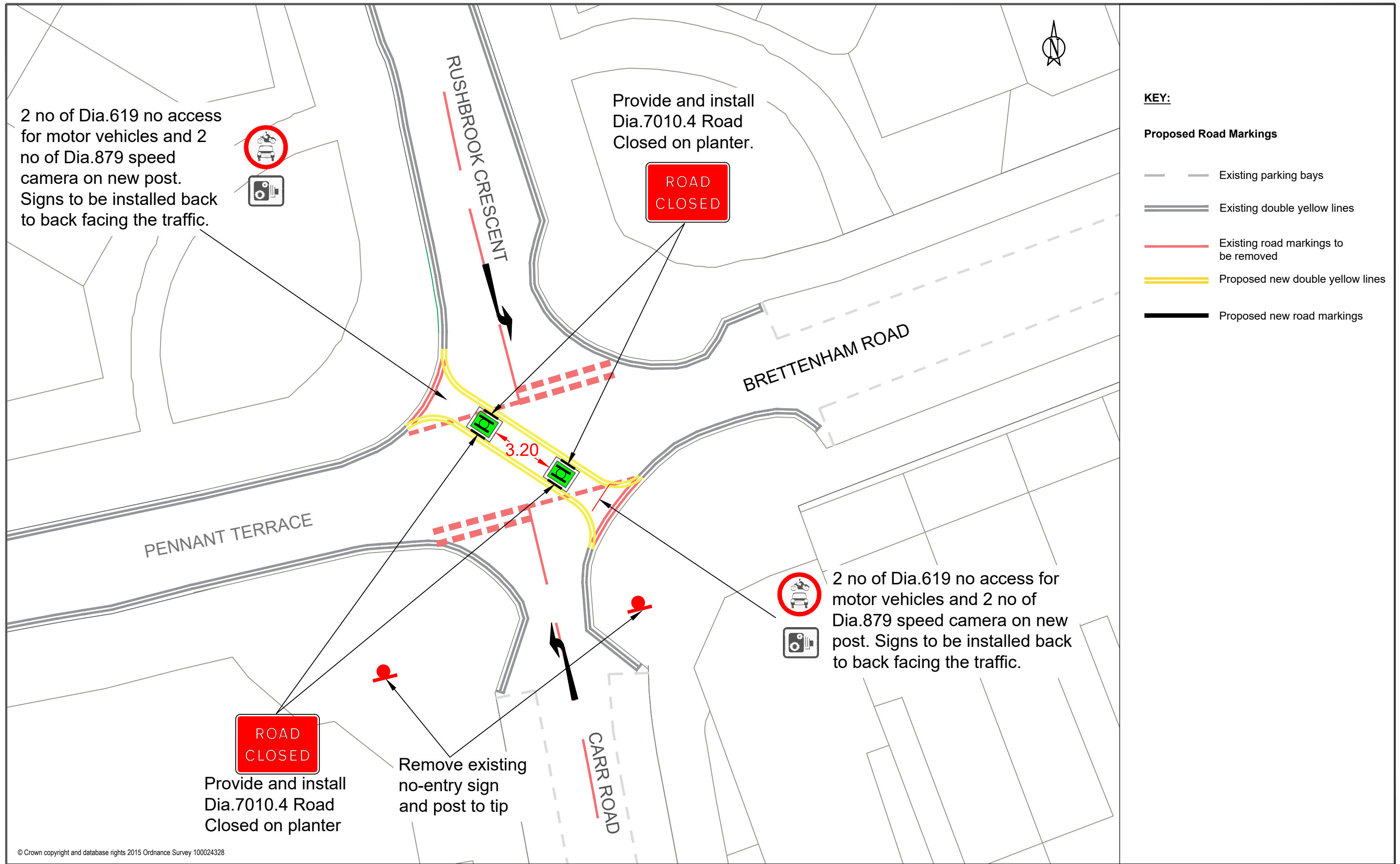

Drawn By	FS	Title <b>Winns Area Modal Filter</b> Rushbrook Crescent and Carr Road	Notes	
Drawing No.	WA-MF-23-13			
Date	08/04/23			
Scale	1:250 @ A4			

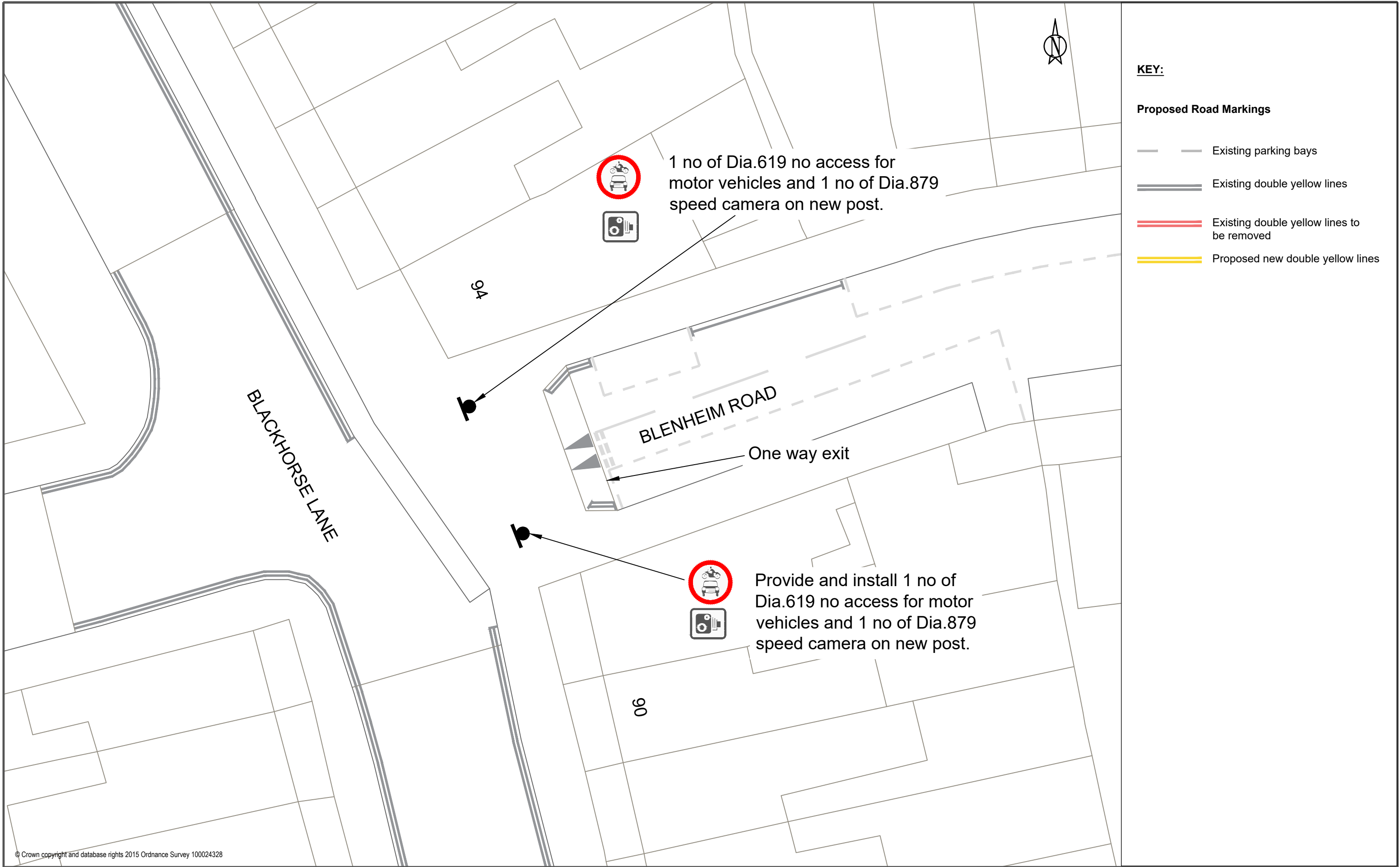

Drawn By	FS	<div>Title</div> <div>Winns Area Modal Filter</div> <div>Blenheim Road</div>	<div>Notes</div>	
Drawing No.	WA-MF-23-15			
Date	07/08/23			
Scale	1:250 @ A4			



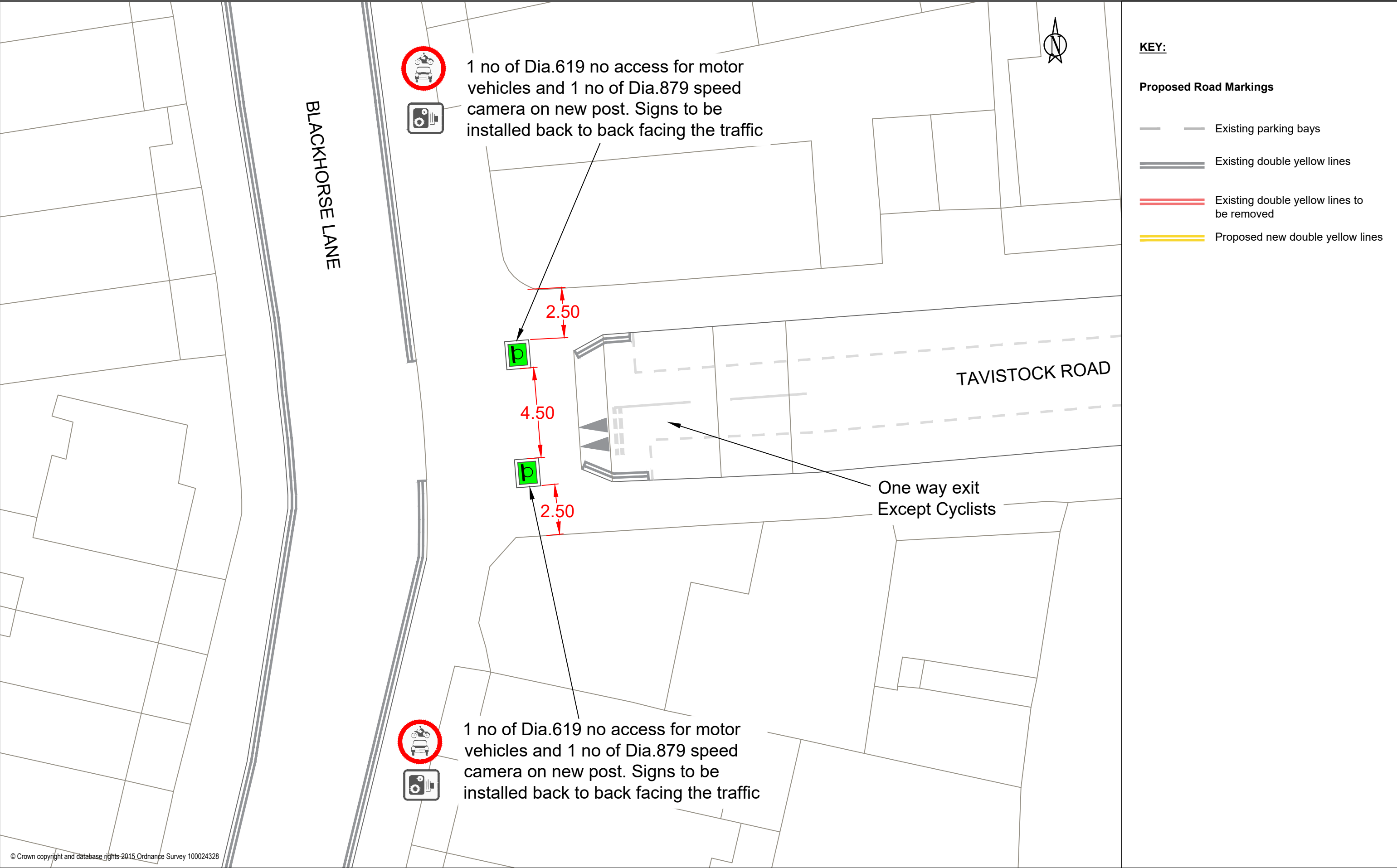

© Crown copyright and database rights 2015 Ordnance Survey 100024328

Drawn By	FS
Drawing No.	WA-MF-23-16
Date	07/08/23
Scale	1:250 @ A4

Title
Winns Area Modal Filter Tavistock Road

Notes



